

**ABOVE GROUND AUTOMATIC COVER**

# ROLLEASY 2

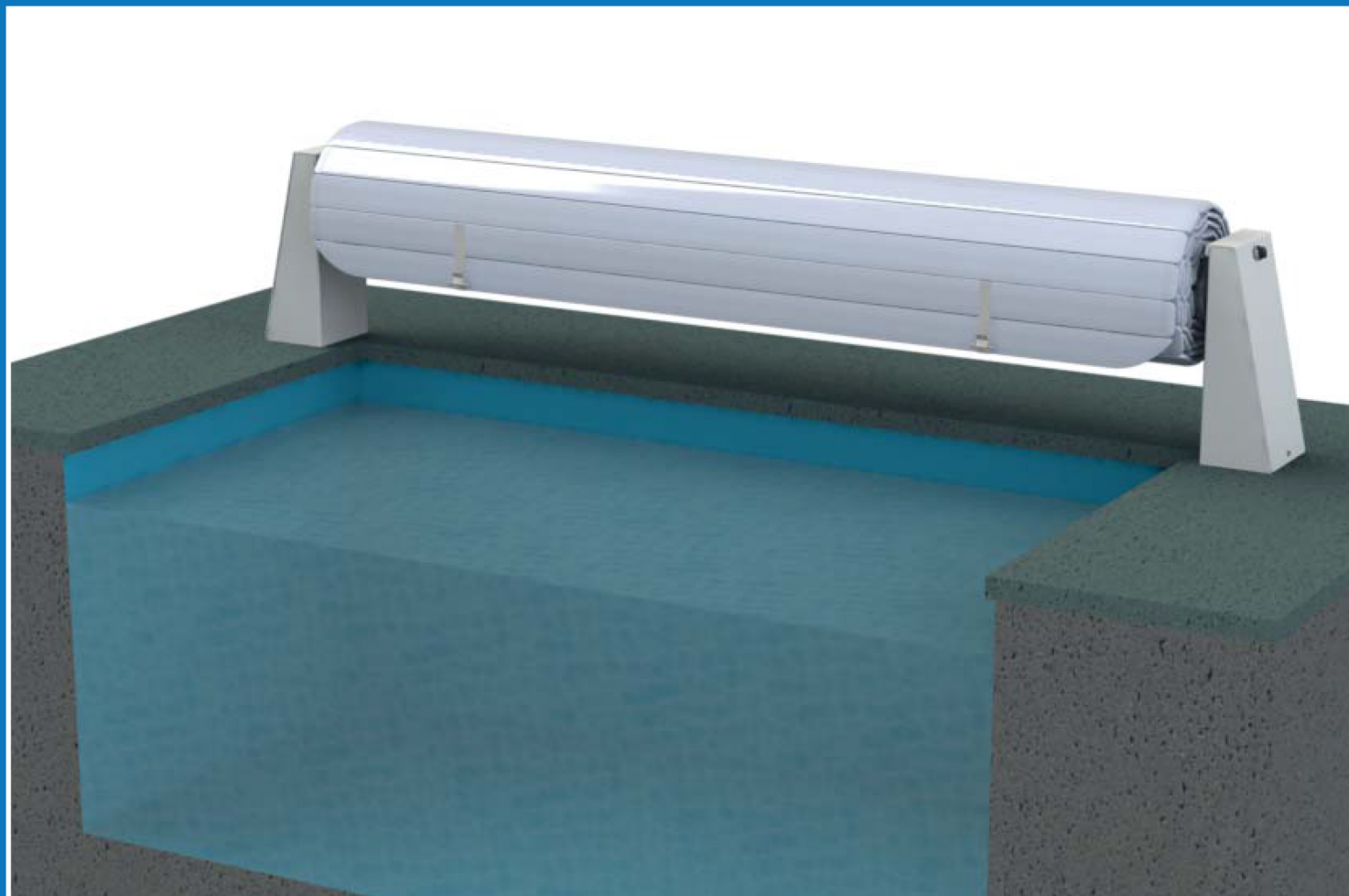

## TECHNICAL MANUAL

Installation / Use / Servicing / Maintenance / Safety advice

**IMPORTANT:** Please remember that the measures imposed by the French 3rd January 2003 Act and subsequent legislation on **POOL SAFETY** are mandatory. Failure to comply with certain measures is a criminal offence.

**CLASS** would like to remind you that the intervention of a professional is required when installing in order to have the guarantee that the installation strictly complies with legislation and regulations.

Failure to comply with installation conditions makes it impossible to be compliant with the standard.

Customers who install the cover themselves lose the benefit of the contractual guarantee and risk the non conformity of their pool and therefore possible exposure to criminal sanctions.

**THIS MANUAL MUST BE GIVEN TO THE USER AFTER INSTALLATION  
PLEASE READ CAREFULLY AND KEEP IN A SAFE PLACE.**

## PARTS INCLUDED IN THE DELIVERY

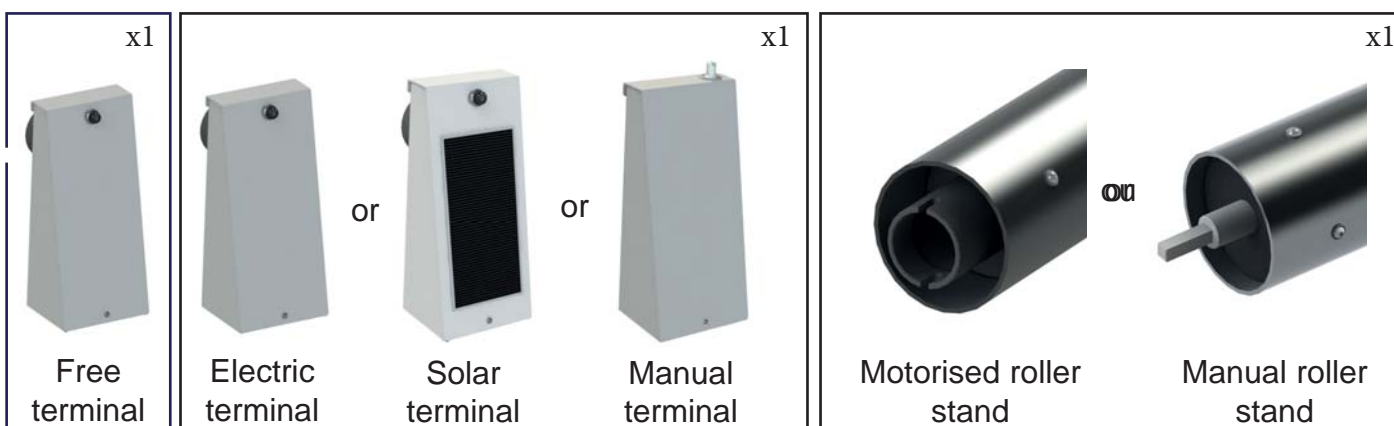

### Electric or solar version assembly pack

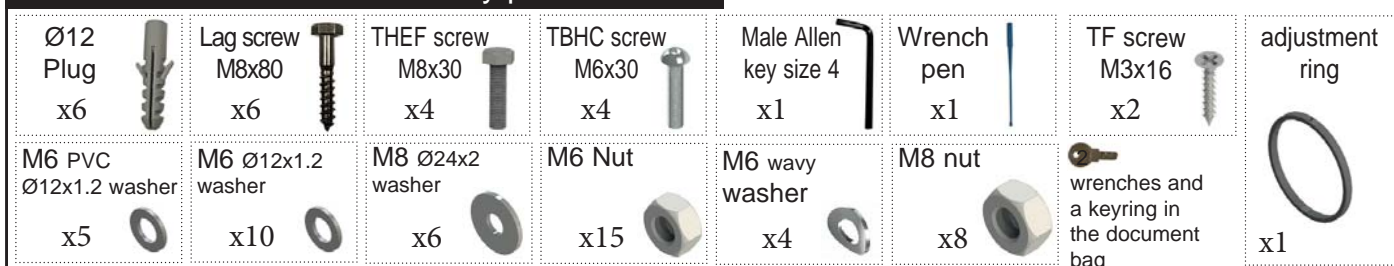

### Manual version assembly pack

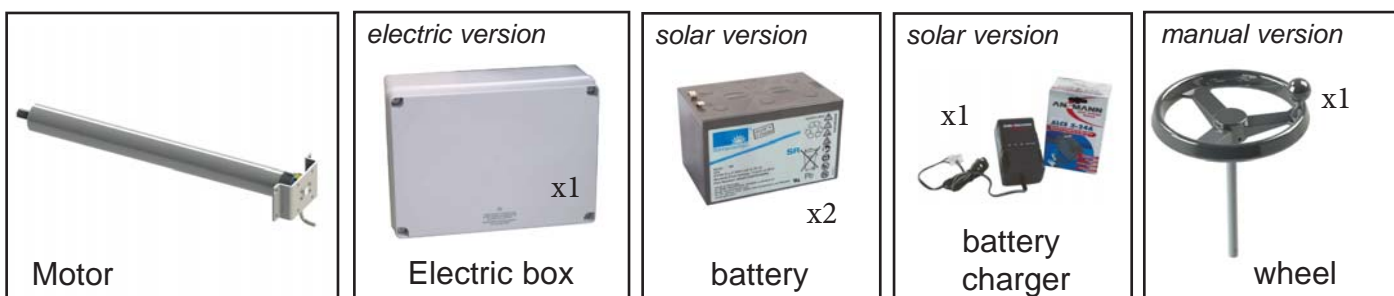

### Slats (variable number of packs)



### Locking kits (1 pack)



#### Push-lock

3 fastener models:  
surface mounted – insert  
mounted – hanging mounted

The equipment is shipped at the risk of the recipient. On receipt of the goods, if the recipient finds damage caused during transport, they should make immediate reserves on the transporter's delivery document. This should be confirmed by a registered letter with acknowledgement of receipt sent to the transporter within 48 hours.

**for a 4.5 x 10 m pool  
with Ø3 m step unit**

Terminals: 1 0.50 x 0.45 x 0.35 pack – 20kg  
Stand: 1 0.20 x 4.80 m pack – 25 kg  
Slats: 5 4.7 x 0.25 x 0.20 m packs – 250 kg  
**Total weight: 295 Kg**

## TOOLS REQUIRED FOR ASSEMBLY (INSTALLATION – 2 PERSONS)



## INFORMATION / SIZE / HEIGHT

### Electric and solar versions

The motor is located in the stand and can be accessed from inside the housing fitted with a key operated switch.

The power supply comes from an electric box located in the technical room, or from 2 batteries placed in the terminal on the motor side for the solar version.

The automatic stops are adjusted directly on the motor.

### Manual version

Rolling and unrolling operations are carried out using the removable wheel.

The cover is composed of watertight PVC articulated slats that float on the surface of the water.

## IN ORDER FOR THE COVER TO BE COMPLIANT WITH STANDARD NF P 90-308

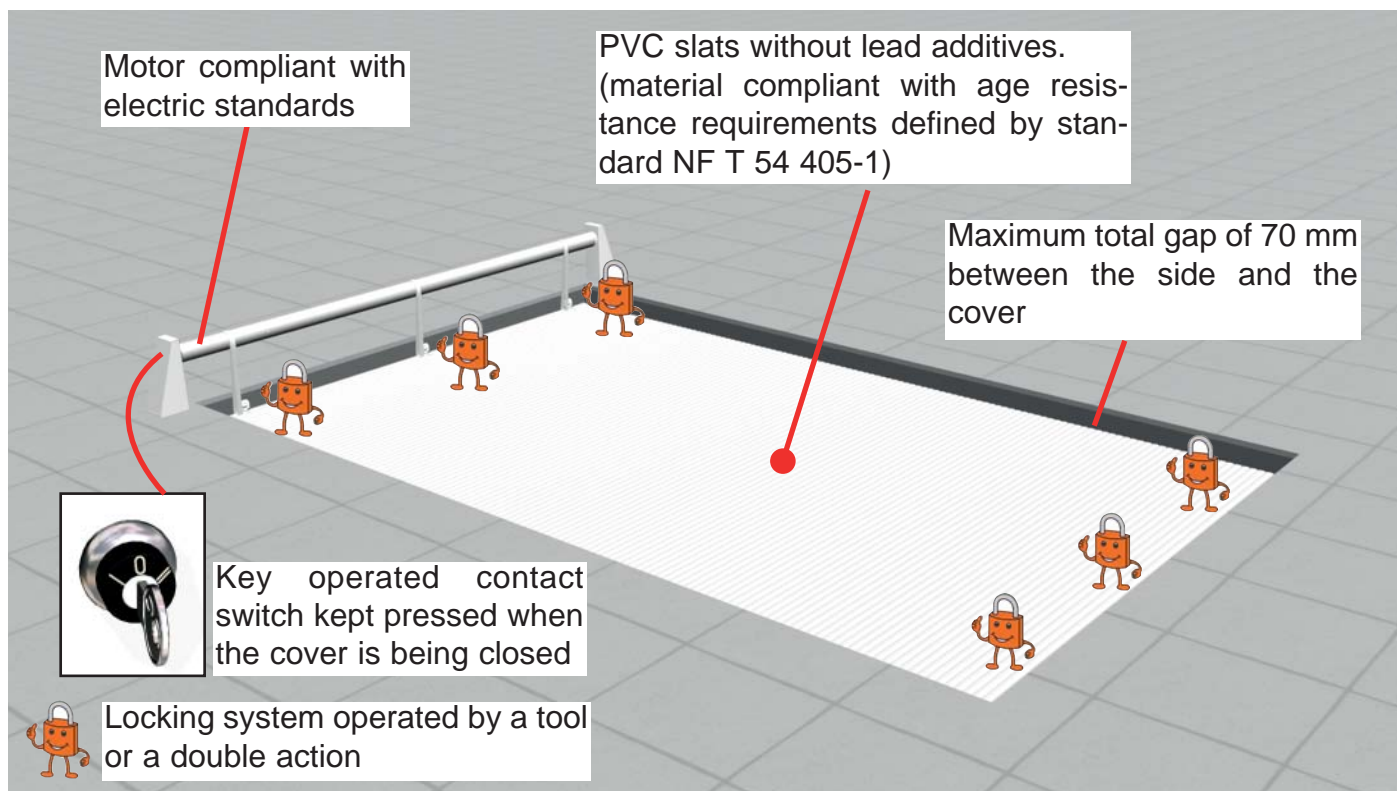

**Currently covers with overflows and covers with removable steps on the side are not compliant with standard NF P 90-308.**

**Unless otherwise specified by the manufacturer, immersion alarms are not compatible with roll-Easy 2 covers.**

## ASSEMBLING AND FIXING THE ROLLER

### assembling the terminals

Remove the terminal door.

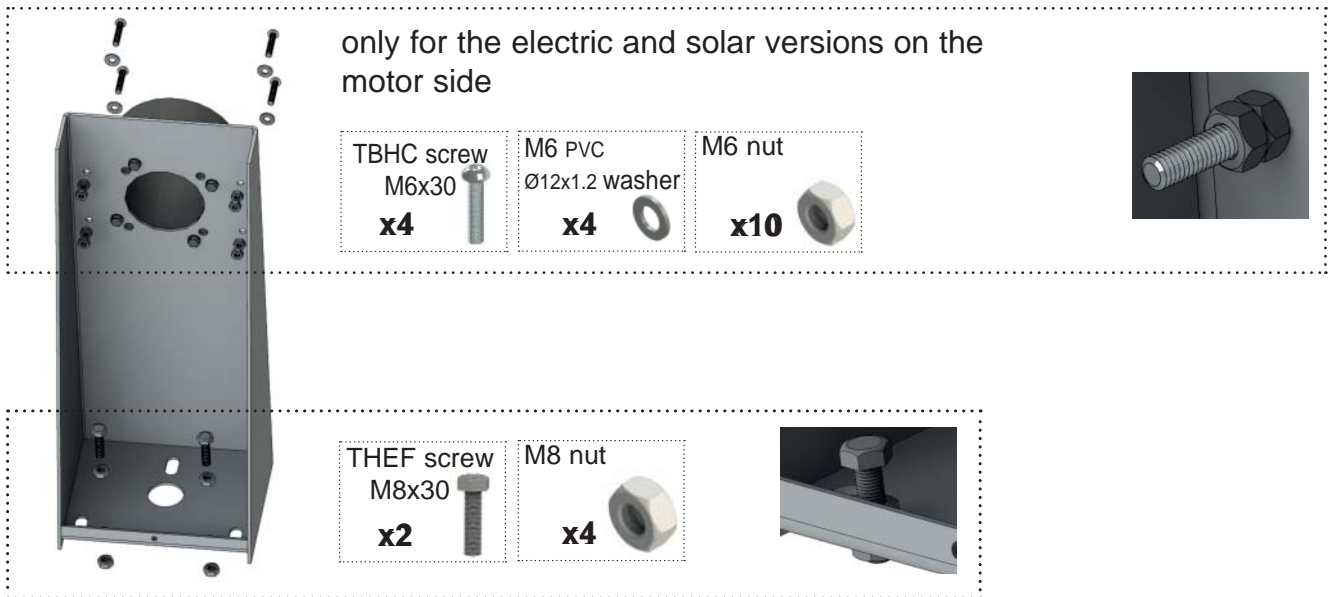

### Assembling and placing the roller on the pool

Solar and electric version

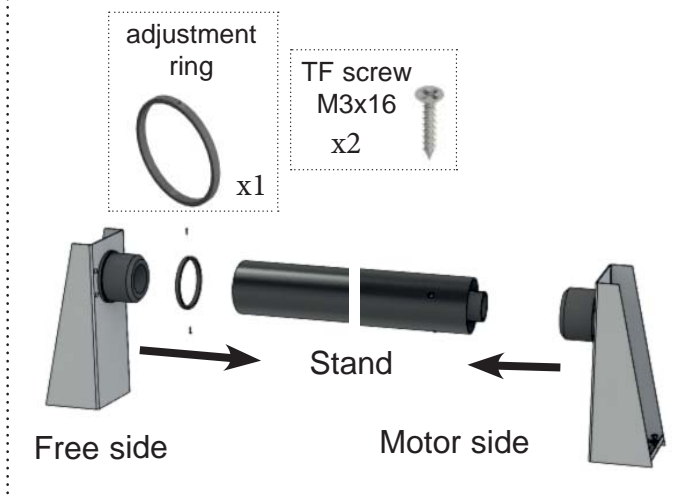

Manual version

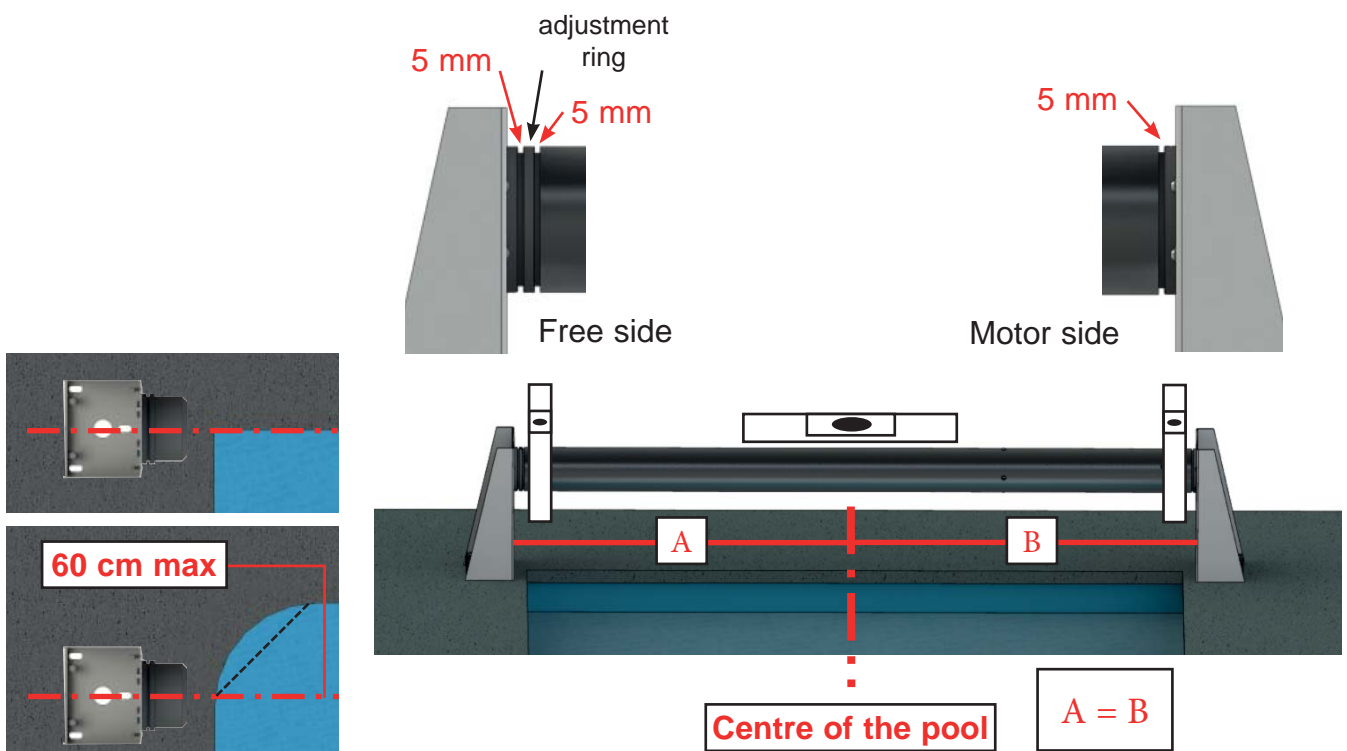
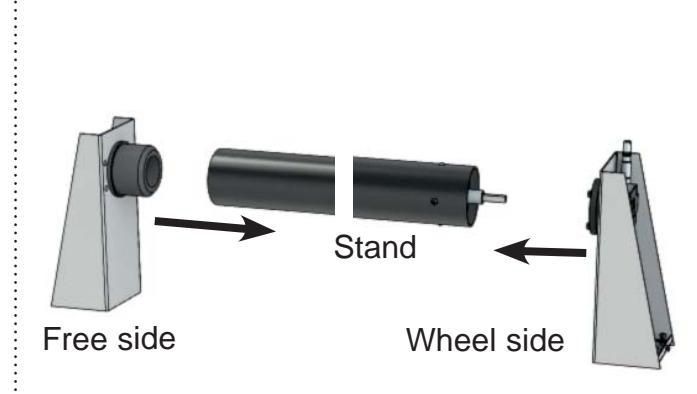



## Fixture of the roller to the ground



## Installing the motor (electric and solar version)

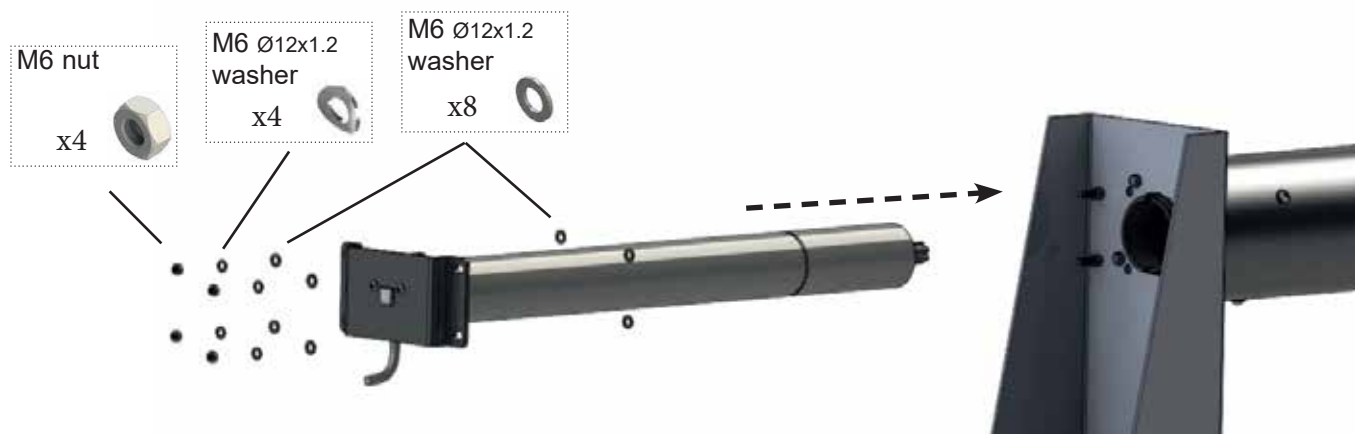

align the key with the notch

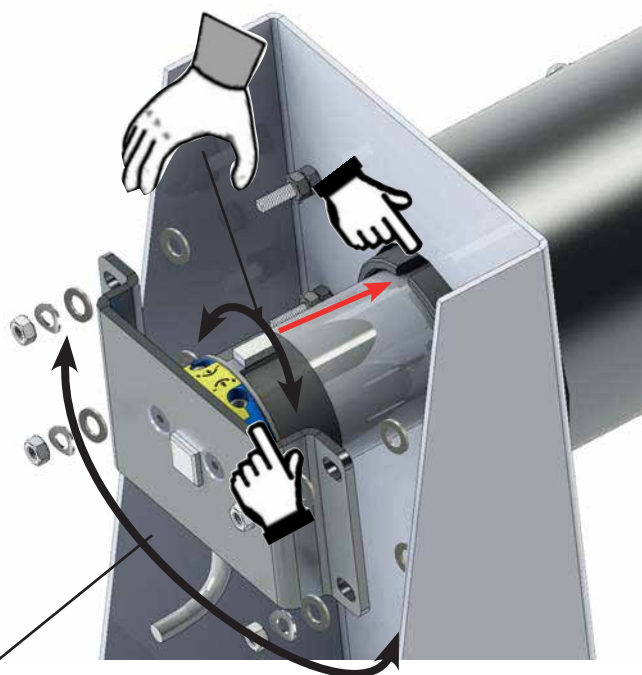

Make small rotating movement with the motor to facilitate the insertion

Electric/solar version  
(up to 5 m wide)

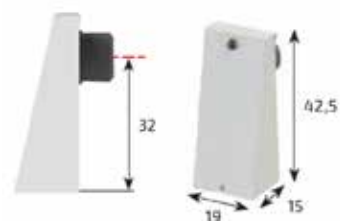

Electric version  
(more than 5 m wide)

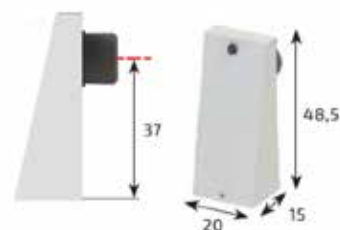

Manual version



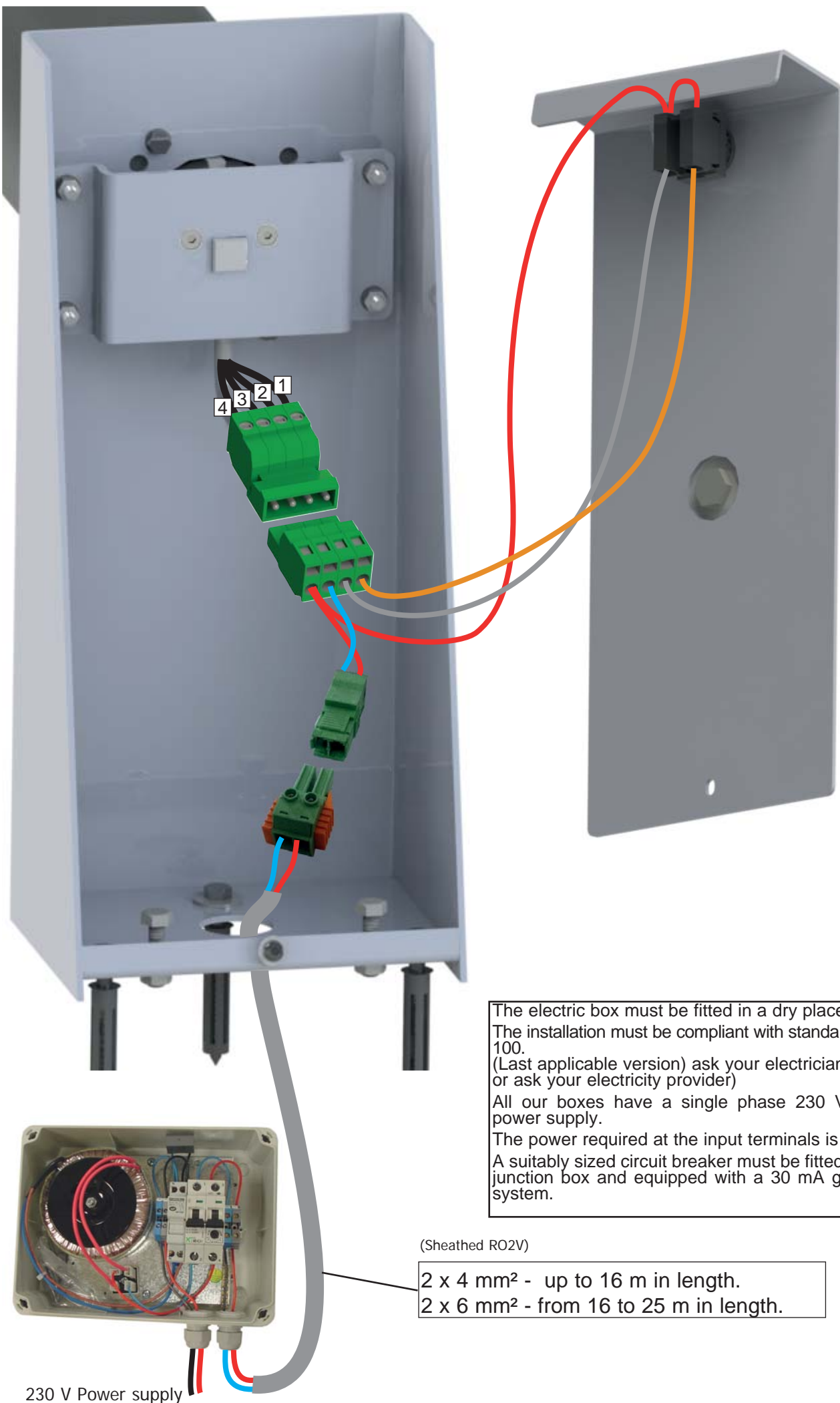

The electric box must be fitted in a dry place.  
 The installation must be compliant with standard C15-100.  
 (Last applicable version) ask your electrician for advice or ask your electricity provider)  
 All our boxes have a single phase 230 Volt (50Hz) power supply.  
 The power required at the input terminals is 0.15 Kw.  
 A suitably sized circuit breaker must be fitted before the junction box and equipped with a 30 mA ground fault system.

(Sheathed R02V)

2 x 4 mm<sup>2</sup> - up to 16 m in length.  
 2 x 6 mm<sup>2</sup> - from 16 to 25 m in length.

230 V Power supply

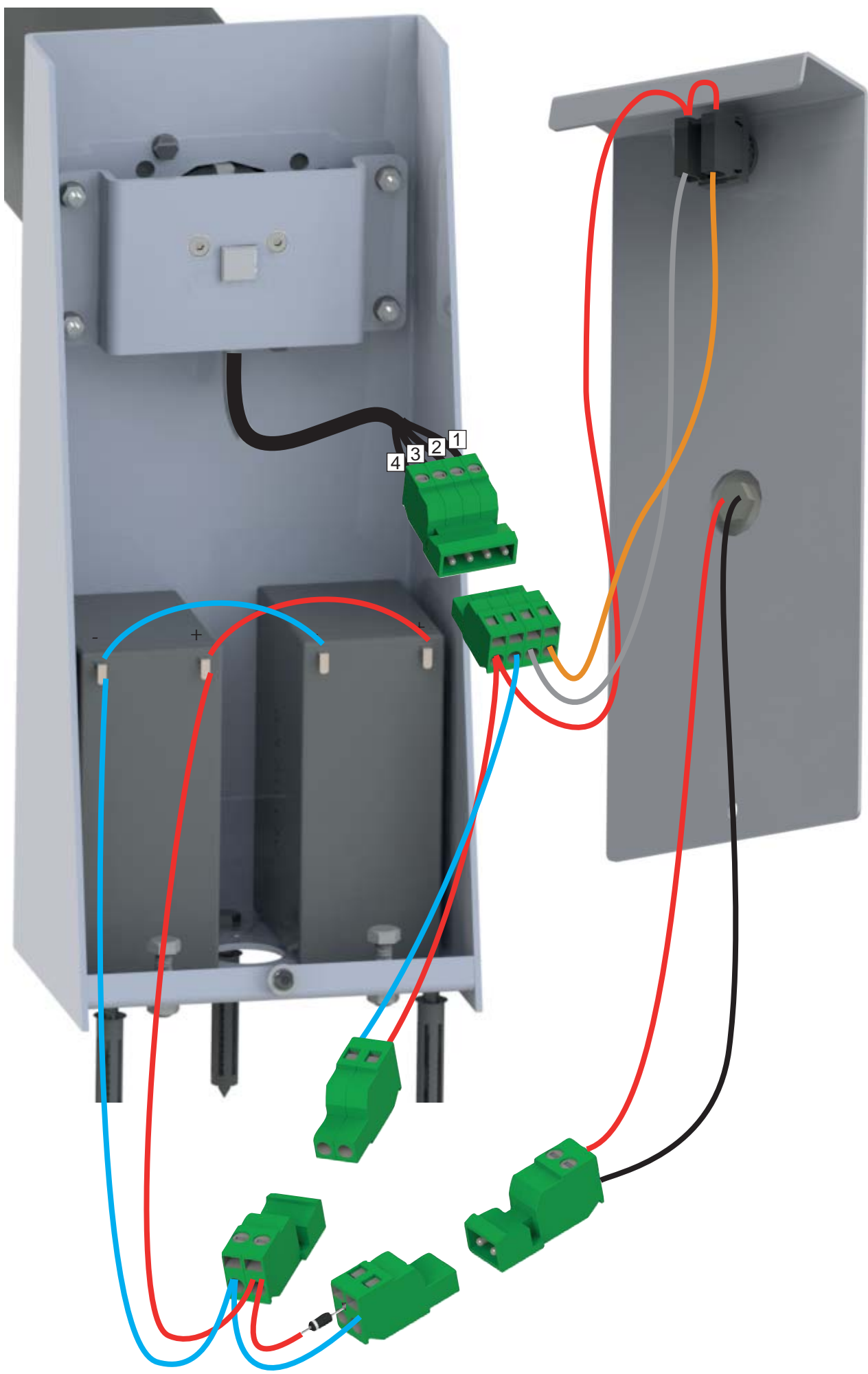

## COVER INSTALLATION

Make sure the slats are in the right direction

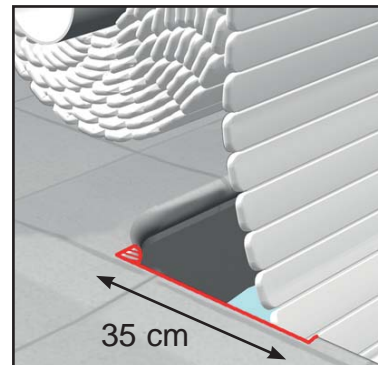
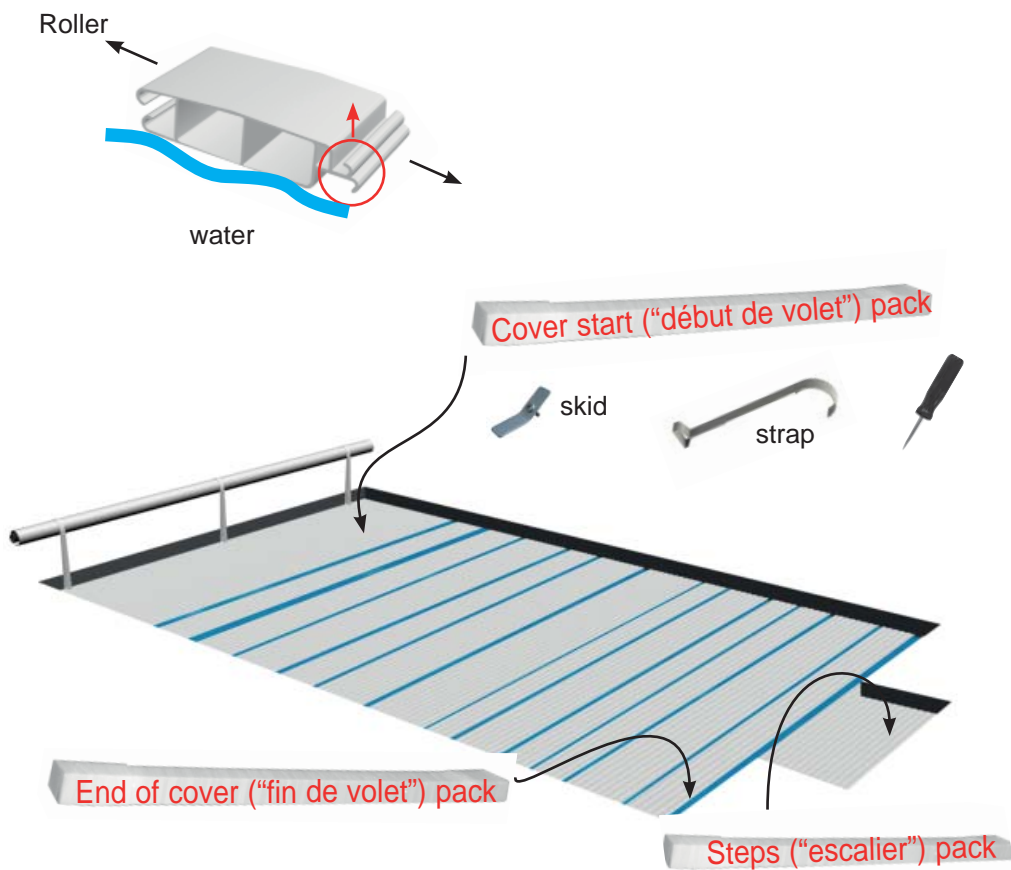

*If necessary, cut the sides to ease the passage of the cover and avoid rubbing*

## Slat assembly

By clipping

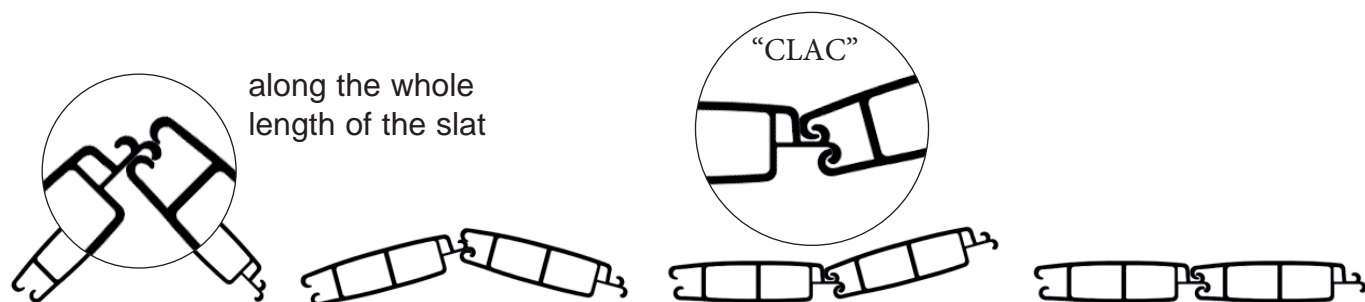

Repeat the movement until all the slats are completely clipped together

By sliding

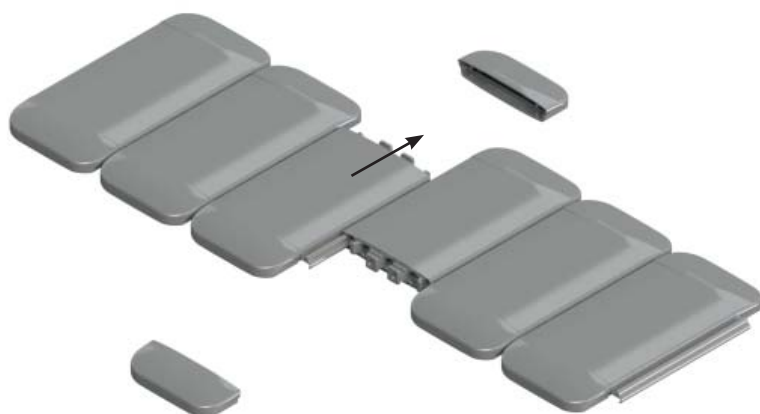

remove the cap

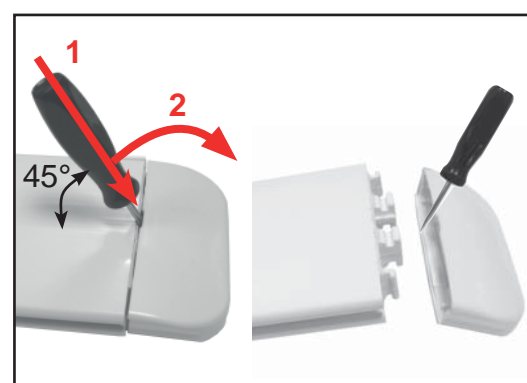



## Assembly of the strap between the cover and the tube

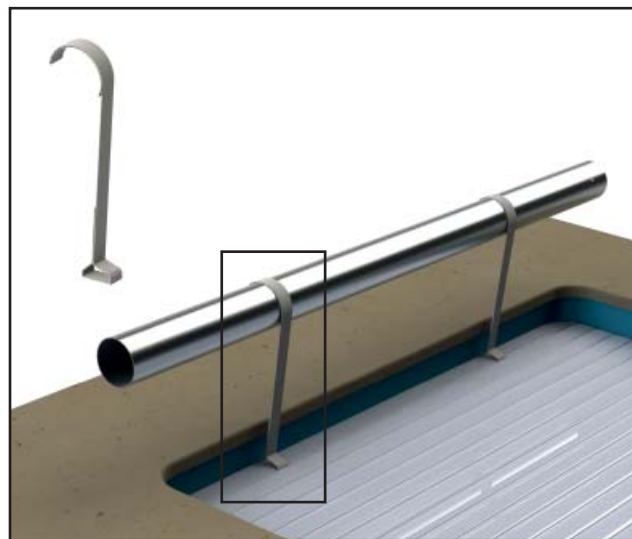

The surface to be glued must be clean and dry

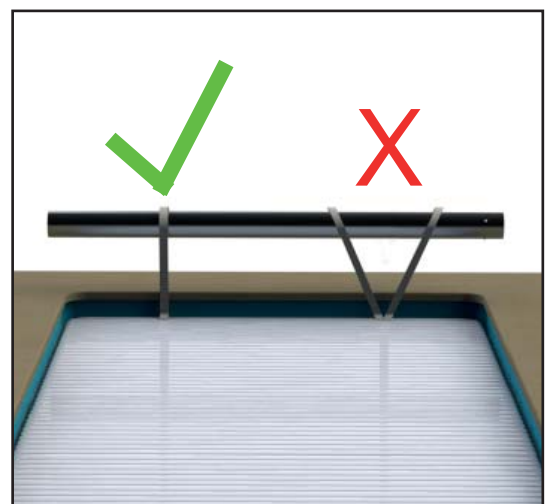
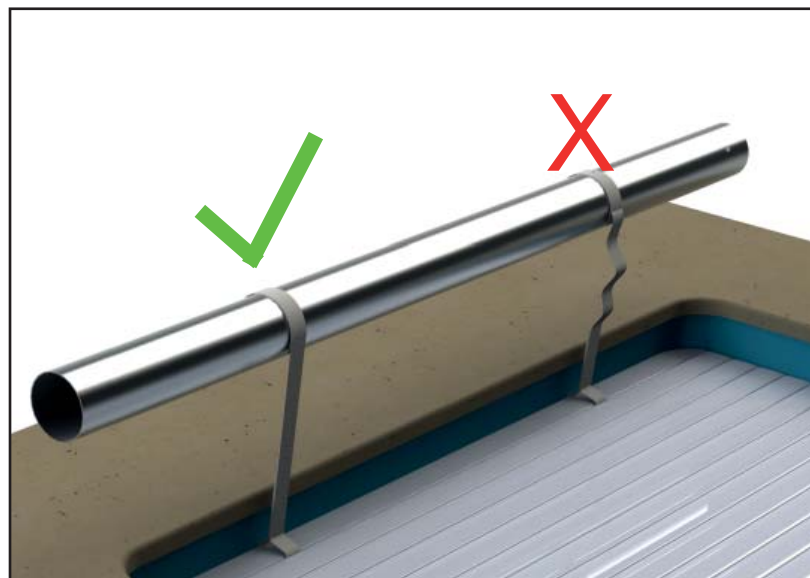

In order to guarantee quality fixing, the adhesive Velcro temperature must be higher than 15°C (if necessary leave it in a warm room before application).

## skid assembly



The skids are used to orient the cover at the start of closure.  
The holes are drilled at the factory.

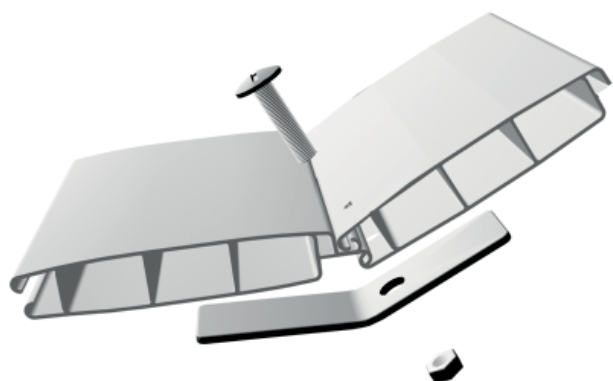
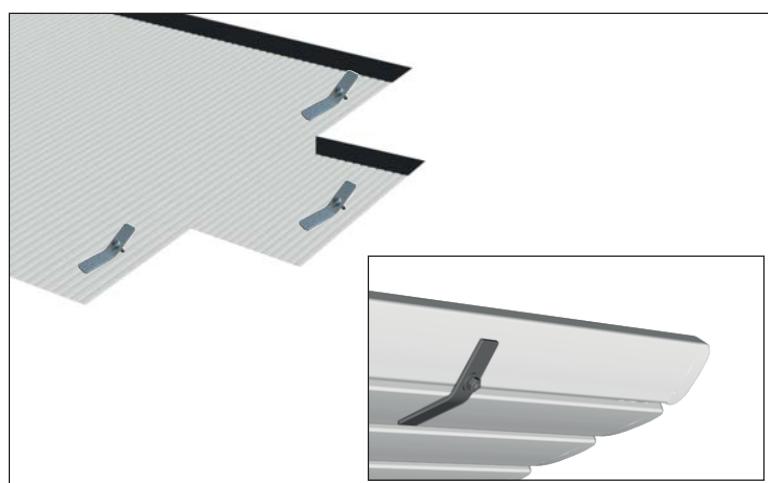

## AUTOMATIC STOP ADJUSTMENT

### Command logic verification

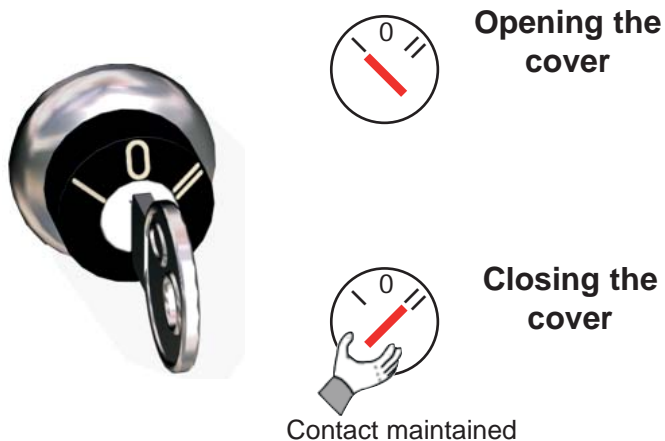

If the command logic is incorrect, reverse cables 1 and 2 on the motor output.  
(see wiring diagram)

### Adjustment

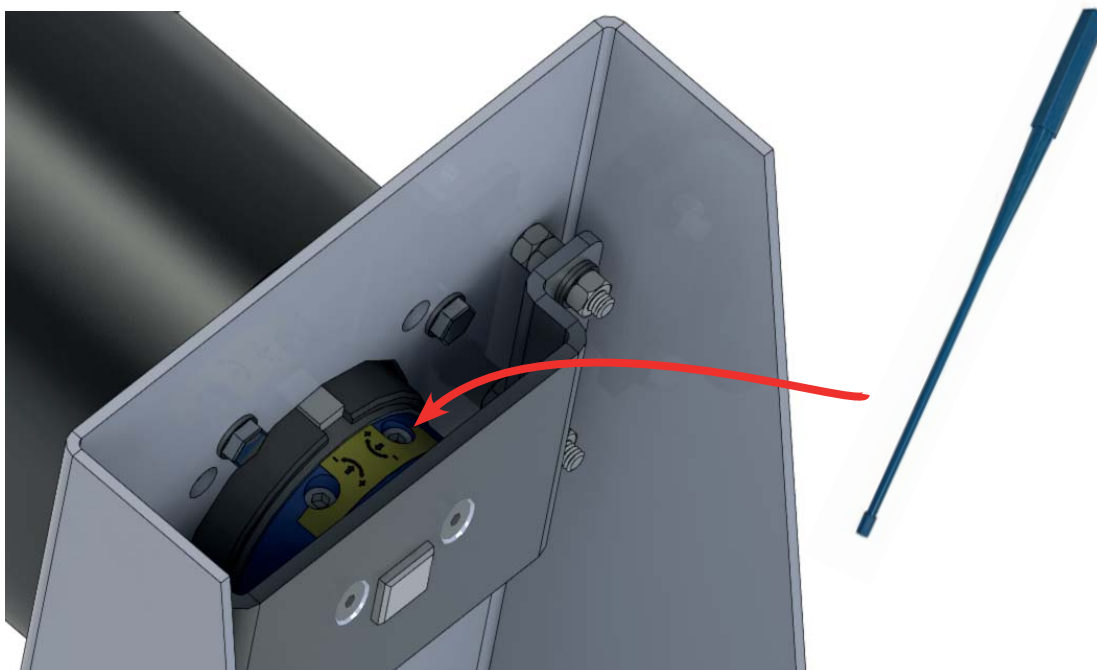

The arrows indicate the cover's direction of movement

Turning in the + direction increases the extension of the cover

Turning in the - direction decreases the extension of the cover

The positions of the locking kits on the pool are shown on the plans delivered with the slats.

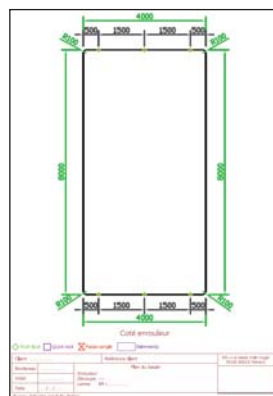

Any changes to the positions of the locking kits must follow the rules explained below. Please contact us for any other cases.

## 12 Positioning rules

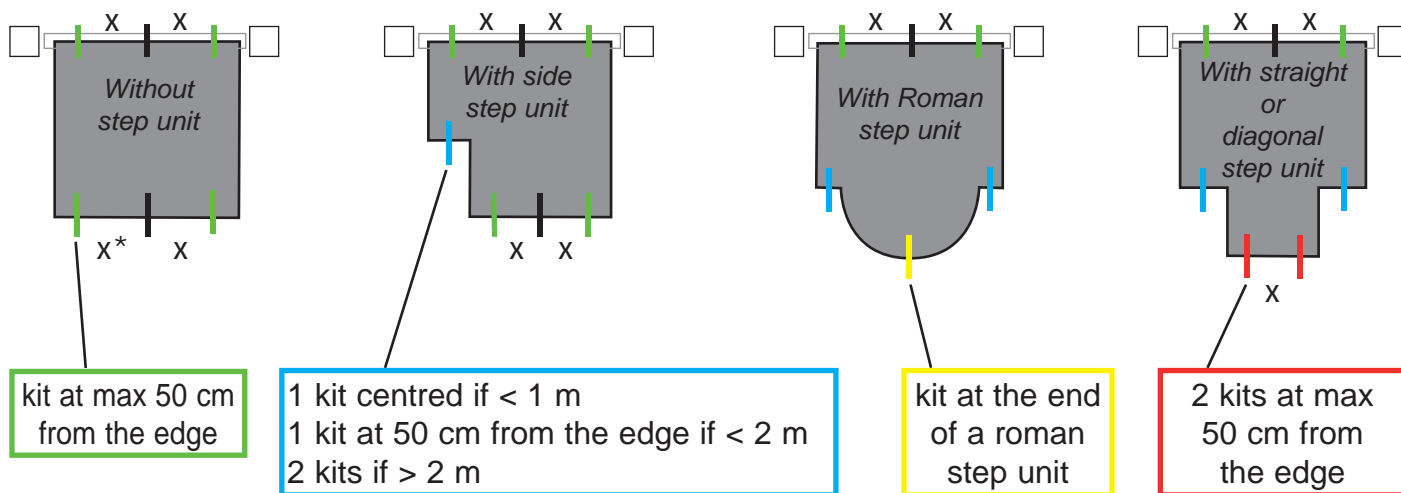

\* X must never exceed 2 m

## A water level regulator is mandatory

### Insert mounted model

For concrete and panel pools

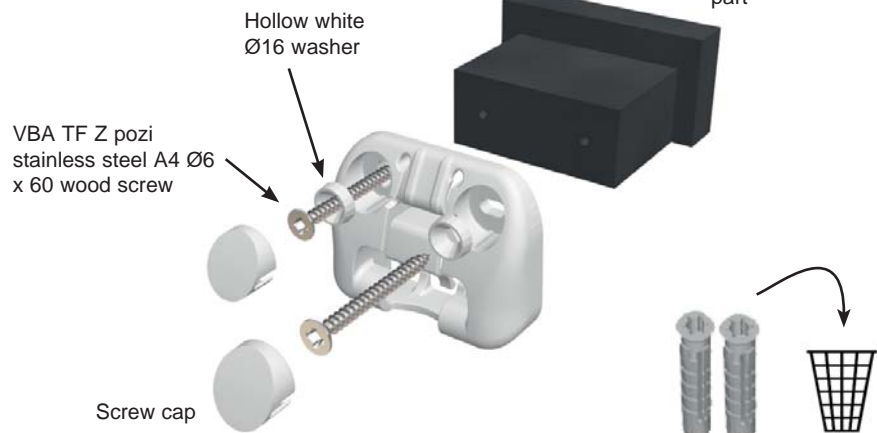
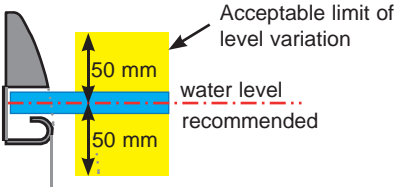
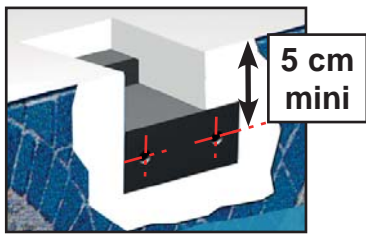

### Hang mounted version

For concrete and panel pools

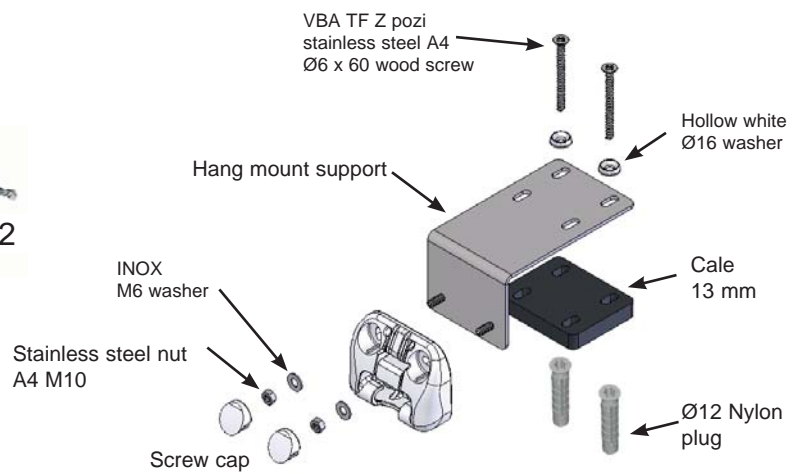
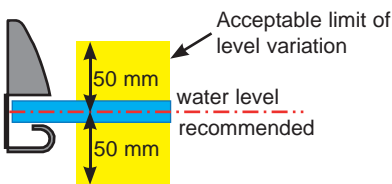
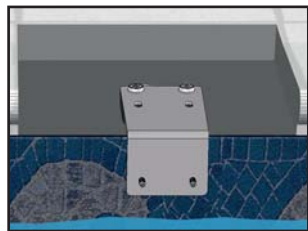

### Surface mounted model

For concrete and concrete block pools, as well as pools with wall thickness greater than or equal to 8 mm

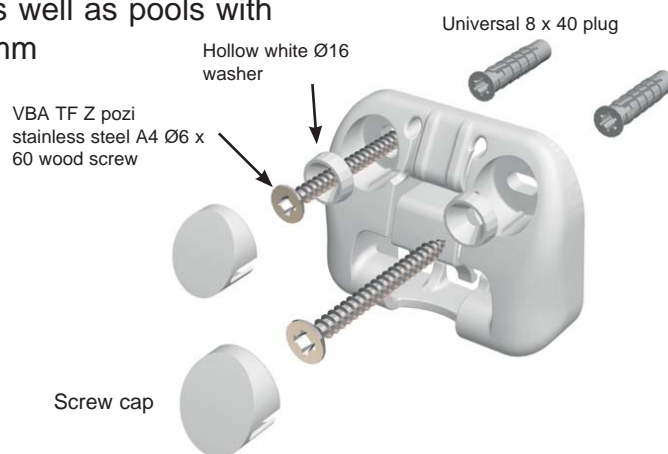
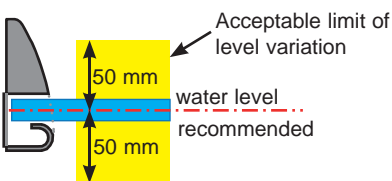
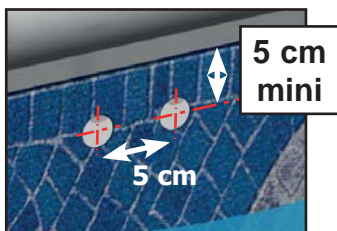

#### Concrete

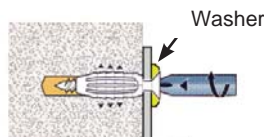

Once the resistance point has been reached stop screwing, this would deteriorate the fixture quality.

#### Concrete block

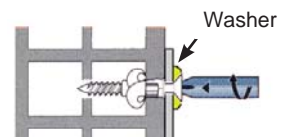

After reaching the resistance point, make 3 more turns of the screwdriver to finish tightening.



## OPENING/ CLOSURE OF THE POOL

- The person carrying out the operation must first make sure there is nobody in the pool.
- It is imperative not to halt the cover in an intermediate position, this can cause the risk of jamming a bather's body under the cover if there is a bather in the pool.
- When using an automatic cleaner under the cover, check that the hose does not affect the movement of the slats when opening and closing the cover.
- It is essential to remove floating objects when opening and closing the cover.
- Do not block the cover while extending or retracting.
- Do not activate the automatic cover when it is iced in.
- The cover can be opened and closed by a single person. (2 minutes)

### Opening:

- Unlock all the locking kits.
- Turn the key operated switch (position I).
- Stow the key away from the reach of children.

**Always release the cover before starting the motor.**

### Closure:

- Turn the key operated switch (position II) "contact maintained during closure"
- Lock all the locking systems.
- Keep the key out of the reach of children.

**ALWAYS KEEP AN EYE ON THE POOL WHEN OPENING OR CLOSING THE COVER.**

**ALWAYS CHECK THAT THE POOL WATER LEVEL IS CONSTANT AND COMPLIANT WITH THE RECOMMENDATIONS IN THE INSTRUCTIONS**

## LOCKING AND RELEASING PUSH-LOCK

### locking

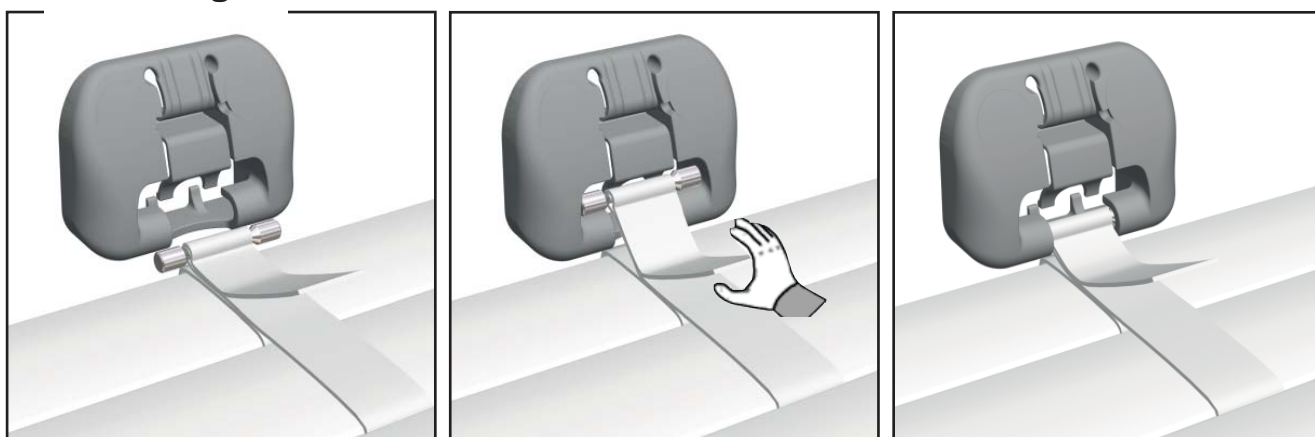

### releasing

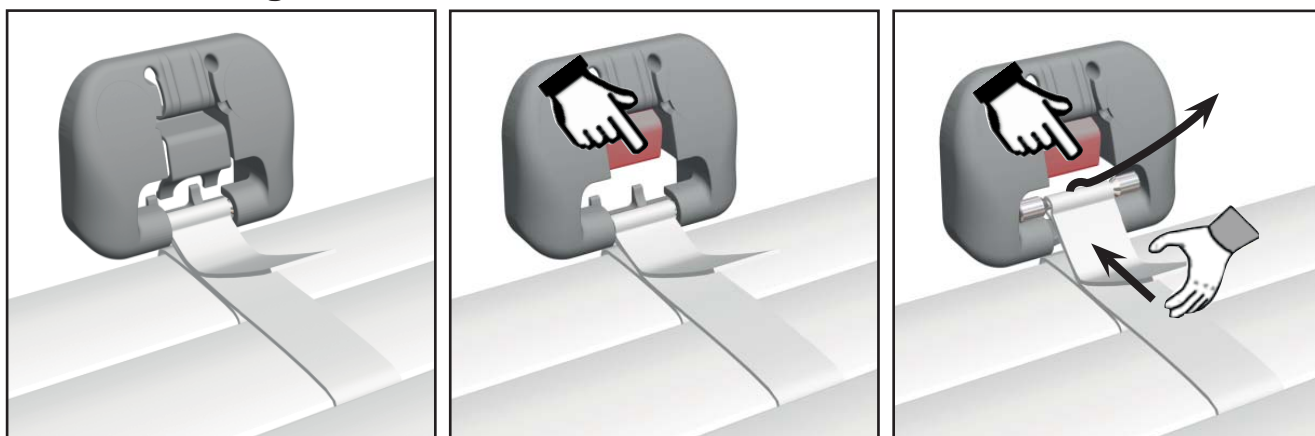

## POOL WATER LEVEL

- To guarantee optimum safety and the correct operation of the roller, always check that the pool water level remains constant and compliant with the manufacturer's recommendations. (For easier use, use a skimmer and a water level regulator).
- If the water level is too high the skimmer is blocked by leaves or other objects.
- If the water level is too low the cover may jam.
- If there is a gutter or a hand rail, the water level must be controlled by a level regulator.

## FILTRATION

- Programme filtration during sunlight hours and operate it continuously as soon as the water reaches 25°C.

## SERVICING (CUSTOMER RESPONSIBILITY)

- Clean your cover fully twice a year (start of season and wintering). This is even more important if you have hard water. To do this, use a high pressure cleaner and tepid water combined with a de-scaling product (Décalcit super).
- Also make sure the locking systems are cleaned regularly.
- It is advisable to inspect the whole system, in the event of abnormal strain on the cover (eg. somebody falling)
- Check the straps annually

## WINTERING

- Close the pool for winter depending on the geographic location.
- Close the cover in the safety position.

## MAINTENANCE

- All work must be carried out by a professional who will contact the manufacturer if necessary. (Contact details on the back of the document)
- All spare parts must be original or compliant with the standard.
- Inspect the whole cover for damage/wear and tear.
- At the start of the season, and in the event of an eventual accident (fall of a person, hail on the cover, abnormal strain on the cover etc.), check that the slats have no visible damage that may compromise the cover's safety function (cracked slats, holes, buckling, etc.). Change the slats or the whole cover if necessary.
- In both summer and winter, do not cover the slats with an opaque cover. "There is a risk of damage due to excess heat"
- Check the condition of the straps (seams).