

AUTOMATIC ABOVE-GROUND COVER

Rollin

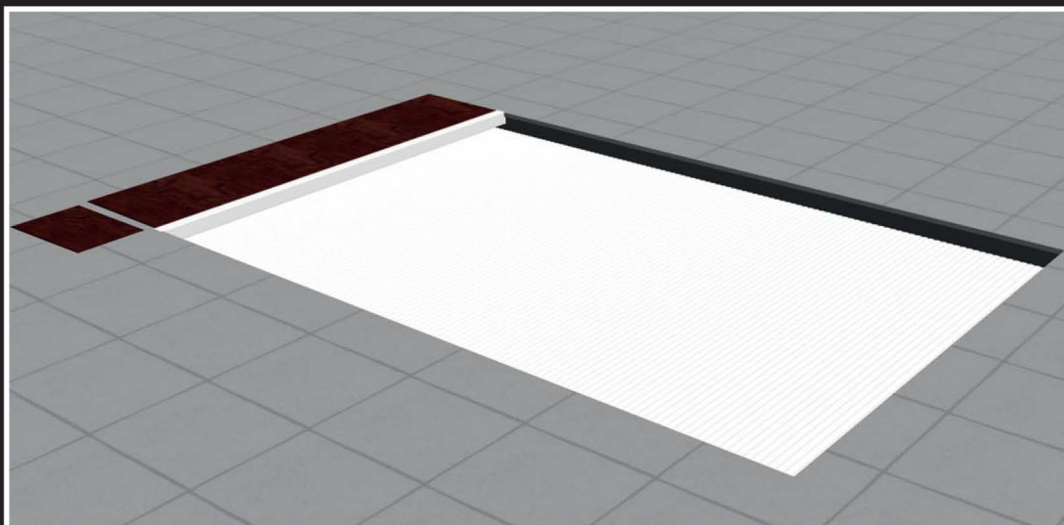

TECHNICAL INSTRUCTIONS

Installation / Use / Cleaning / Maintenance / Safety advice



**THIS NOTICE MUST BE GIVEN TO THE POOL OWNER
PLEASE READ CAREFULLY AND KEEP IN A SAFE PLACE**

PARTS INCLUDED IN THE DELIVERY

Wall units

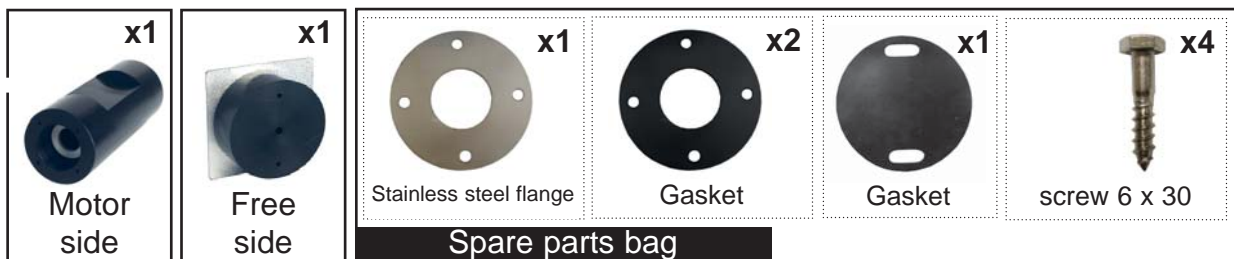

Installation kit

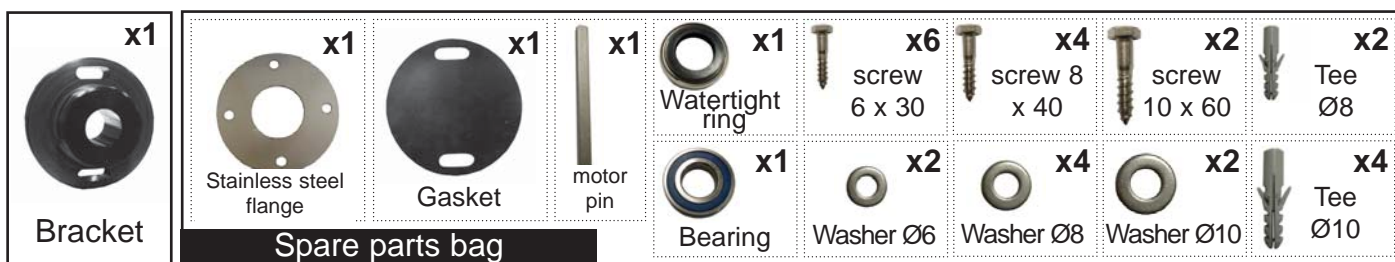

Motor with support

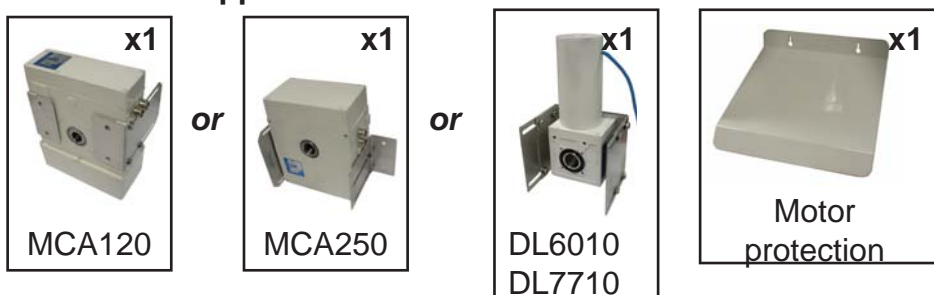

Control panel with

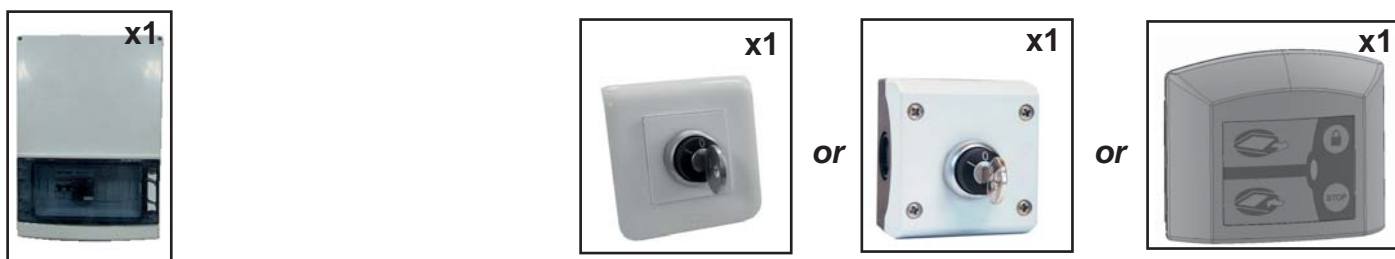

Weights



Tube

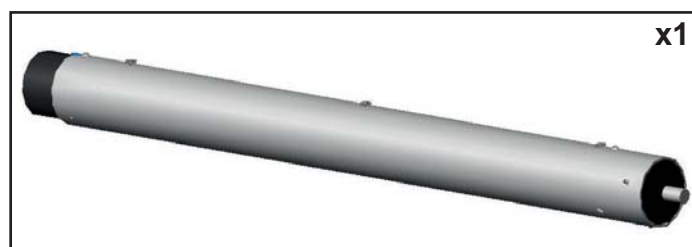

OPTION - Safety locking kit «according to your order» (1 box)

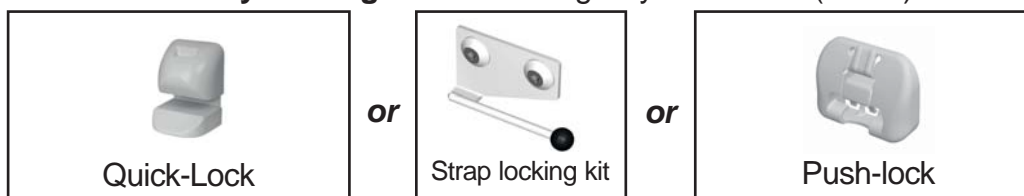

3 fitting models : Surface mounted - Insert mounted - Hanging mounted

Beam support «Model according to your order» (1 box)

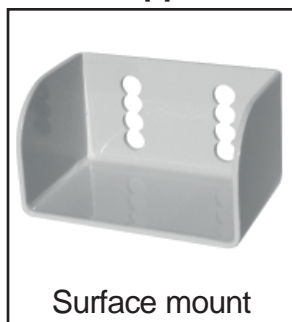

Surface mount

or



Adjustable hanging mount

or



Insert mount

Slats (model, colour and number of boxes according to your order)



Decking «Model according to your order» (1 pallet)



Aluminium beam «Model according to your order» (1 box)



Hanging and surface mount

or



Insert mount support

Middle telescopic support (1 box)

«OPTION»



(for pool width > to 6 m)

NECESSARY TOOLS - (INSTALLATION - 2 PERSONS)

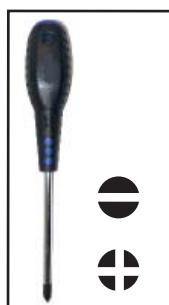

Ø8 - 12 - 20

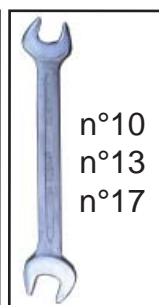

n°10
n°13
n°17



PACKING LIST

example - for a 5 x 10 m pool with Ø3 m step unit

Support + control box : 1 box of 0.65 x 0.45 x 0.25 --- 40 Kg

Tube with motor : 1 box of 0.20 x 5.10 m --- 40 Kg

Aluminum beam : 1 box of 0.15 x 0.15 x 5.10 m --- 40 Kg

Beam support : 1 box of 0.30 x 0.20 x 0.20 m --- 10 Kg

Decking : 1 pallet of 1.20 x 1.00 x 0.50 m --- 100 Kg

Slats : 5 box of 0.25 x 0.20 x 5.00 m --- 250 Kg

locking kit : 1 box of 0.30 x 0.20 x 0.20 m or 0.75 x 0.25 x 0.15 m --- 5 KG

Total weight : 485 Kg



INFORMATION

For concrete, cellular concrete, full or hollow masonry pools.

Open pool : the cover is in the cover pit under the decking.

The decking is supported by a beam installed on beam supports.

The depth of the tube is 55cm under the coping stones.

The mains supply comes from the electric control panel in the plant room.

The motor is located in a watertightness pit, and must be kept dry (forecast a drainage).

The automatic stop are adjusted in the motor or in the control panel (depends on the model).

The switch is located in a dry location with a view on the pool.

The cover is made of watertight floating slats

THE IN GROUND COVER

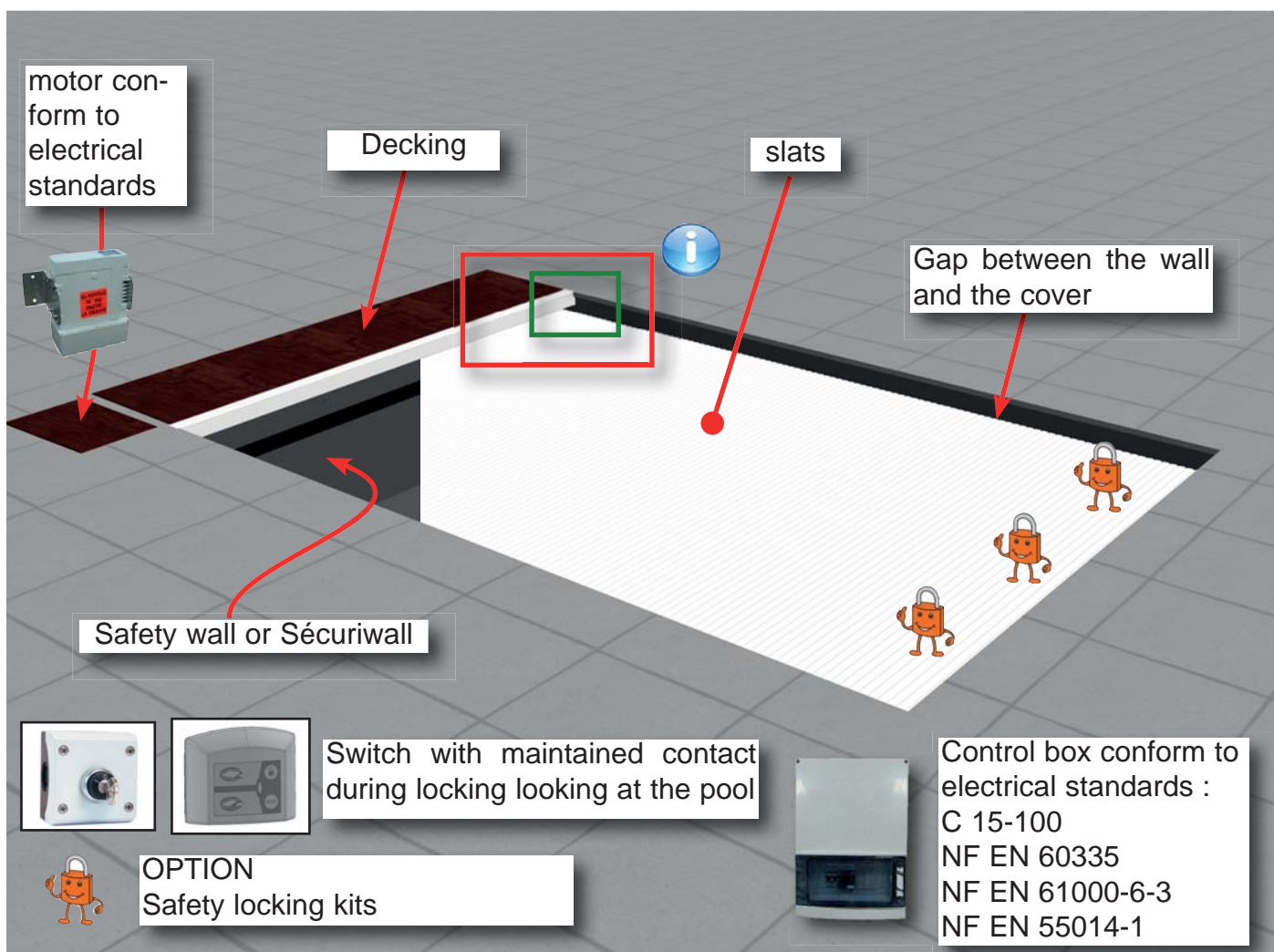

COVER PIT

The sides of the cover pit must be vertical and parallel between them.

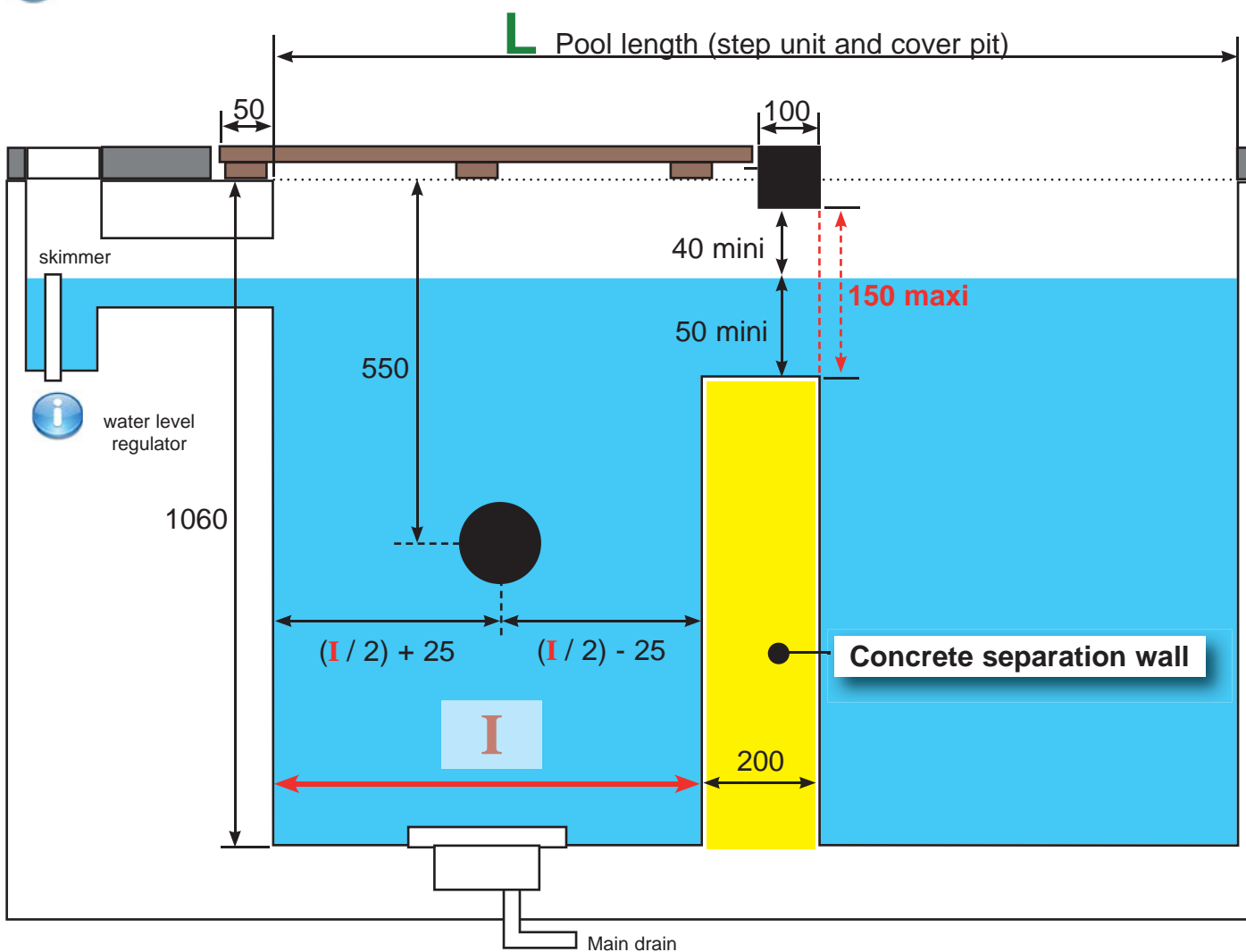

With straight radius or radius and cut sides \leq to 10 cm back of the cover pit

	Decking 750												Decking 900	
L (en m)	< 6	6 à 7	7 à 8	8à9	9à10	10à11	11à12	12à13	13à14	14à15	15à16	16à17		
I (en mm)	548	574	600	621	643	664	684	703	722	740	750	775		

L (en m)	17à18	18à19	19à20	20à21	21à22	22à23	23à24	24à25	25à26	26à27	27à28	28à30
I (en mm)	791	807	823	839	854	869	883	897	911	925	938	965

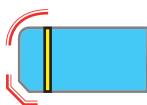

With radius and cut sides $>$ to 10 cm back of the cover pit

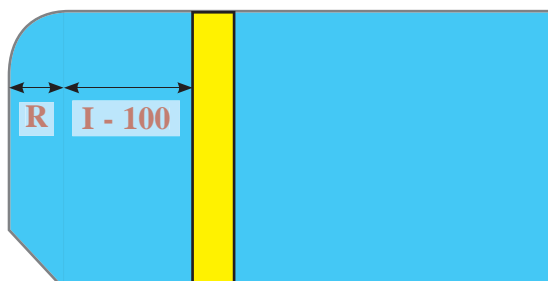

The dimension I (minimum distance of the cover pit) must be taken at the end of the radius or the cut side.

COVER PIT

 the cover may be placed to the right or left of the pool.

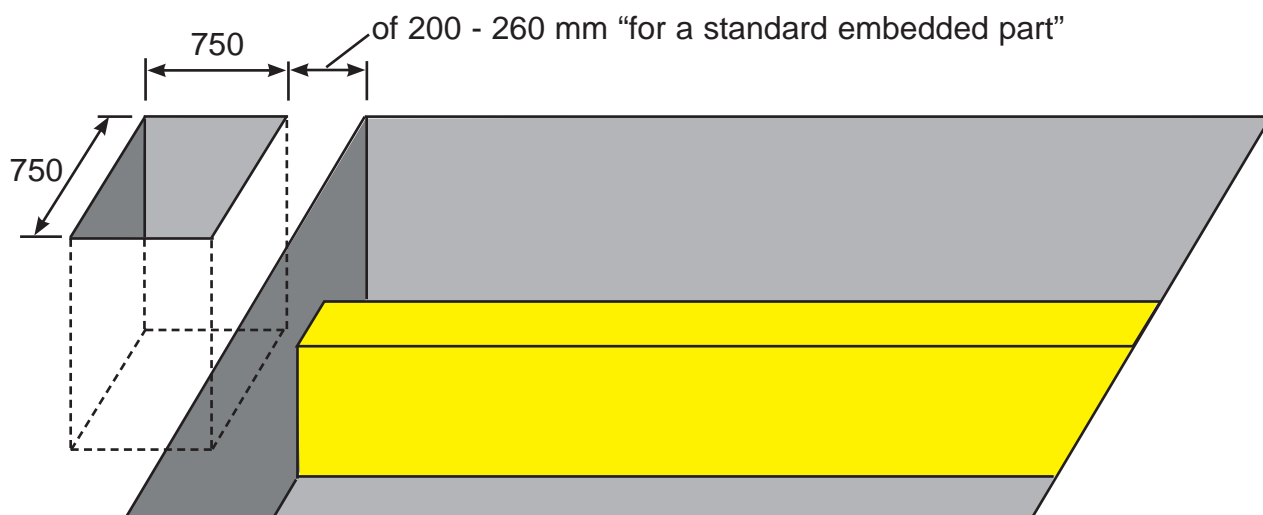

WALL UNITS

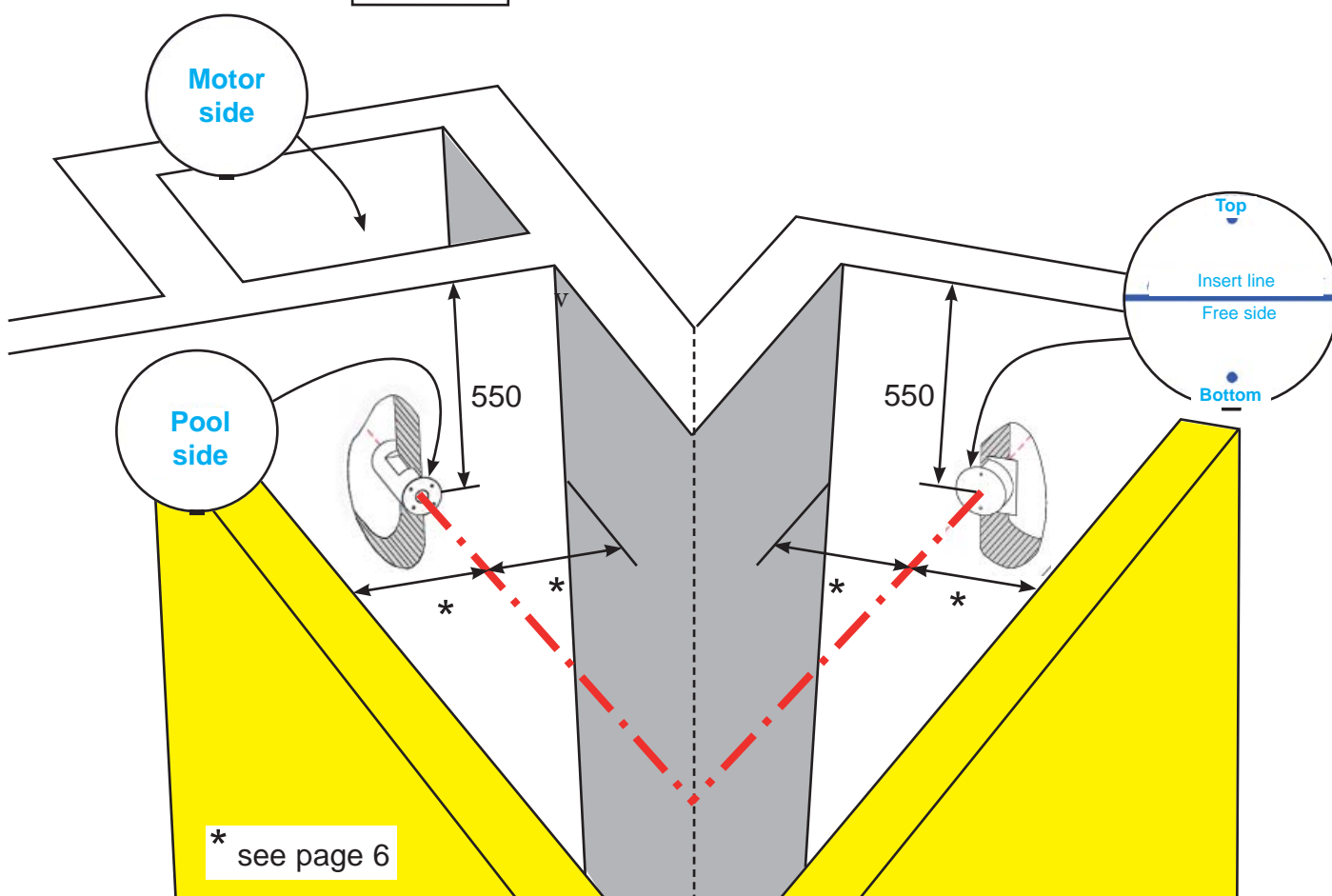
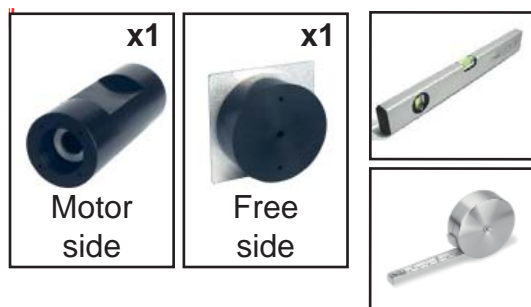

INSTALLATION OF THE FLANGE MOTOR SIDE

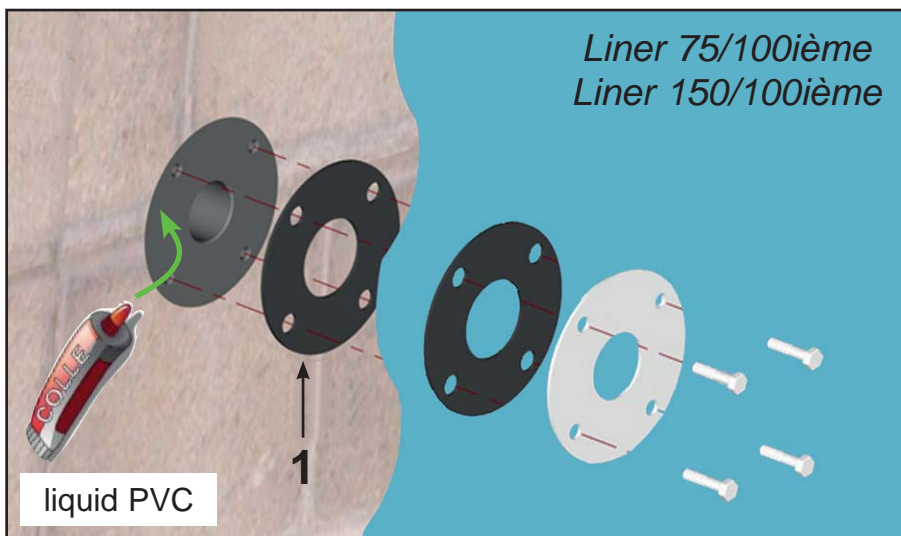
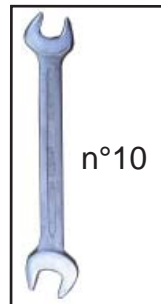
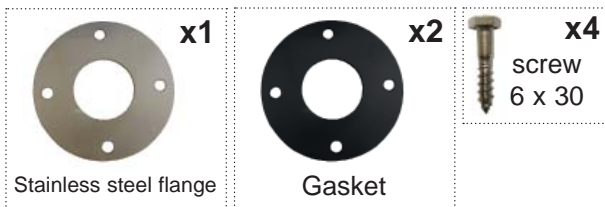

for other kind of water-tightness, do not install the gasket n°1.

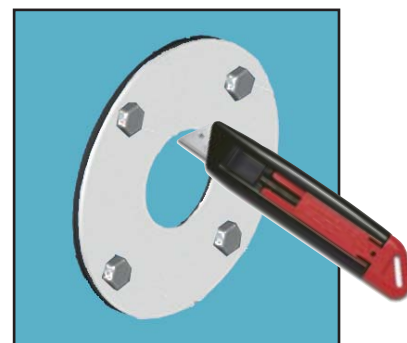

- Fill in with water (approximately 20cm) before fixing the flange.
- Cut the liner in the middle of the flange with a punch

INSTALLATION OF THE FLANGE FREE SIDE

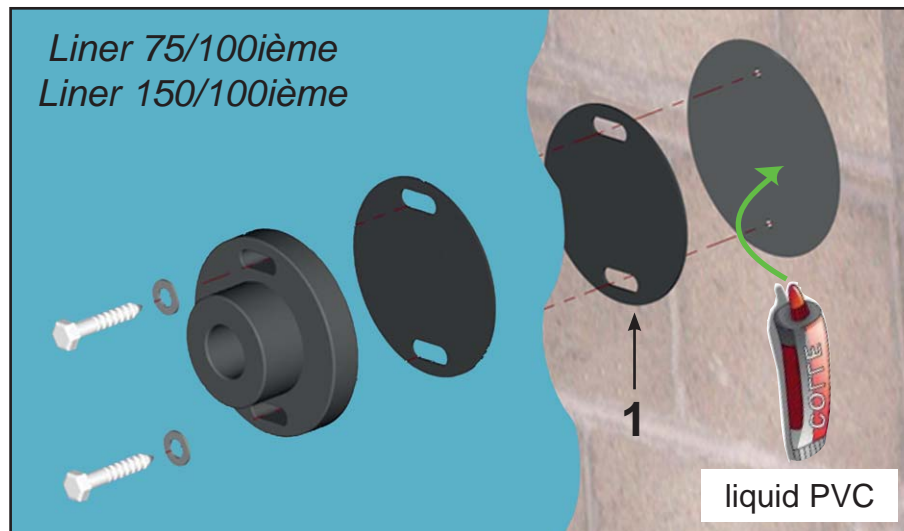
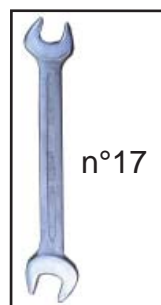
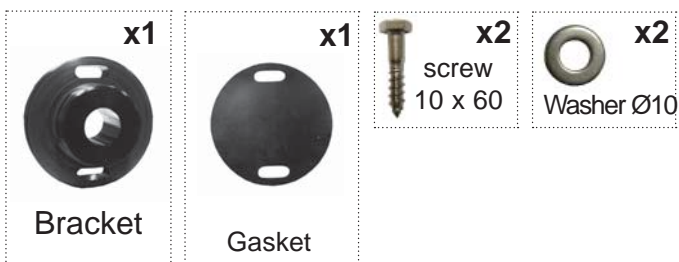

for other kind of water-tightness, do not install the gasket n°1.

- Fill in with water (approximately 20cm) before fixing the flange.
- Cut the liner in the middle of the flange with a punch.

allen key
n°4
x1

screw
M6x30
x5

Washer
PVC Ø6
x5

Spare parts bag

x1

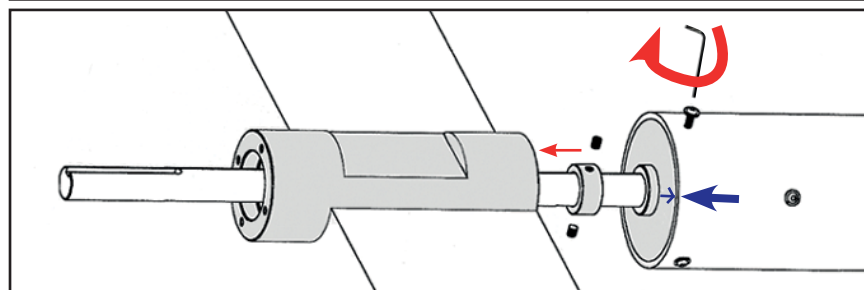
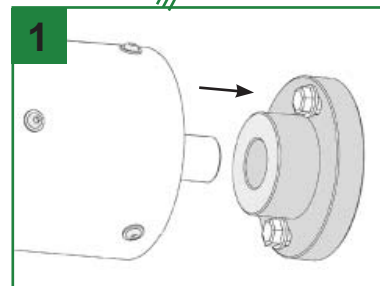
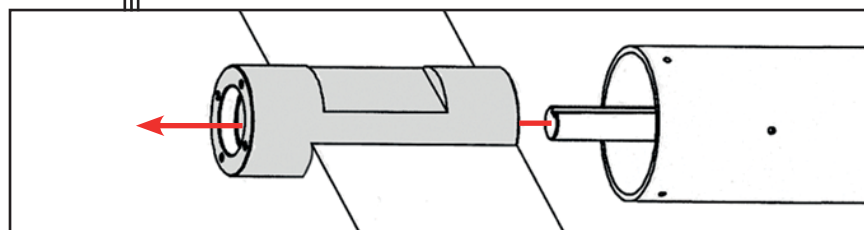
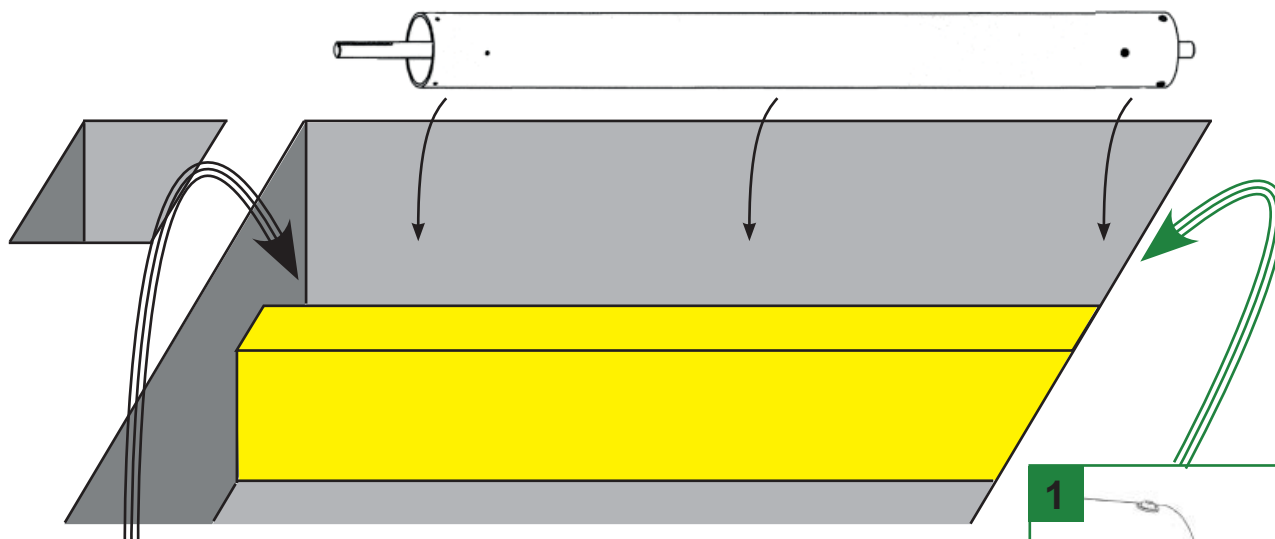
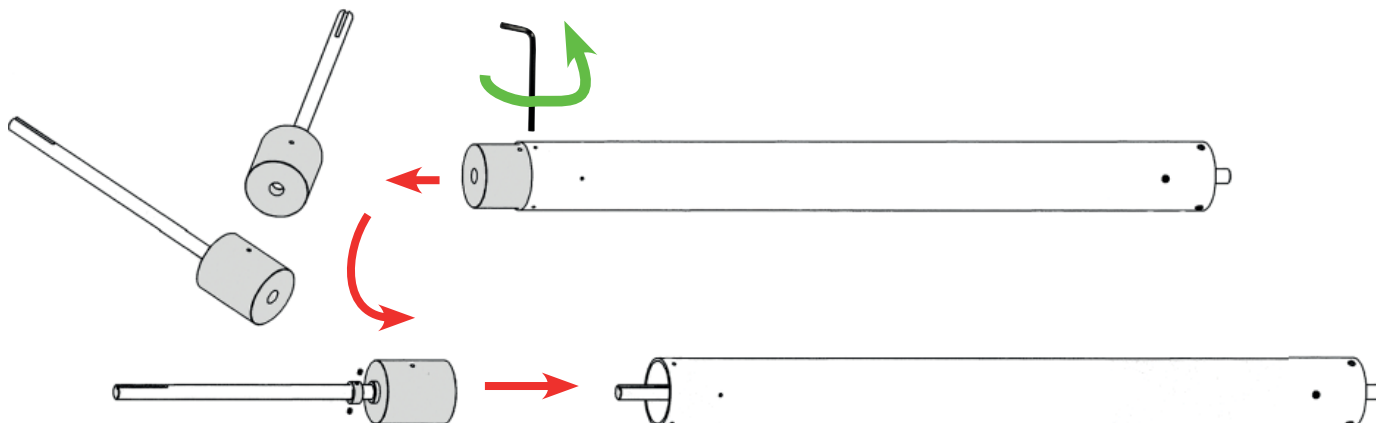

Screw
M6x30
x5

Washer
PVC Ø6
x5

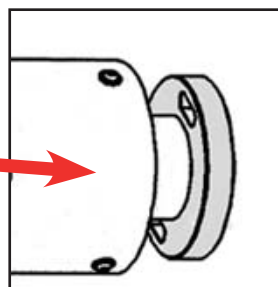
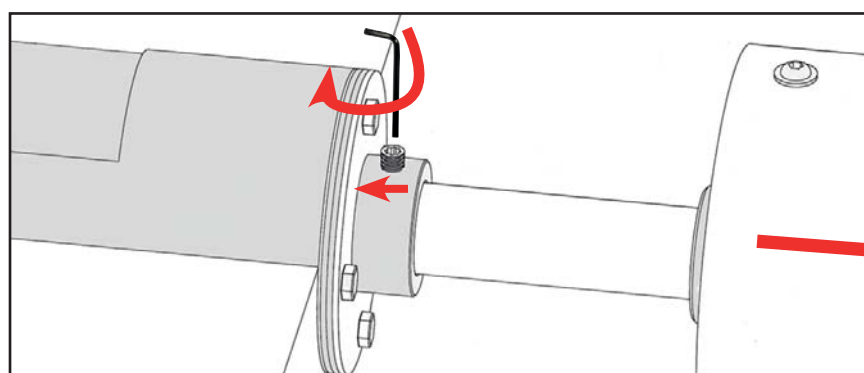

MOTOR WATER TIGHTNESS

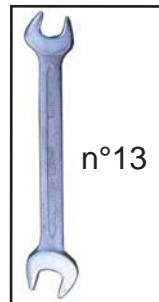

The spring of this ring must be on the bearing side

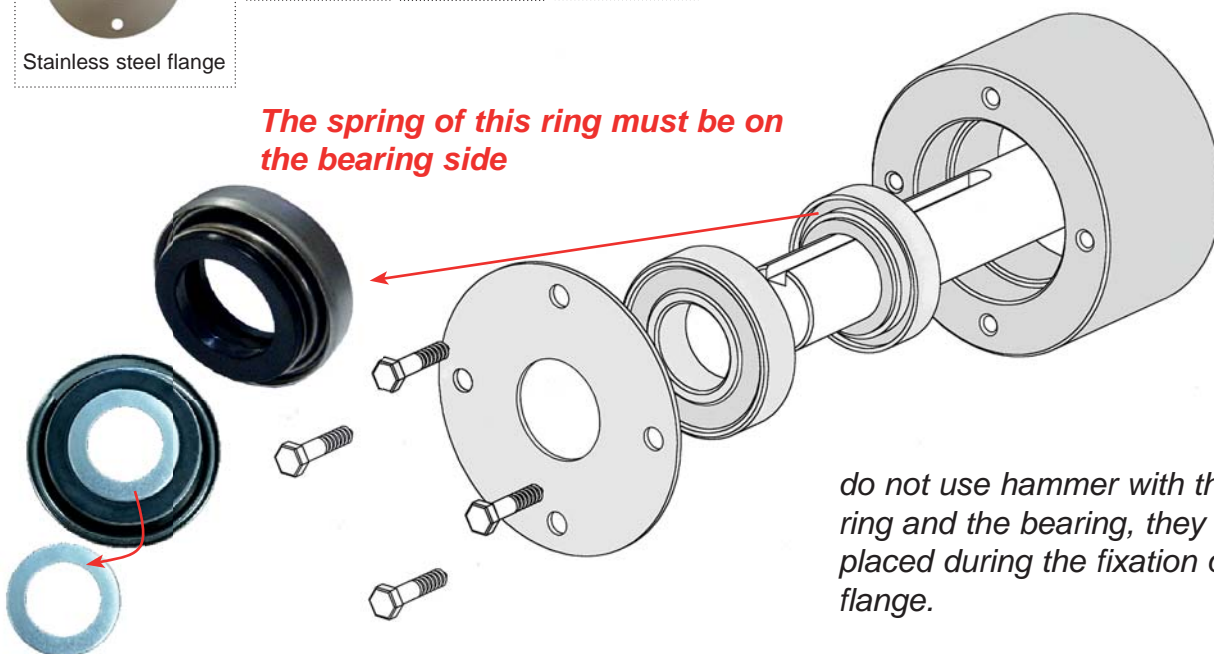

do not use hammer with the watertight ring and the bearing, they will be placed during the fixation of the flange.

MOTOR INSTALLATION

10

Change the motor supports

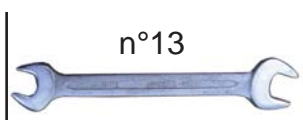

MCA 120



MCA 250



Motor installation

MCA 120



MCA 250



PL6010/7710



PL6010/7710



Fixation

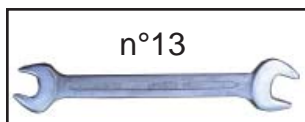

MCA 120

MCA 250



PL6010/7710

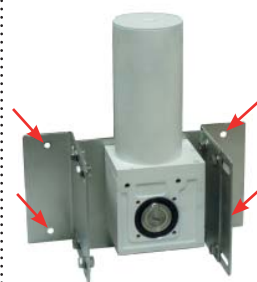

Put the motor pin

MCA 120

MCA 250



PL6010/7710



Motor protection installation

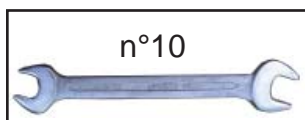

MCA 120

MCA 250



PL6010/7710



Option : electrical plug

BEAM SUPPORTS

Adjustable hanging mounted model

For concrete or panel pools



Align the beam support with the separating wall

Cover pit

15 cm
Max

Nut Inox A4 M10

Hanging support

Screw
inox A4
M10 x 60

Washer
Ø10

Sleeve
Ø12



Panel settlement :

Screw
M8 x 20

Washer Ø8

Nut M8

12

Insert mounted model

For concrete pools

Align the beam support with the separating wall

Cover pit

15 cm
Max

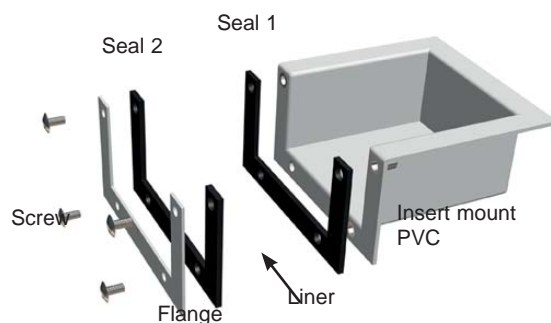

Glue the first gasket of the beam support.
Install the liner.
Install the second gasket, the stainless steel flange and screw.
Cut the liner inside the beam support with a cutter.

Surface mounted model

For concrete or panel pools and pools with a wall thicker than 8mm

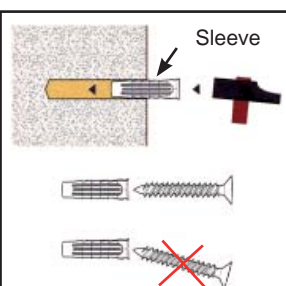
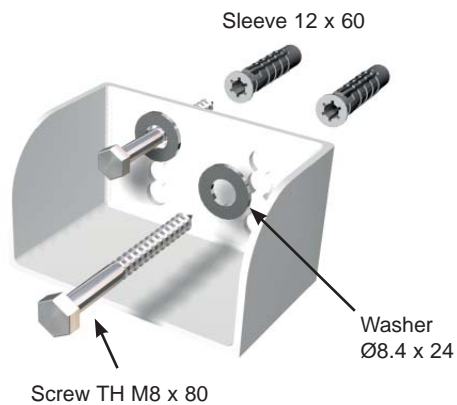
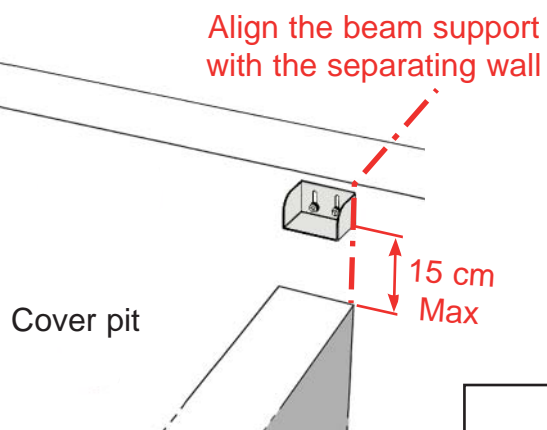

Concrete

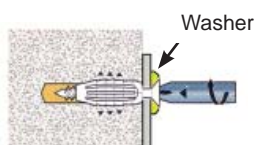

Do not tighten the screws after the resistance point, you could damage the installation.

Concrete blocks

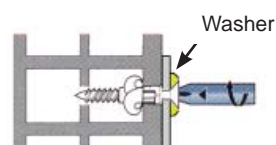

Once the resistance point has been reached, turn the screws 3 times to finish the installation.

COVER INSTALLATION

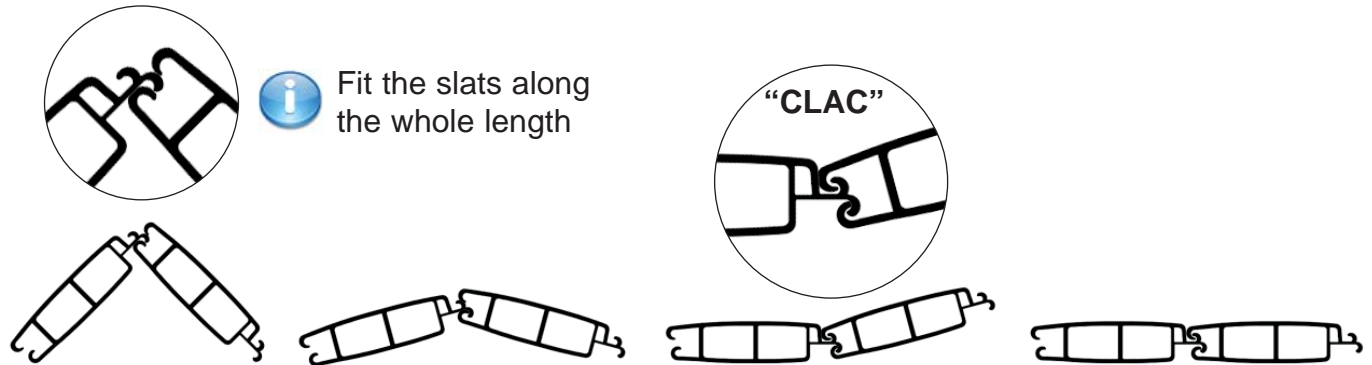
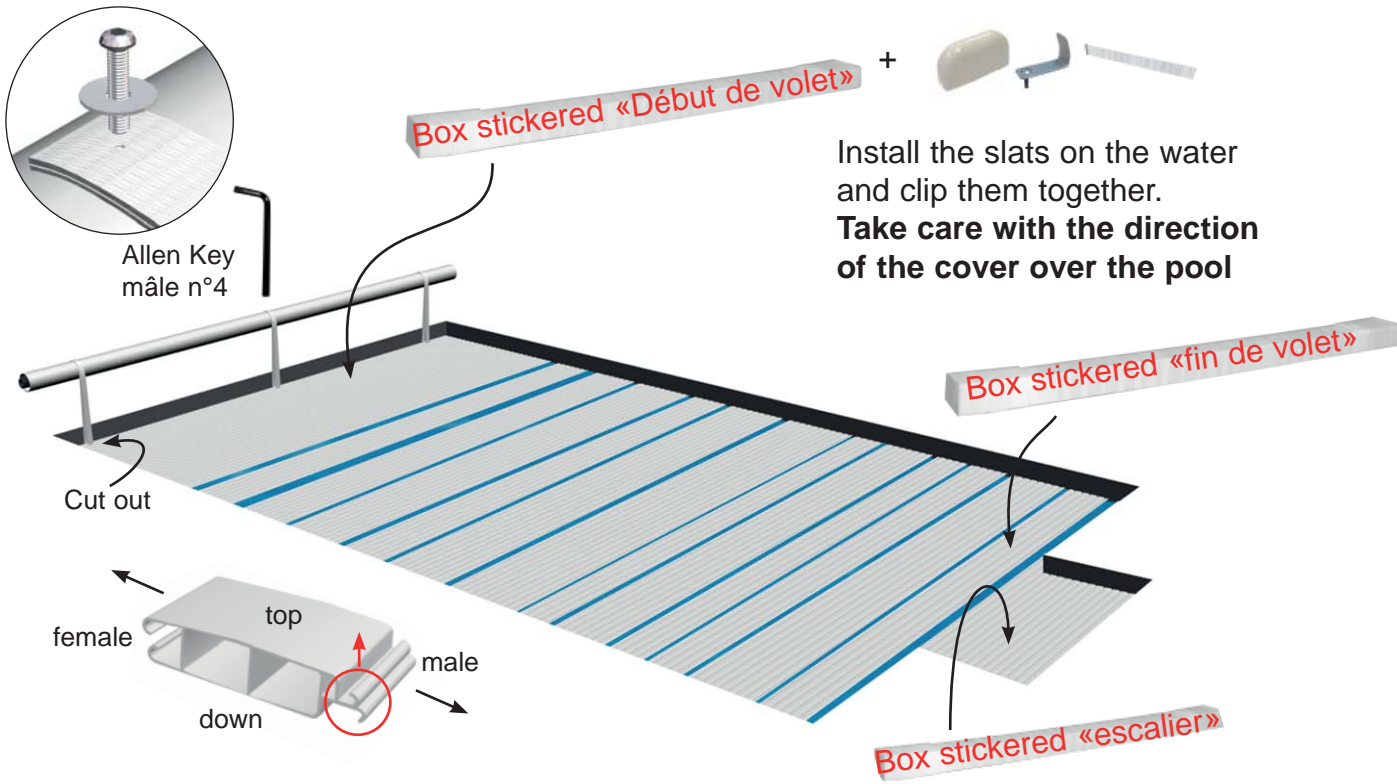

i Repeated wiggling/handling of the slats may be needed..

STEP UNIT HOOK INSTALLATION

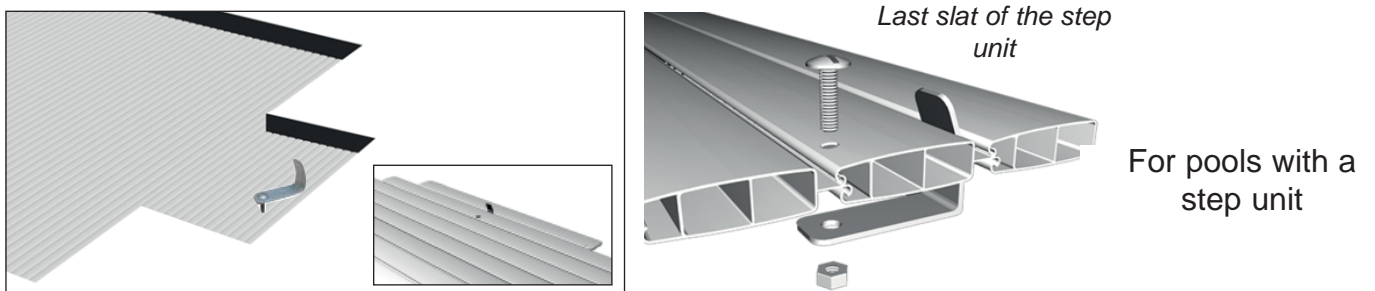

HOW TO TAKE OFF A SLAT AND END CAPS ?

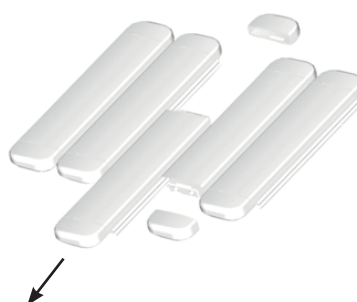
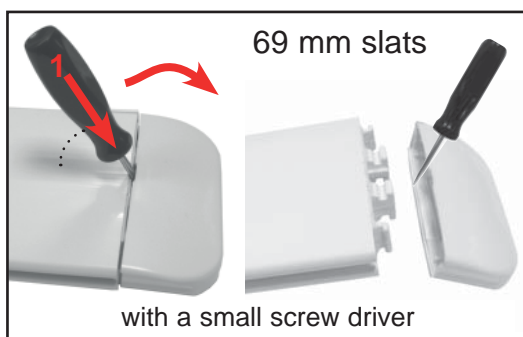

ALUMINIUM BEAM INSTALLATION

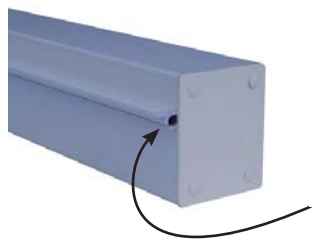

Cover pit side

Middle telescopic support

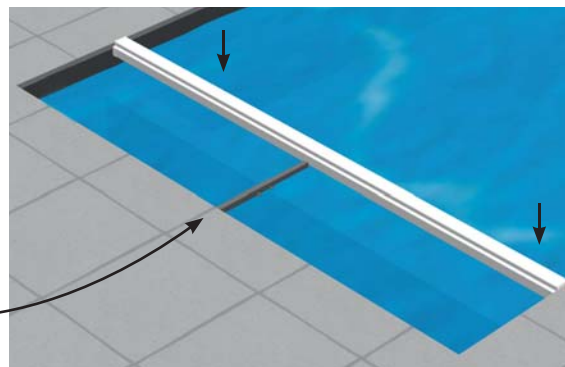

OPTION MIDDLE TELESCOPIC SUPPORT

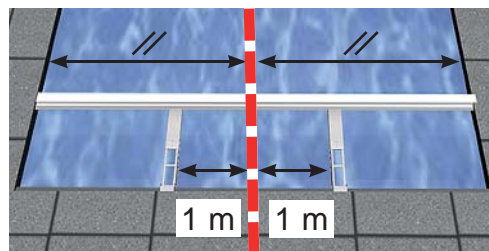
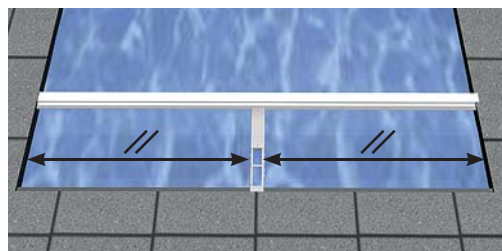
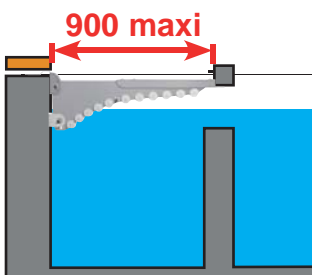

For pool over 6 m wide, you need to install 1 or 2 middle telescopic support, to maintain the beam.

WEIGHT INSTALLATION

Weights guarantee a better reeling of the cover around the tube and guide the cover. The weight for the step unit prevents the slats from falling behind the cover pit.



weight for step unit

weight

Step unit hook

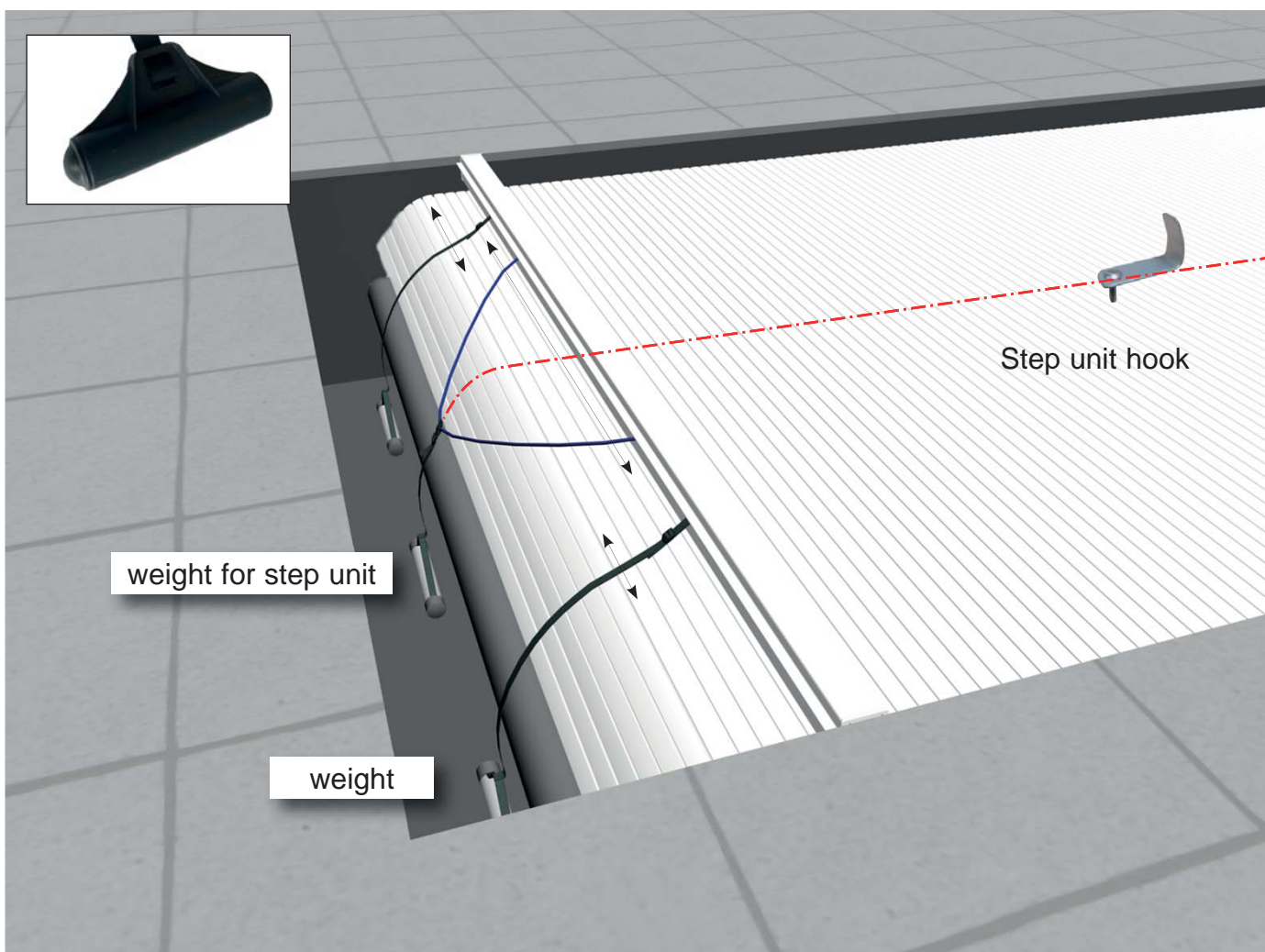

ADJUSTMENT OF THE WEIGHT DEPTH

Adjust the depth of the weight

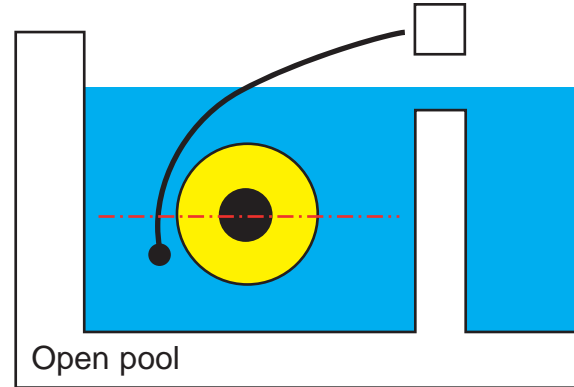
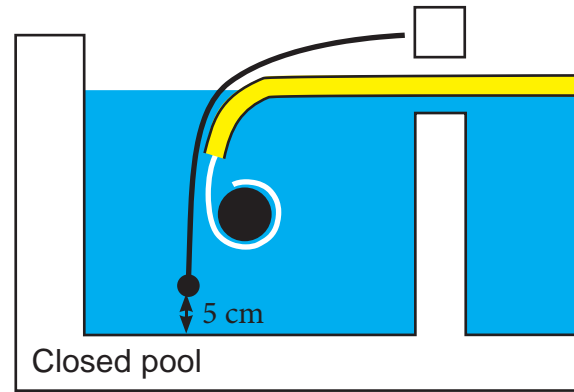
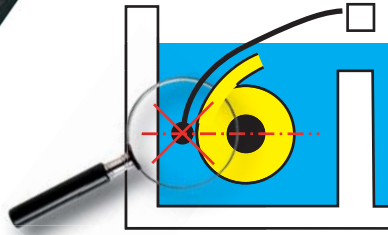

DECKING INSTALLATION

16

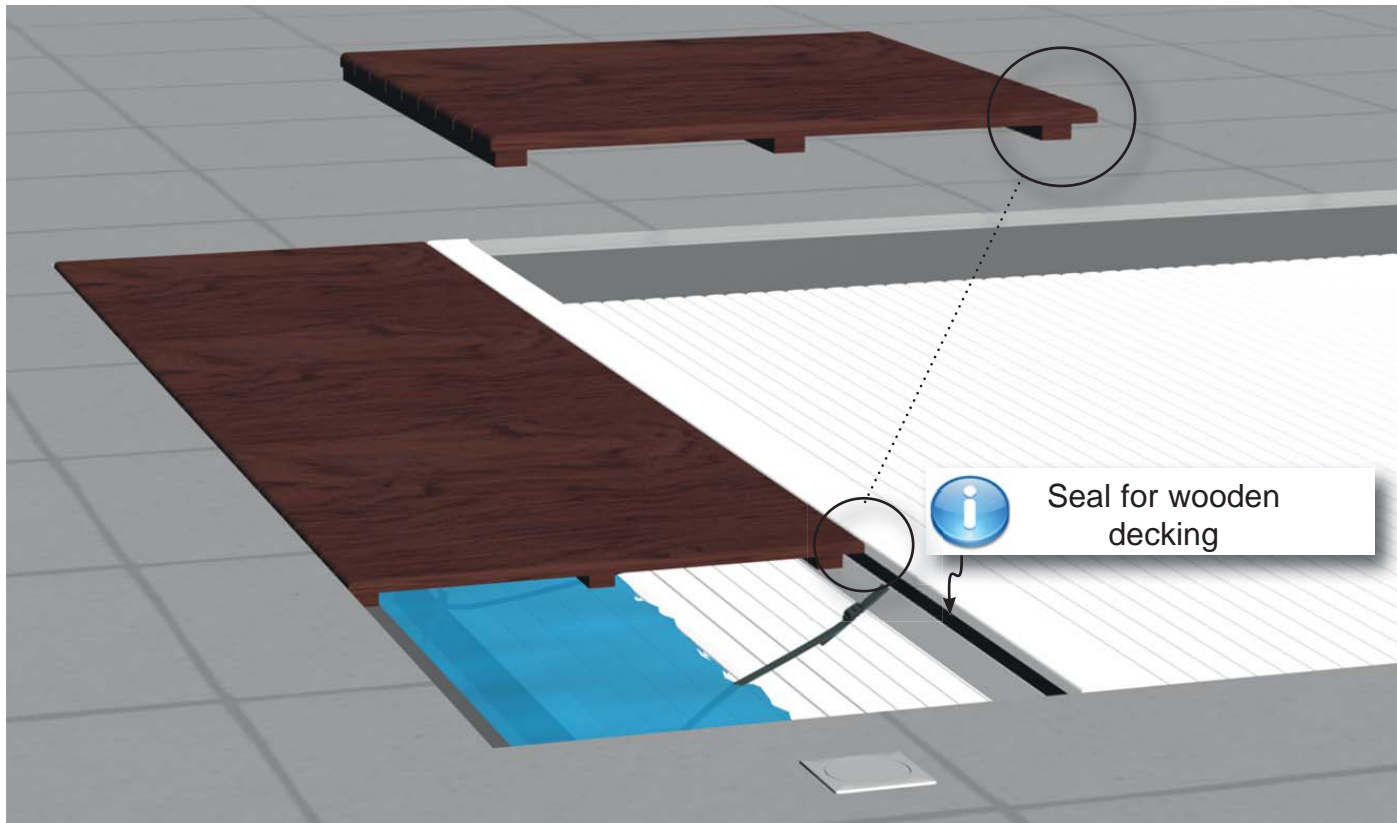

The electric control box must be fitted in a dry room.
 The installation must comply with the NF C15-100 standard. et CEI 60364
 (Last applicable version) ask your electrician for advice or contact your electricity provider.
 All our control boxes use a 230 Volt single phase (50Hz) power supply.
 The required power at the input terminals is 0.15 Kw.
 Upstream from the control box a suitably sized circuit breaker with a 30 mA ground fault device must be provided.
 For additional information, see the instructions supplied with the electrical box.

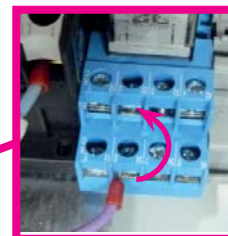

For salt electrolysis system:
 Inversion of the NO / NC control logic

Circuit breaker with a 30 mA protection.



Connection

Plug **N** and **L**

230 VDC

monophased 50 Hz

OPTION
 Electrical plug
 see page 21

3 x 1,5 mm²

Salt electrolysis system

(U1000RO2V in a sheath)

2 x 4 mm² - up to 16 m in length.
 2 x 6 mm² - from 16 to 25 m in length.

ELECTRICAL DRAWING CONTROL BOX AQUA1 --- MCA120 / MCA250 WITH KEY WITCH

The electric control box must be fitted in a dry room.

The installation must comply with the NF C15-100 standard. et CEI 60364

(Last applicable version) ask your electrician for advice or contact your electricity provider.

All our control boxes use a 230 Volt single phase (50Hz) power supply.

The required power at the input terminals is 0.15 Kw.

Upstream from the control box a suitably sized circuit breaker with a 30 mA ground fault device must be provided.

For additional information, see the instructions supplied with the electrical box.



For salt electrolysis system:
Inversion of the NO / NC
control logic

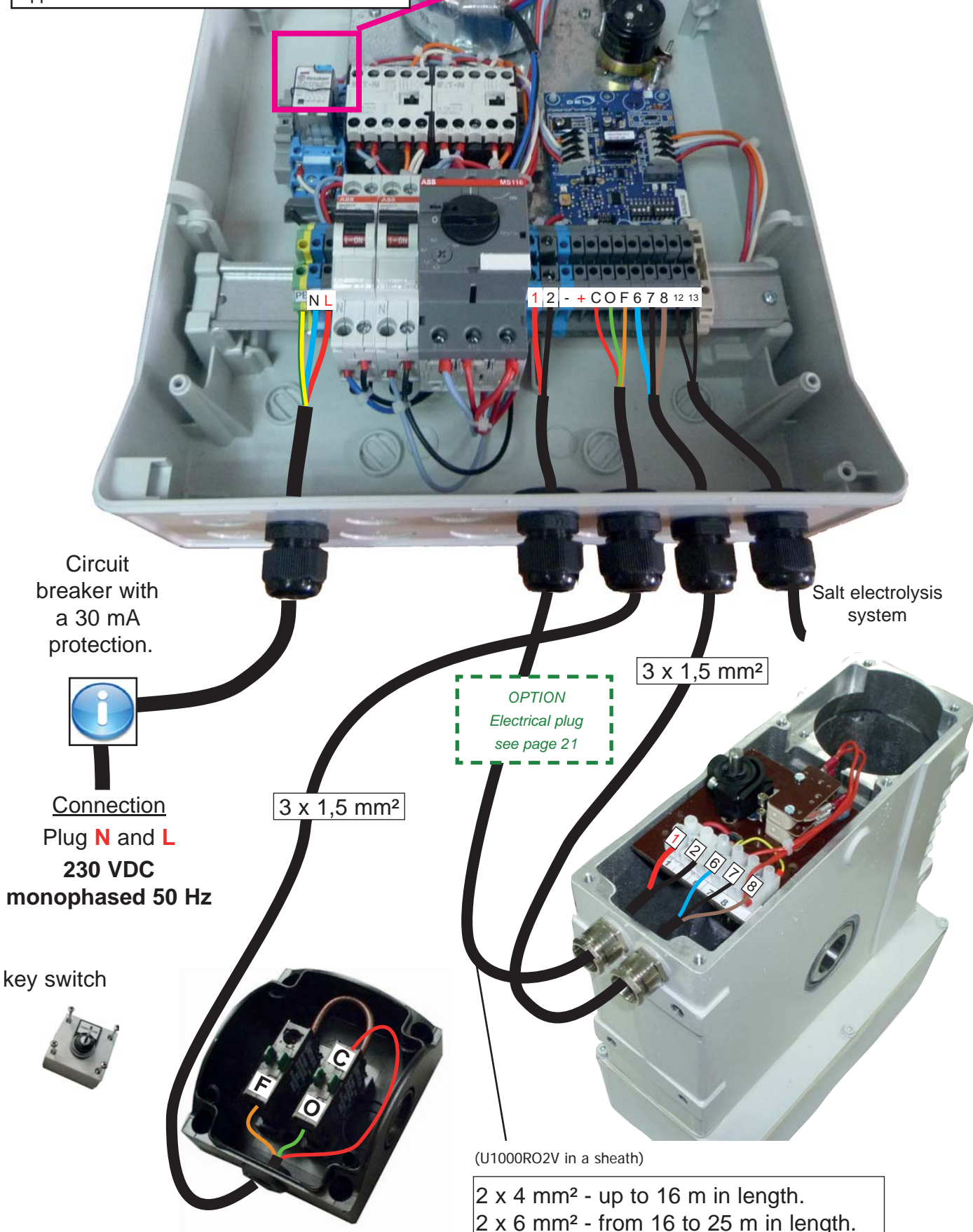

The electric control box must be fitted in a dry room.

The installation must comply with the NF C15-100 standard, et CEI 60364.

(Last applicable version) ask your electrician for advice or contact your electricity provider.

All our control boxes use a 230 Volt single phase (50Hz) power supply.

The required power at the input terminals is 0.15 Kw.

Upstream from the control box a suitably sized circuit breaker with a 30 mA ground fault device must be provided.

For additional information, see the instructions supplied with the electrical box.

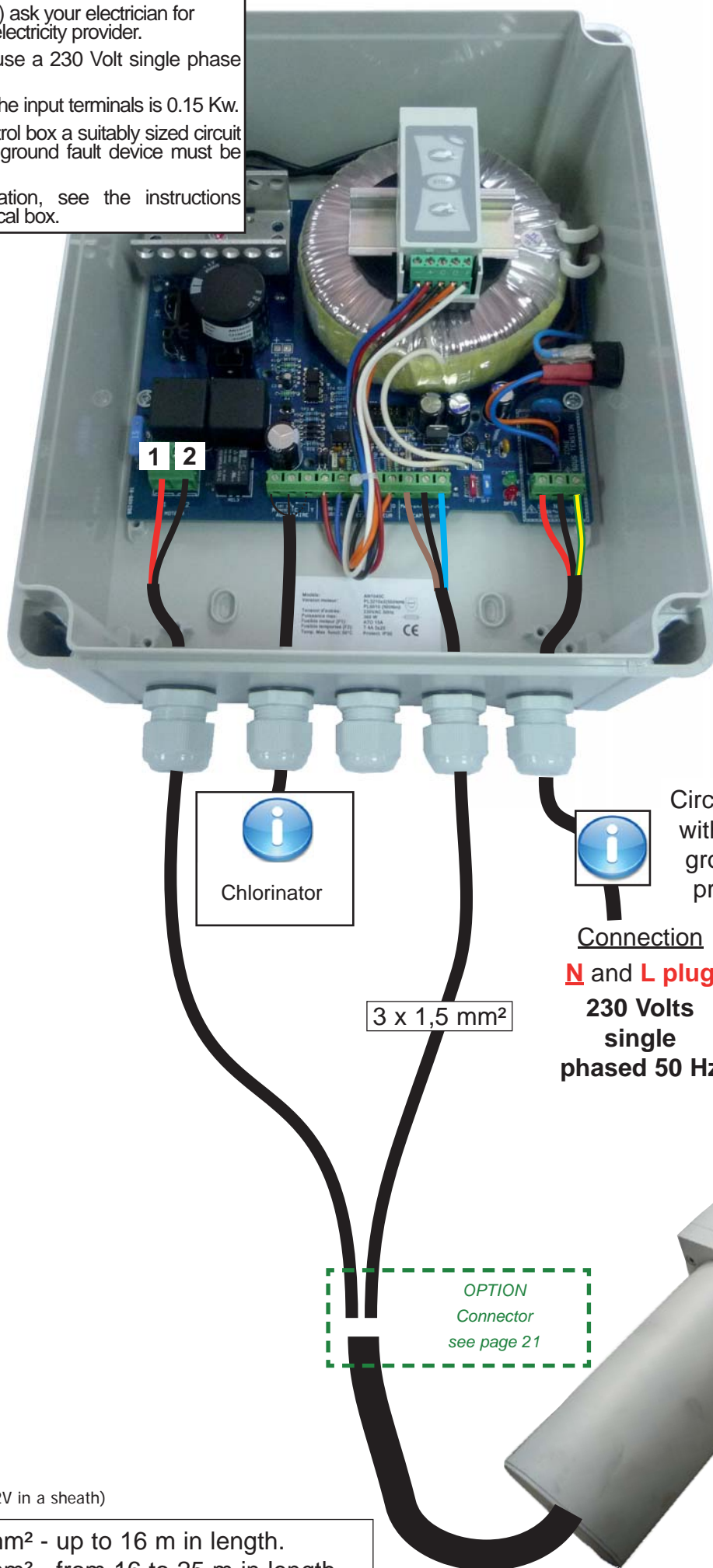

Chlorinator

Circuit breaker
with a 30 mA
ground fault
protection.

Connection

N and **L plug**

230 Volts

single

phased 50 Hz

3 x 1,5 mm²

OPTION
Connector
see page 21

(U1000RO2V in a sheath)

2 x 4 mm² - up to 16 m in length.

2 x 6 mm² - from 16 to 25 m in length.

The electric control box must be fitted in a dry room.
The installation must comply with the NF C15-100 standard. et CEI 60364
(Last applicable version) ask your electrician for advice or contact your electricity provider.
All our control boxes use a 230 Volt single phase (50Hz) power supply.
The required power at the input terminals is 0.15 Kw.
Upstream from the control box a suitably sized circuit breaker with a 30 mA ground fault device must be provided.
For additional information, see the instructions supplied with the electrical box.

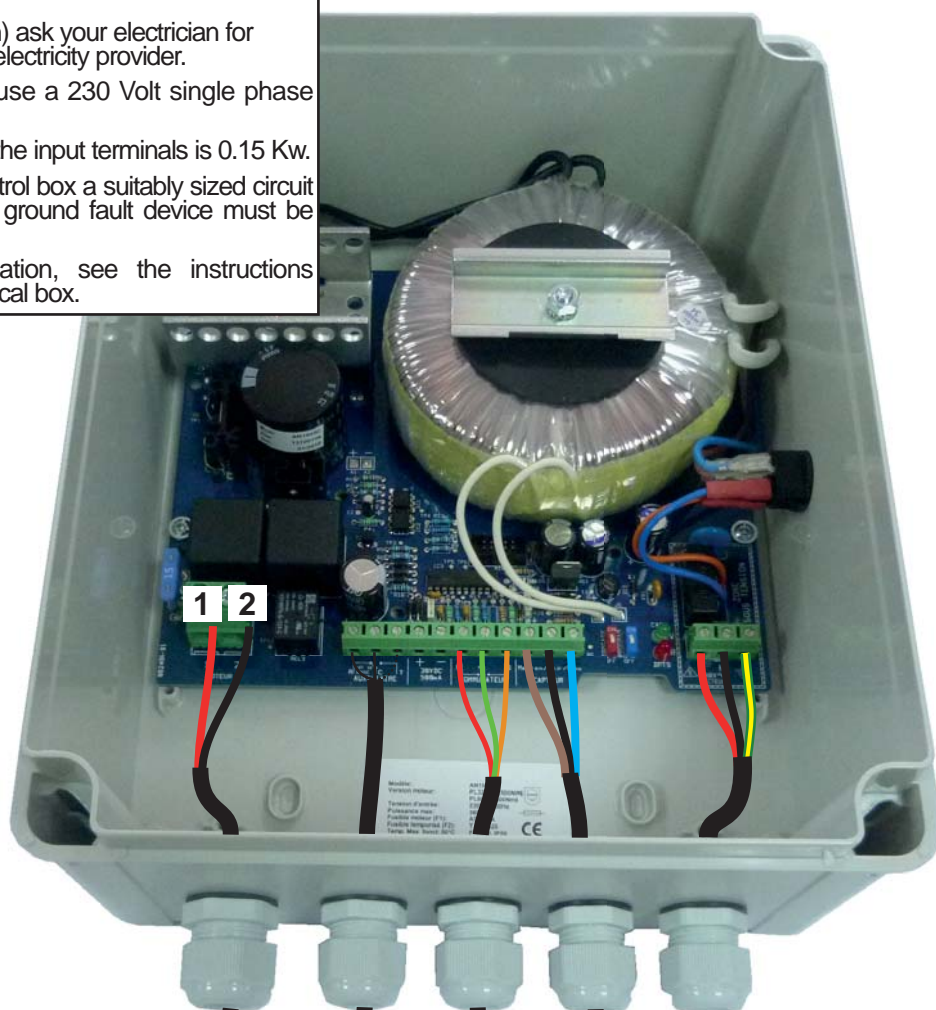

Circuit breaker with a 30 mA ground fault protection.

Connection

N and L plug
230 Volts
single
phased 50 Hz

3 x 1,5 mm²

key switch



3 x 1,5 mm²



OPTION
Connector
see page 21



(U1000RO2V in a sheath)

2 x 4 mm² - up to 16 m in length.
2 x 6 mm² - from 16 to 25 m in length.



Located between the motor and the control panel, allows to unplug the motor without dismantling it
For winterizing, replace the motor by the winterizing handle

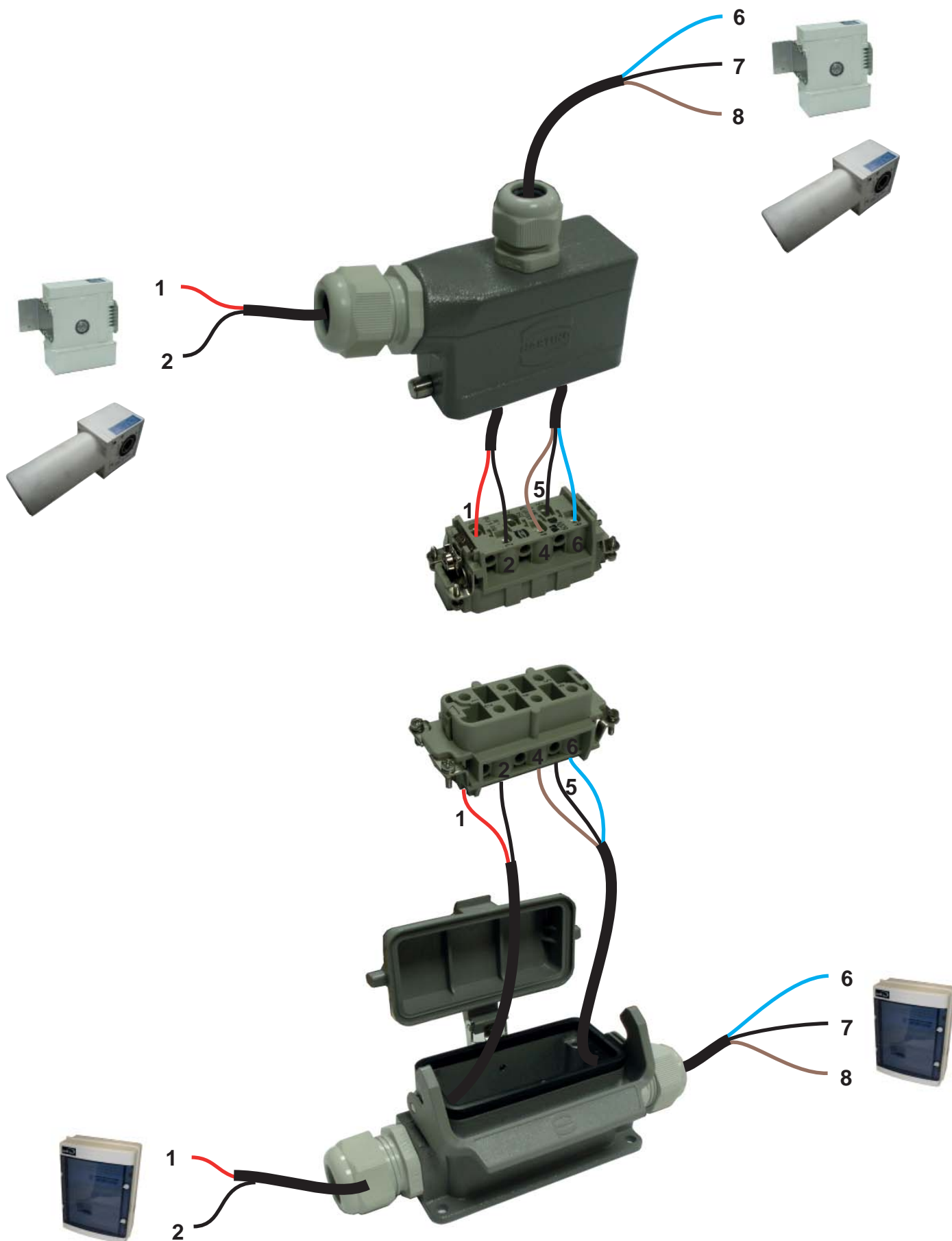

WI-KEY INSTALLING THE CONTROL BOX



red / green flashing = emitter locked
Emitter unlocking procedure see «page 36»

The emitter must be located outside volume 0.

The distance between the emitter and the receiver must not exceed:

- 50 m in an obstacle-free zone.
- 25 m behind a basic wall.
- 15 m behind several walls or an especially thick wall.

we recommend checking emitter/receiver communication before fixing permanently.

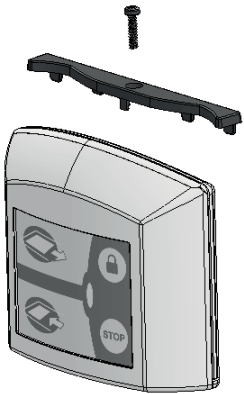

- It must be located in a place from which it is possible to check that no one enters the pool during the manoeuvre.
- It is mandatory to install the locking «strip».
- Before fixing the control box, check that the emitter is communicating with the receiver.

The support must be attached to a fixed support

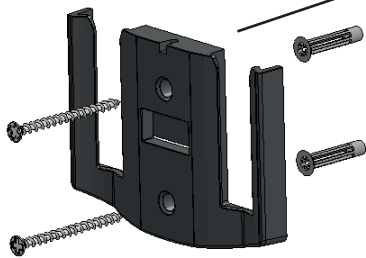

Closing

Opening



Keyboard lock



Stops the current action

Checking of the automatic stop position

1

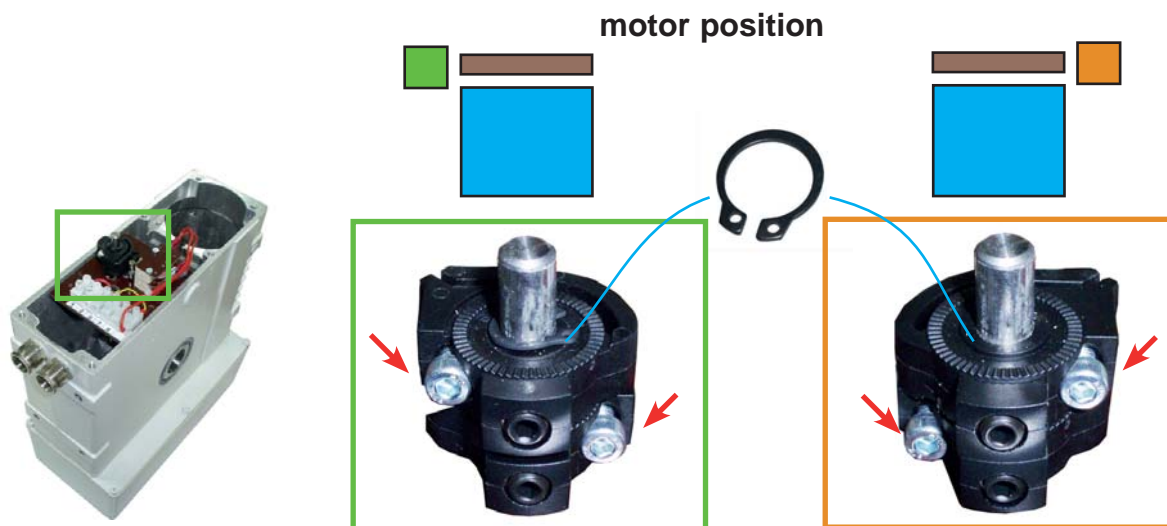

Untighten the cam screws

2

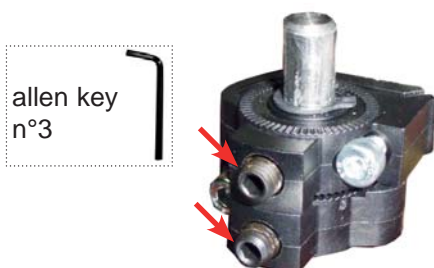

Close the electronic card

3

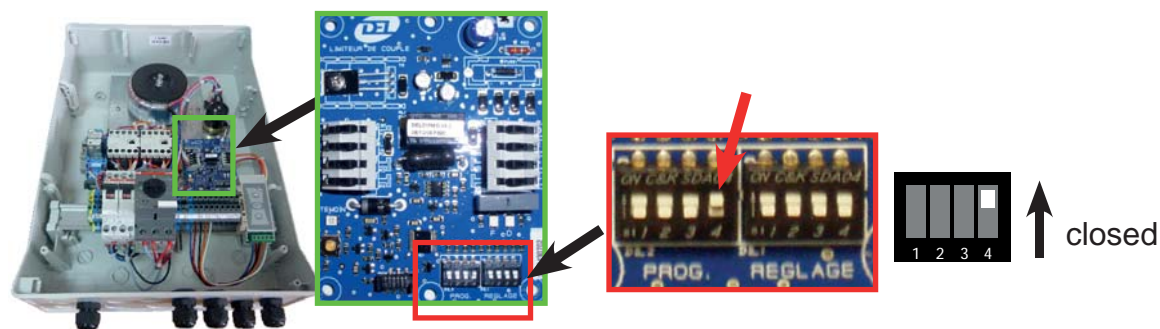

Checking of the roll in roll out direction

4

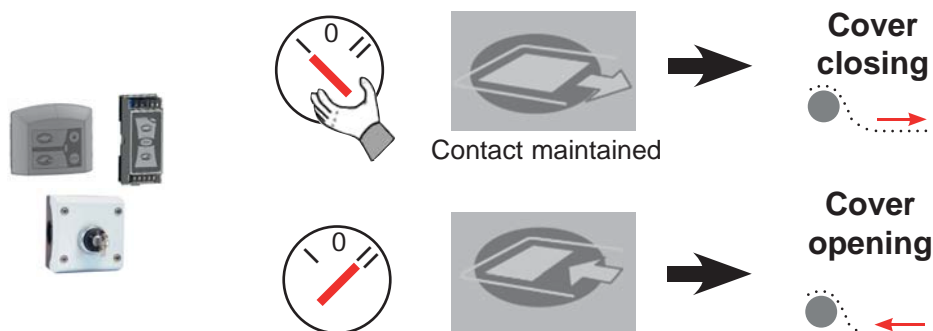

if the control logic is incorrect, Check the wiring installation

Cover installation «open pool»



Adjust the position of the cover using the programme «open and closed»



Be careful to choose the right position, it will be the starting reference.



5

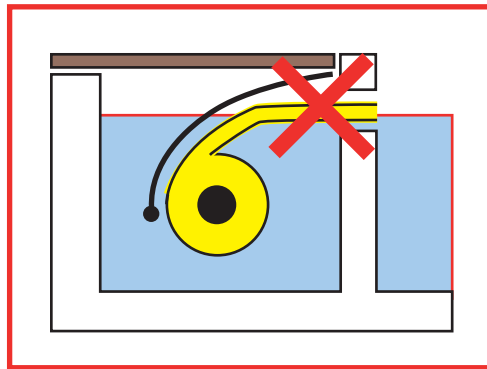
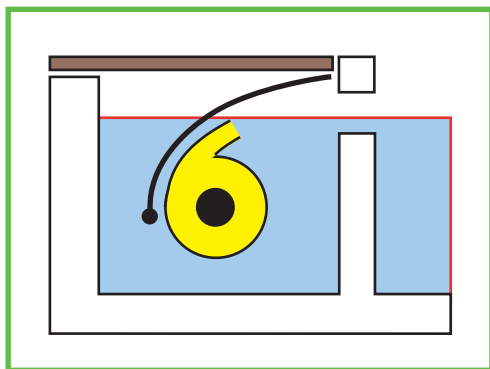

24

6

Recording position «open pool»

Allen key
n°3

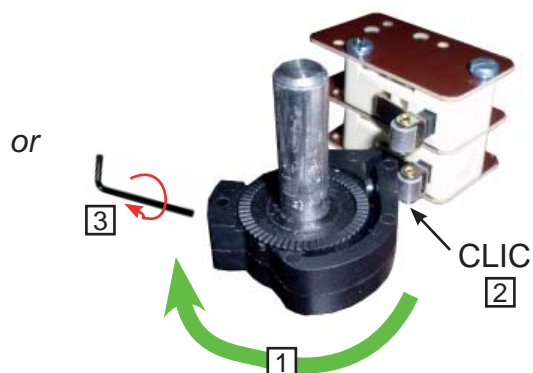
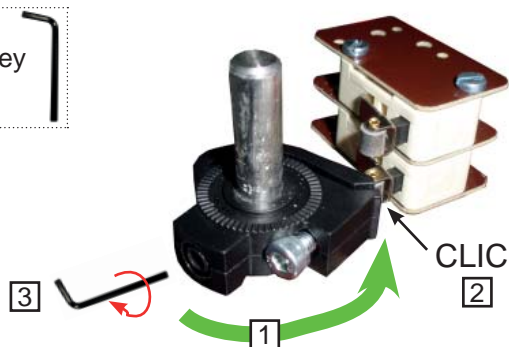

Cover installation «closed pool»



Adjust the position of the cover using the programme «open and closed»

7

Be careful : the last operation used must be a closing.

«if you cannot close the cover, chek the electric control is correct and start the automatic stop adjustment procedure from the begining. »

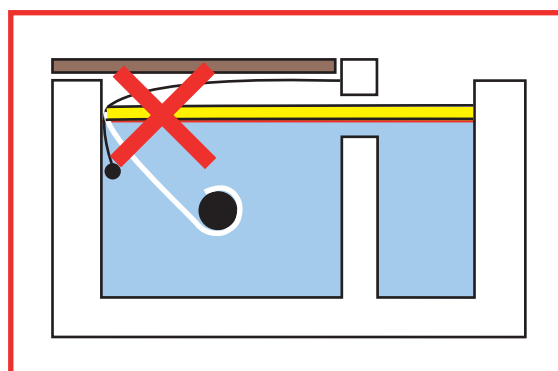
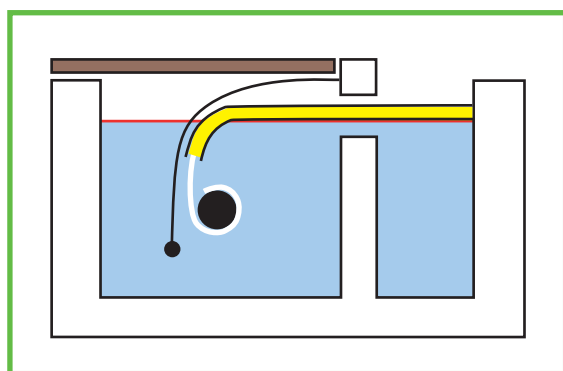

Recording position «closed pool»

Allen key
n°3

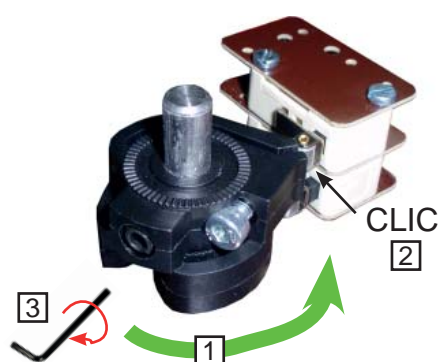

or

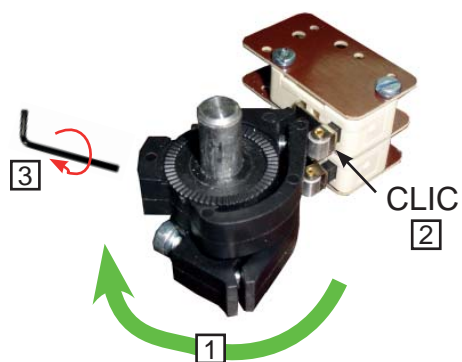

Automatic stop adjustment

8

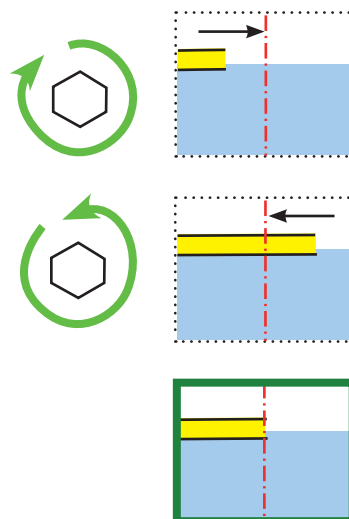
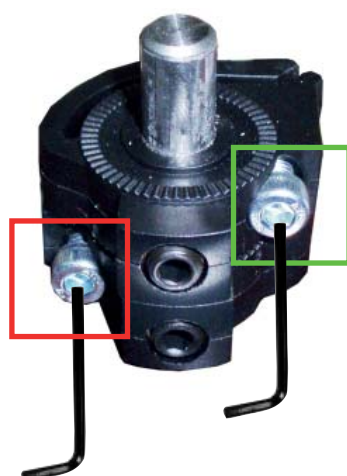
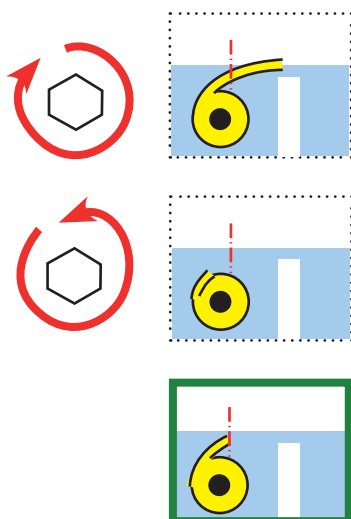

1

1 - Programme starting :



2

check up



Contact maintained

Cover closing



Cover opening



if the control logic is incorrect, Check the wiring installation

26

Cover installation «open pool»



Adjust the position of the cover using the programme «open and closed»

Be careful to choose the right position, it will be the starting reference.

3

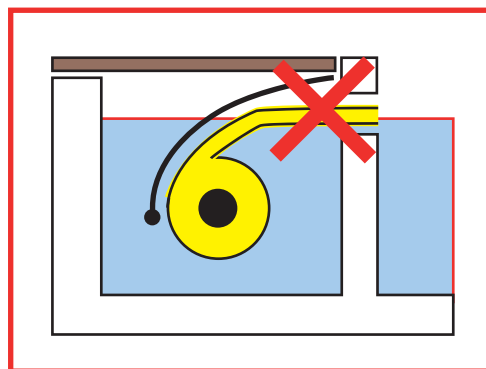
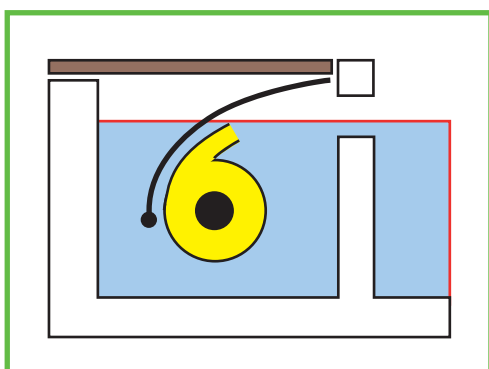

4

Recording position «open pool»



Cover installation «closed pool»



Adjust the position of the cover using the programme «open and closed»

Be careful : the last operation used must be a closing.

«if you cannot close the cover, chek the electric control is correct and start the automatic stop adjustment procedure from the begining. »

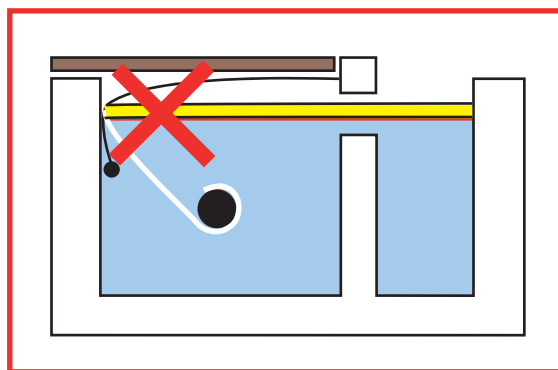
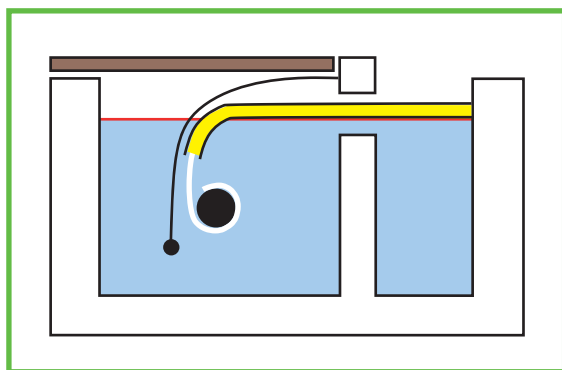

5

Recording position «closed pool»



6

7

Automatic stop adjustment is over.

INFORMATIONS

The torque limiter device protects the system in case locking kits are unreleased during the opening.

In the event of excessive resistance during opening the motor is automatically stopped.

Cases of torque limiter activation :

- Unreleased safety locking kit.
- cover rudding (coping stone...)
- Object wedged on / under the cover (cleaner ...).

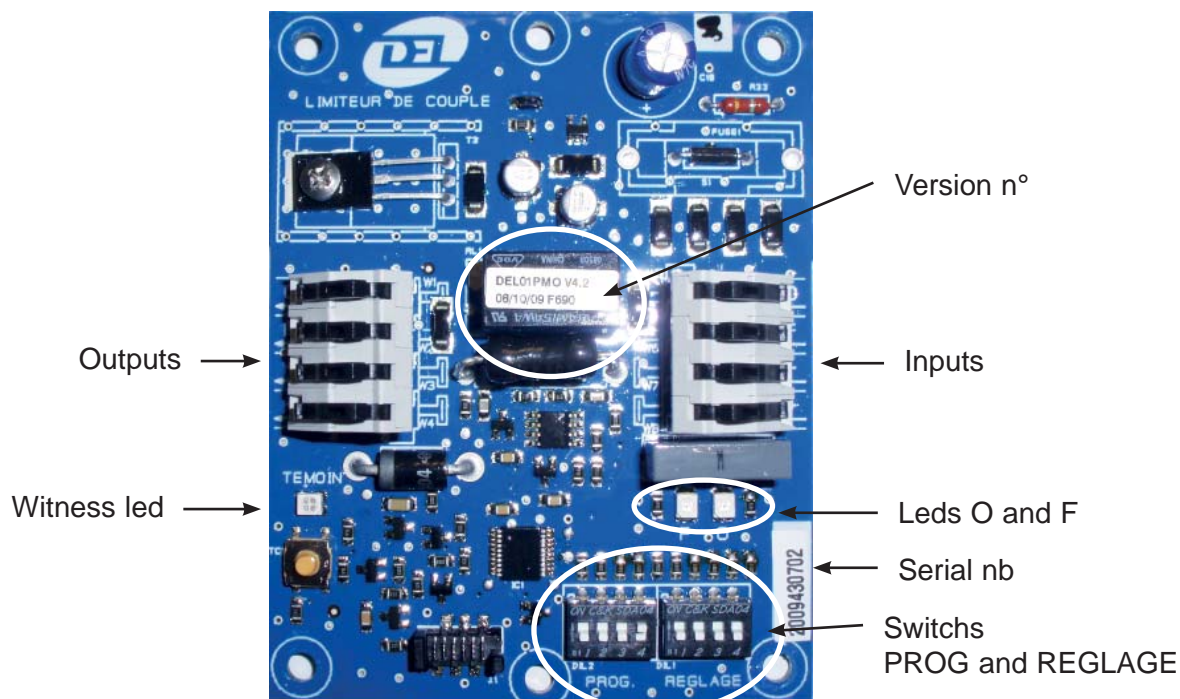

TORQUE LIMITER DEVICE CONTROL CHECKING

- Close the electronic card



(Switch PROG)



- Check:



maintained contact

Pool closure

INDICATORS

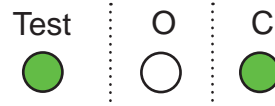

Pool opening

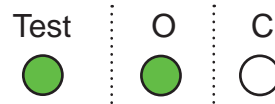

If the key switch is incorrectly wired refer to page 15.

CARD ADJUSTMENT (SWITCH REGLAGE)



CONTROL TIME ADJUSTMENT (SWITCH REGLAGE)

\mathcal{L} = pool length step unit included

$\mathcal{L} \leq 12 \text{ m}$



30 seconds

$\mathcal{L} > 12 \text{ m}$



60 seconds



ADJUSTEMENT OF THE SENSITIVITY (SWITCH PROG)

ℓ = pool width

$\ell \leq 3 \text{ m}$



$\ell \leq 4 \text{ m}$



$\ell \leq 5 \text{ m}$



$\ell \leq 6 \text{ m}$



$\ell \leq 7 \text{ m}$



$\ell \leq 8 \text{ m}$



$\ell \leq 9 \text{ m}$



$\ell \leq 10 \text{ m}$



← maximum sensitivity ————— minimum sensitivity →



ACTIVATION (SWITCH PROG)

Open



If you do not activate the torque limiter device, serious damages might happen on the motor, the electric control box, the slats, and the guarantee might not be applicable.



IMPORTANT

Contact maintained more than 3 secs

=

The next opening will be protected



+ 3 seconds



Contact maintained less than 3 seconds

=

The next opening will not be protected



- 3 seconds

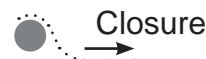

TESTER

A - Block the cover by hand or with safety kits and open the cover.

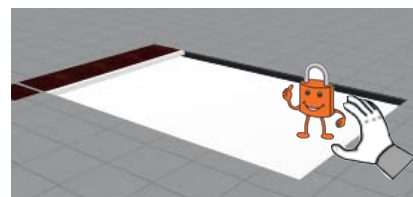

=> The motor is automatically stopped

(If necessary adjust the sensitivity of the switch activation)



in the event of an unexplained activation, reduce the sensitivity level by selecting the setting for the next width up.

Activated card	Witness		O	F
	Opening, control in progress			
	Opening without control			
	Closing			
	Protection ON			

The position of the fastener kits on the cover is indicated on the drawings shipped with the slats.

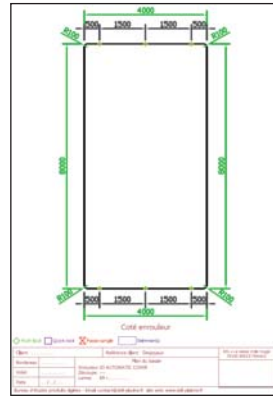

All changes to the positioning of the kits must comply with the rules given below. For other cases please contact us.

30 Positioning rules

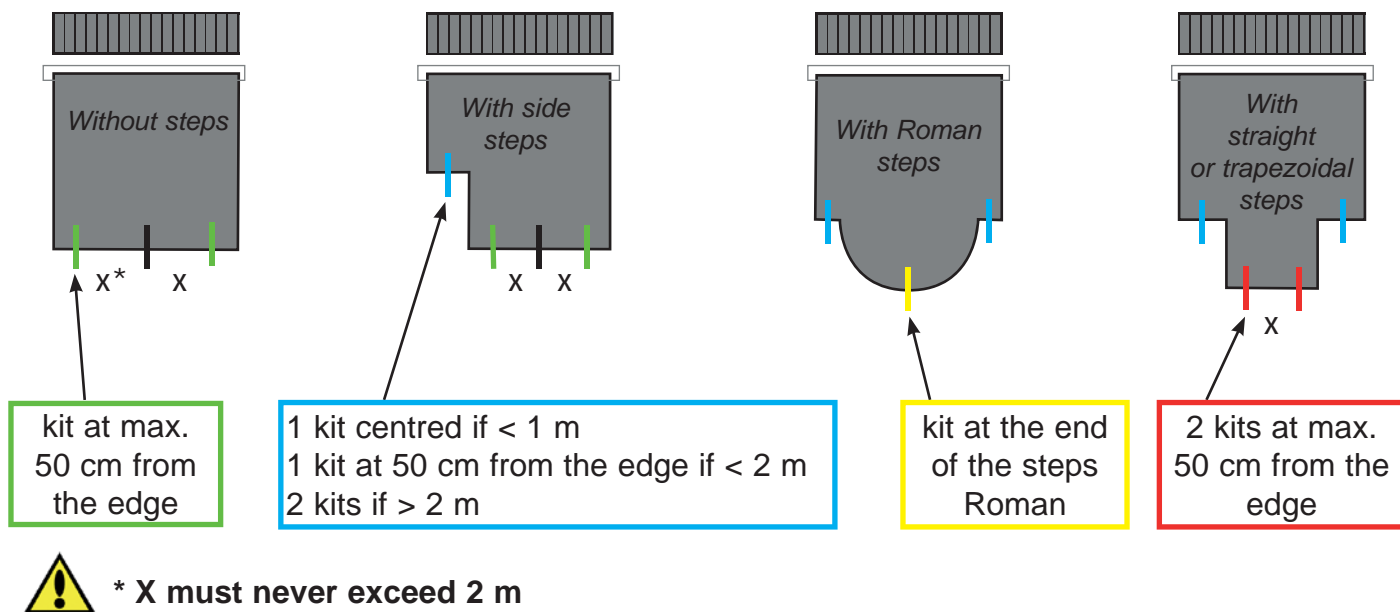

The Quick-lock fastener system cannot be used on cut off corners and curves, except at the end of Roman steps.

A water level regulator is mandatory

Insert mounted model

For concrete and panel pools

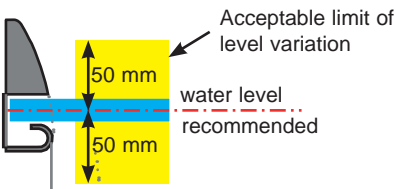
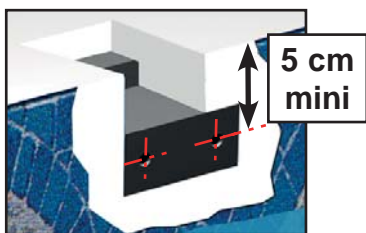

VBA TF Z pozi stainless steel A4 Ø6 x 60 wood screw

Hollow white Ø16 washer

Inserted part

Screw cap

Hang mounted version

For concrete and panel pools

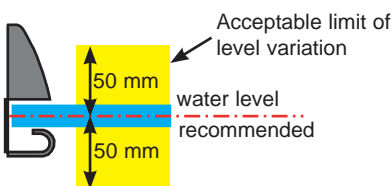
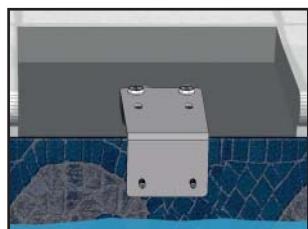

Ø12

VBA TF Z pozi stainless steel A4 Ø6 x 60 wood screw

Hang mount support

Hollow white Ø16 washer

INOX M6 washer

Stainless steel nut A4 M10

Screw cap

Cale 13 mm

Ø12 Nylon plug

Surface mounted model

For concrete and concrete block pools, as well as pools with wall thickness greater than or equal to 8 mm

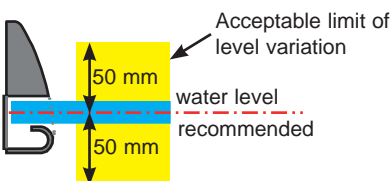
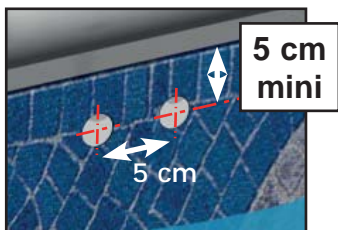

VBA TF Z pozi stainless steel A4 Ø6 x 60 wood screw

Hollow white Ø16 washer

Universal 8 x 40 plug

Screw cap

Concrete

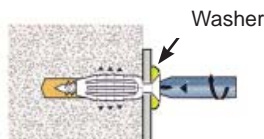

Once the resistance point has been reached stop screwing, this would deteriorate the fixture quality.

Concrete block

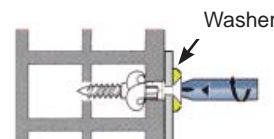

After reaching the resistance point, make 3 more turns of the screwdriver to finish tightening.

INSTALLATION QUICK-LOCK

A water level regulator is mandatory

Insert mounted model

For concrete and panel pools

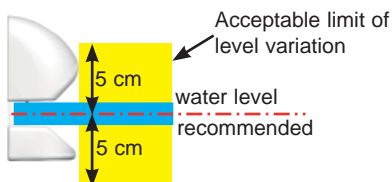
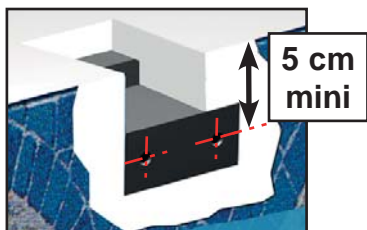

VBA TF Z pozi stainless steel A4 Ø6 x 60 wood screw

Hollow white Ø16 washer

Inserted part

adjustment

Hang mounted version

For concrete and panel pools

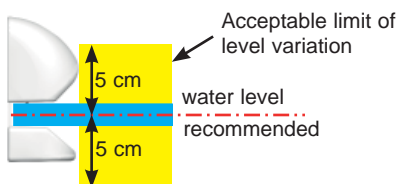
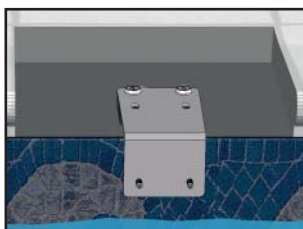

VBA TF Z pozi stainless steel A4 Ø6 x 60 wood screw

Hollow white Ø16 washer

Hang mount support

Inox M6 washer

Stainless steel nut A4 M10

Cale 13 mm

adjustment

Ø12 Nylon plug

Surface mounted model

For concrete and concrete block pools, as well as pools with wall thickness greater than or equal to 8 mm

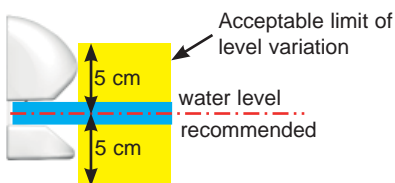
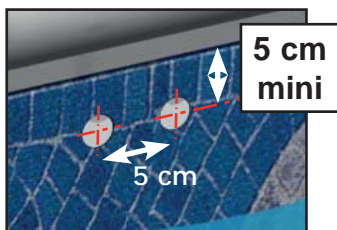

VBA TF Z pozi stainless steel A4 Ø6 x 60 wood screw

Hollow white Ø16 washer

Universal 8 x 40 plugs

adjustment



60 mm "minimum"

Plug

Concrete

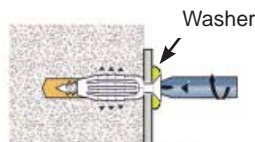

Once the resistance point has been reached stop screwing, this would deteriorate the fixture quality.

Concrete block

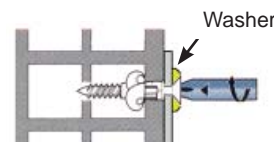

After reaching the resistance point, make 3 more turns of the screwdriver to finish tightening.

A water level regulator is mandatory

Insert mounted model

For concrete and panel pools

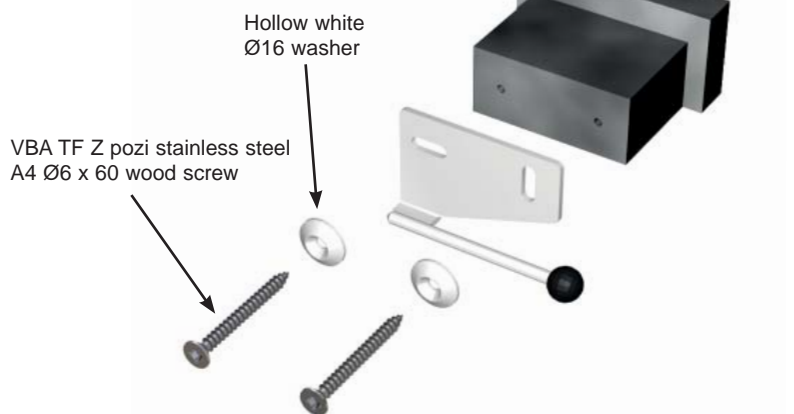
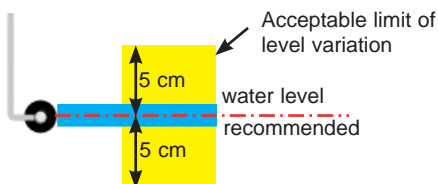
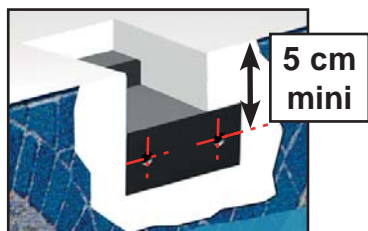

Hang mounted version

For concrete and panel pools

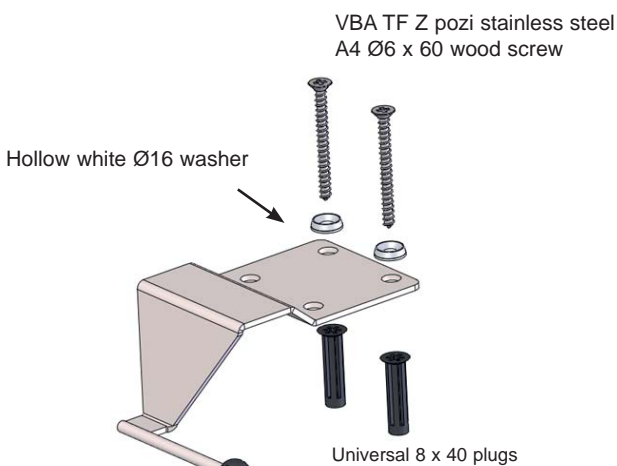
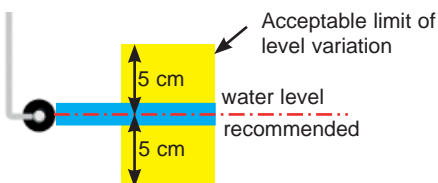

Surface mounted model

For concrete and concrete block pools, as well as pools with wall thickness greater than or equal to 8 mm

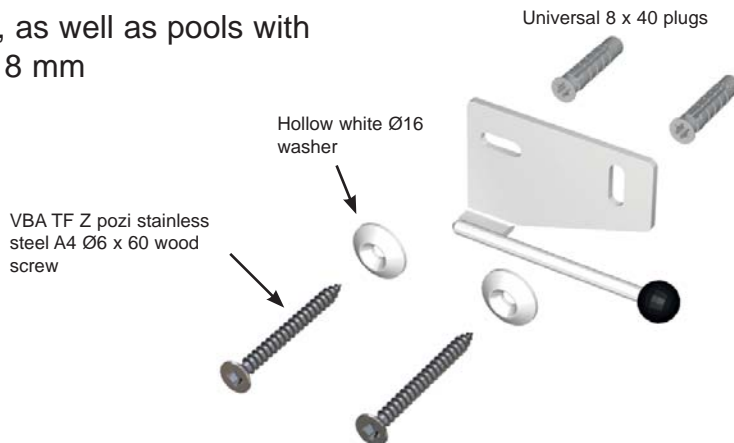
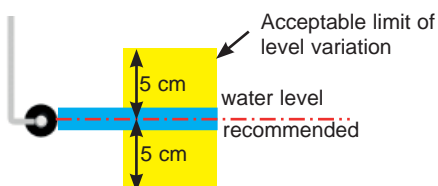
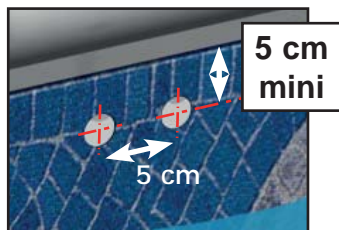

Concrete

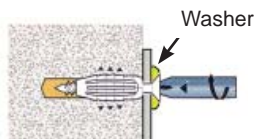

Once the resistance point has been reached stop screwing, this would deteriorate the fixture quality.

Concrete block

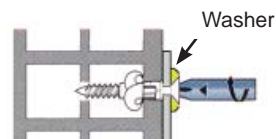

After reaching the resistance point, make 3 more turns of the screwdriver to finish tightening.

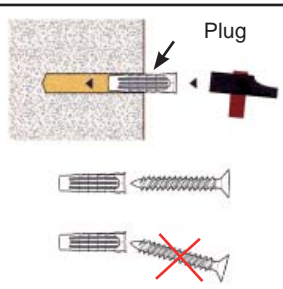

INSTALLATION OF THE STRAP-HOLDER ANCHOR EYEBOLT

Eyebolt for concrete beach



The head of the eyebolt must be higher than the beach surface



Do not force the eyebolt into a drill hole of a smaller diameter than this

Eyebolt for wooden beach



Cruciform
Ø4 x 25



depth : 4,5 cm

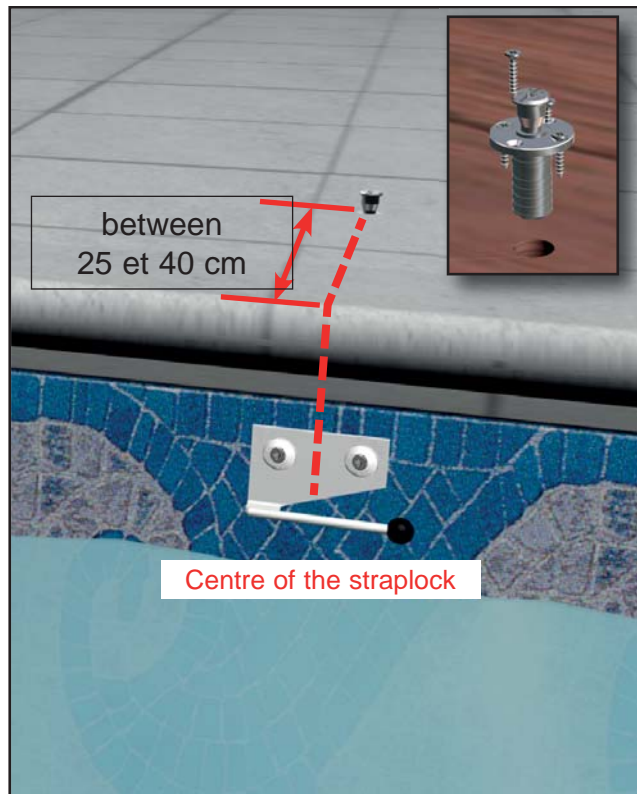

INSTALLATION OF THE STRAPLOCK STRAP

single strap



double strap



or

+

+

+

Protective
sheath



loop



staple

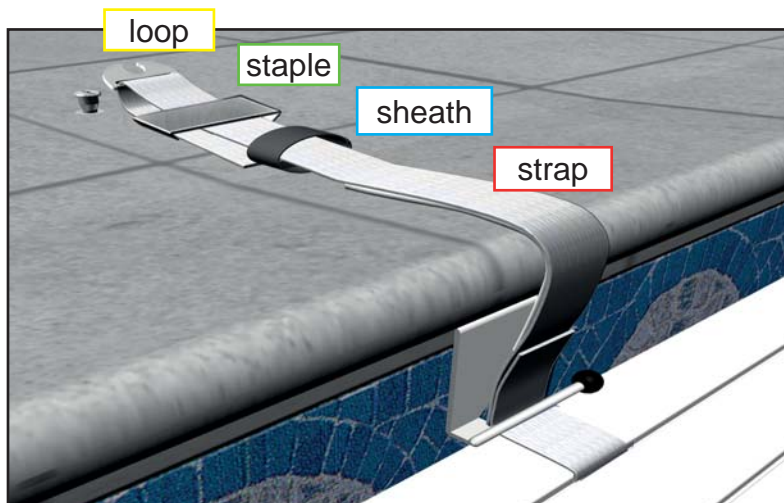

Stretch the strap
the cover must touch the underside of the straplock

Place the strap in position after the loop and crimp
the 2 strap thicknesses pass inside the stable

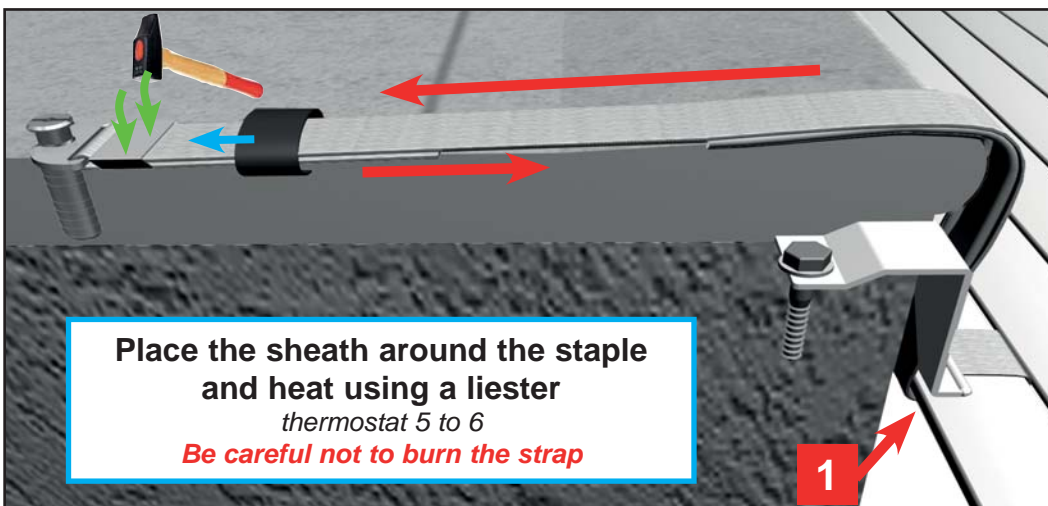

Place the sheath around the staple and heat using a liester thermostat 5 to 6
Be careful not to burn the strap

1

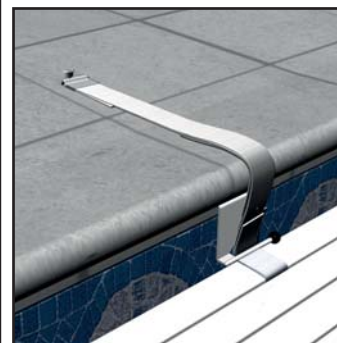

OPENING/ CLOSURE OF THE POOL

**ALWAYS KEEP AN EYE ON THE POOL DURING OPENING OR CLOSING OPERATIONS.
ALWAYS CHECK THAT THE POOL WATER LEVEL IS CONSTANT AND COMPLIANT WITH THE
RECOMMENDATIONS ON THE INSTRUCTIONS**

- It is imperative not to halt the cover in an intermediate position, this can cause the risk of jamming a bather's body under the cover casing, if a bather uses the pool.
- When using an automatic cleaner under the cover, check that the hose does not affect the movement of the slats when opening and closing the cover.
- It is essential to remove floating objects when opening and closing the cover.
- Do not block the cover while extending or retracting.
- Do not activate the automatic cover when it is iced in.
- The opening or closure operation requires about 2 minutes for one person and about 3 minutes to lock or unlock the attachment kits.

Opening: Always release the cover before starting the motor.

- Unlock all the fastening systems.
- Operate the open control.
- Stow the unlocking tools out of the reach of children.
- Lock the WI-Key command



Closure:

- Operate the «contact maintained during closure» close control
- Lock all the fastener systems.
- Stow the unlocking tools out of the reach of children.
- Lock the WI-Key command



IMPORTANT

36

When closing the pool, it is essential to **KEEP THE CONTROL PRESSED FOR AT LEAST 3 SECONDS**. This is required to guarantee automatic obstacle detection the next time the cover is opened.



LOCKING THE WI-KEY

- Press on  for more than 3 seconds until the pilot flashes





= system locked

UNLOCKING THE WI-KEY

- Press  and keep it pressed.
- At the same time: successively press the following 3 keys: :



- The pilot  remains on  = emitter unlocked

LIGHT INDICATORS

When you press a key, the light indicators below provide information on the Wi-key status (locked/unlocked), as well as the battery charge level.

	Green LED	----->	Wi-key unlocked
	Red/green flashing LED	----->	Wi-key locked
	Orange LED	----->	Battery level low
	Red LED	----->	Change the batteries (2 x LR03)

LOCKING AND RELEASING PUSH-LOCK

Locking

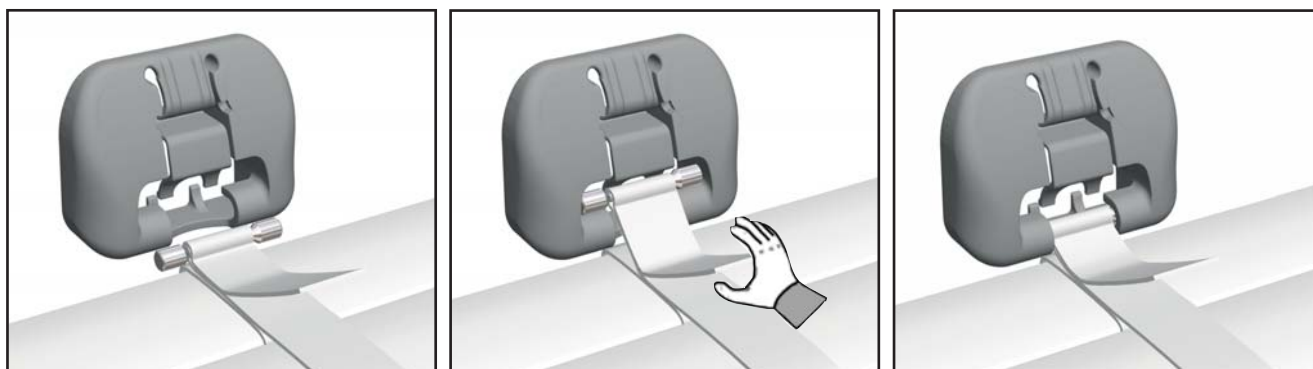

Releasing

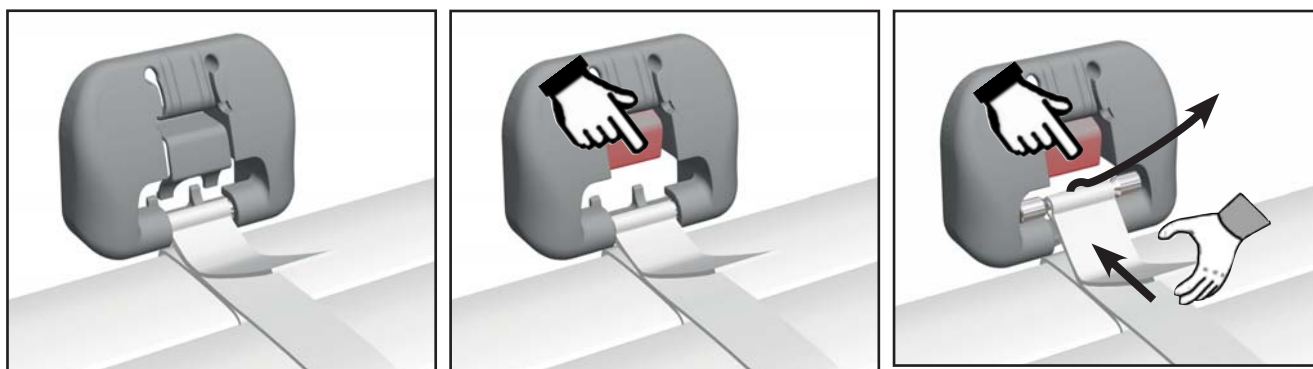

LOCKING AND RELEASING QUICK-LOCK

Locking

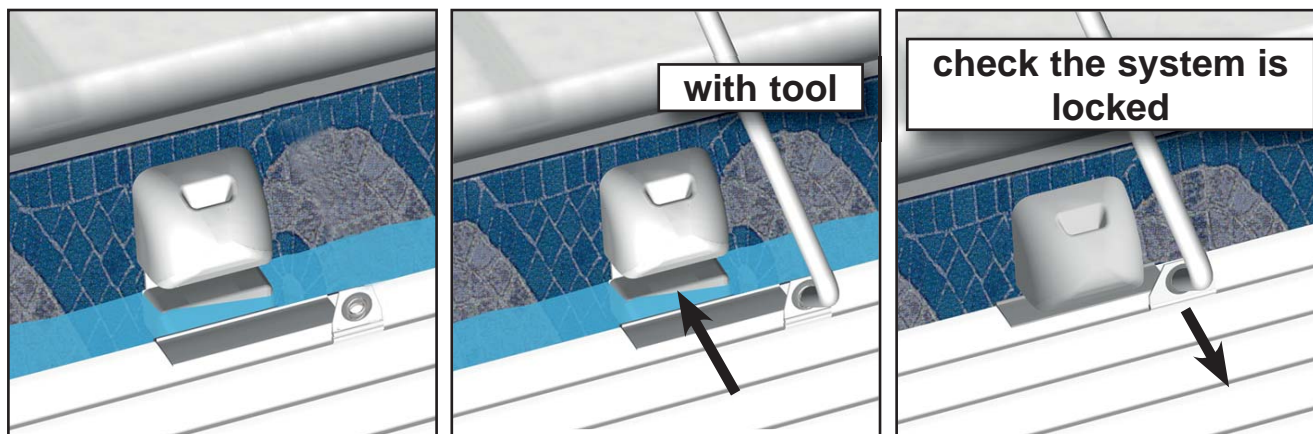

Releasing

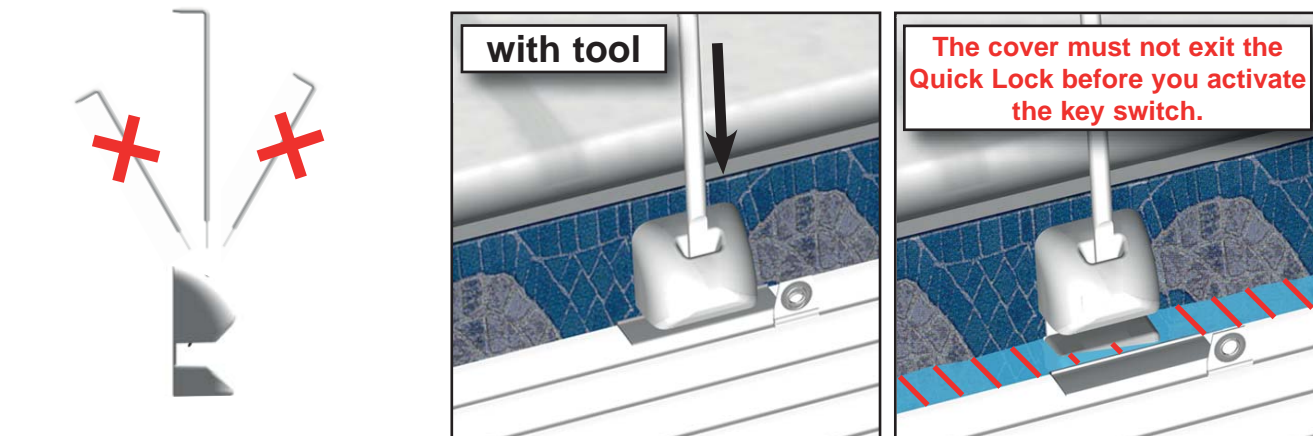

Locking

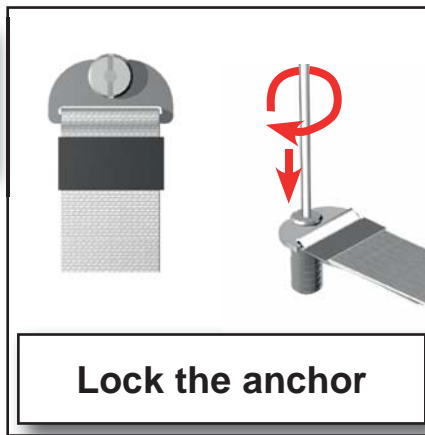
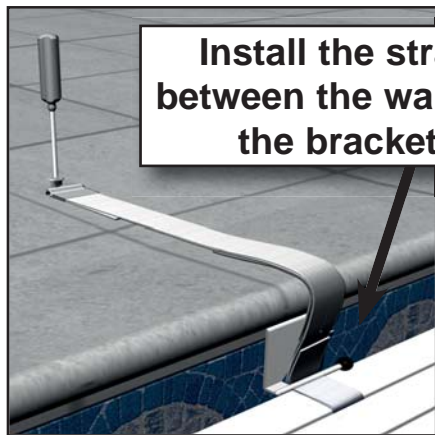

The strap must be under tension and must be through the bracket

Releasing

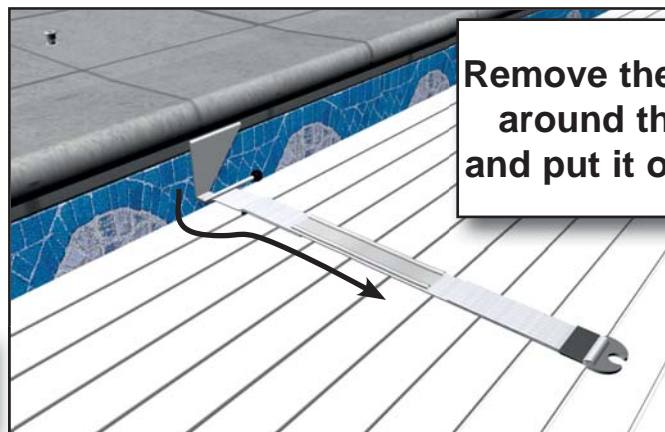
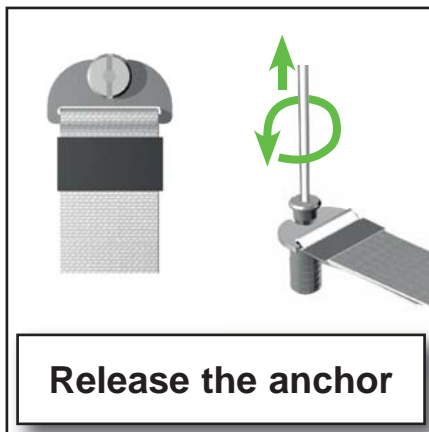

WHAT TO DO IF THE SYSTEM STOPS DURING THE OPENING (TORQUE LIMITER ACTIVATED)

- 1 - In the event of an explained stoppage during opening : (unreleased locking kits or other...)
- Closed the cover **for more than 3 seconds**, until the tension of the cover is completely released.
(closed the cover for more than 3 seconds until the tension of the cover is completely released)
 - Remove causes of stoppage, e.g. release locking kits and open the pool again.

2 - In the event of an unexplained stoppage :

- closer the cover **between 1 and 3 seconds**.
(The next opening will not be protected by the system)
- open the pool again.

If there are repeated activations, decease the sensitivity level..
- modify the ajustement if the sensitivity.(see page 19)

If you do not activate the torque limiter device, serious damages might happen on the motor, the electric control box, the slats, and the guarantee might not be applicable.

LED MEANING (TORQUE LIMITEUR DEVICE)

Activated card	Temlion			Desactivated card	Temlion			Flashing LED
	Opening, control in progress				Opening			
	Opening without control				Closing			
	Closing							
	Protection ON							
								Permanent LED

LED MEANING (CONROL BOX)

	Flashing LED		Permanent LED		Flashing LED		Permanent LED
--	--------------	--	---------------	--	--------------	--	---------------

CAPTEUR	Initialisation <i>LED flash alternatively</i>	
DEFAUTS		
CAPTEUR	The motor is on <i>Regular slow flashing</i>	
DEFAUTS		
CAPTEUR	Captor default (check connections and cables) <i>Permanent LED</i>	
DEFAUTS		
CAPTEUR	Electronical default (check connections and cables / back to the factory) <i>Fast flashing</i>	
DEFAUTS		
CAPTEUR	Software Default (readjust automatic stop) <i>Permanent LED</i>	
DEFAUTS		

WATER LEVEL OF THE POOL

The water level has to be maintained at the correct level to avoid damage and repeated activation of the torque limiter device. (For more comfort, use a water level regulator).

- If the water level is too high, it might come from leaves in the skimmer.
- If the water level is too low, it might cause malfunction of the cover.
- In case of hand rails, the pool must be equipped with a water level.

FILTRATION

- The filtration must run continuously as soon as the water reaches 25°C, to avoid excessive heat under the slats.

- Clean your cover fully twice a year (start of season and start of winter). This is even more important if you have hard water. If this is the case, use a high pressure cleaner with warm water and a descaling product.
- Take the same care to clean the locking systems regularly. (Where fitted).
- It is advisable to inspect the whole system, in the event of abnormal force on the cover (eg. somebody falling)
- Check the straps connecting the cover to the roller / tube.
- Apply twice a year a «wood saturator or a treatment oil» (see catalogue DEL), on IPE and beech deckings.

MAINTENANCE

- All work must be carried out by your installer who will contact the manufacturer if necessary.
- All spare parts must be originals.
- Inspect the whole cover for damage/wear and tear.
- It is necessary to check at the start of every season and in the case of possible accidents that the slats have not been visibly damaged in such a way as to affect the cover's operation (slats with cracks, holes, deformations, etc.). Change the slats or the whole cover if necessary.
- In both summer and winter, do not cover the slats with a debris winter cover. There is a risk of damage due to excess heat.
- Check the straps (sewing) and the anti-abrasion sheath. Replace the strap or sheath if necessary.
- Once a year, check the electrical connections.
- The «witness « flashes RED = change the control box battery

WINTER

Close the cover and prepare the pool for winter, without lowering the water level. If you need to lower the water level, reel-in the cover around the tube and use a winter cover.

Pairing -- delivered pre-paired

1 receiver

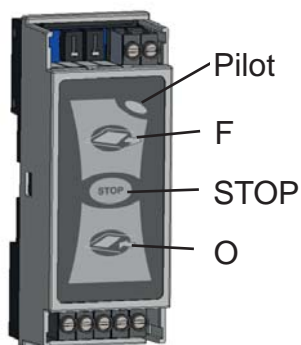

Press «STOP» and, without releasing it, press «O» for more than 3 seconds
OK when the «pilot» flashes green.

an emitter must be paired within the next 30 seconds.

2 emitter

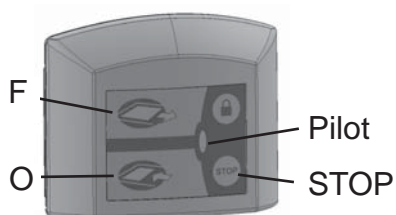

Press «STOP» and, without releasing it, press «O» for more than 3 seconds
OK when the «pilot» flashes red / green.

another emitter must be paired within the next 30 seconds.

Replacing the batteries

42



Be careful of the seal when re-assembling

	Receiver	Emitter	
Manufacturer	DEL	DEL	
Reference	Wikey receiver	Wikey emitter	
Category	3 (EN 300220-1)	3 (EN 300220-1)	
Range	50m in an obstacle-free zone	50m in a free zone	
	25m through a concrete wall	25m through a concrete wall	
Power supply	12 to 48 VDC 30mA max	Two 1.5V AAA batteries	
Protection index	< IP40	< IP54	

Winterizing of the pool and keeping the pool in safety position.

