

AUTOMATIC ABOVE-GROUND COVER

# RollOver

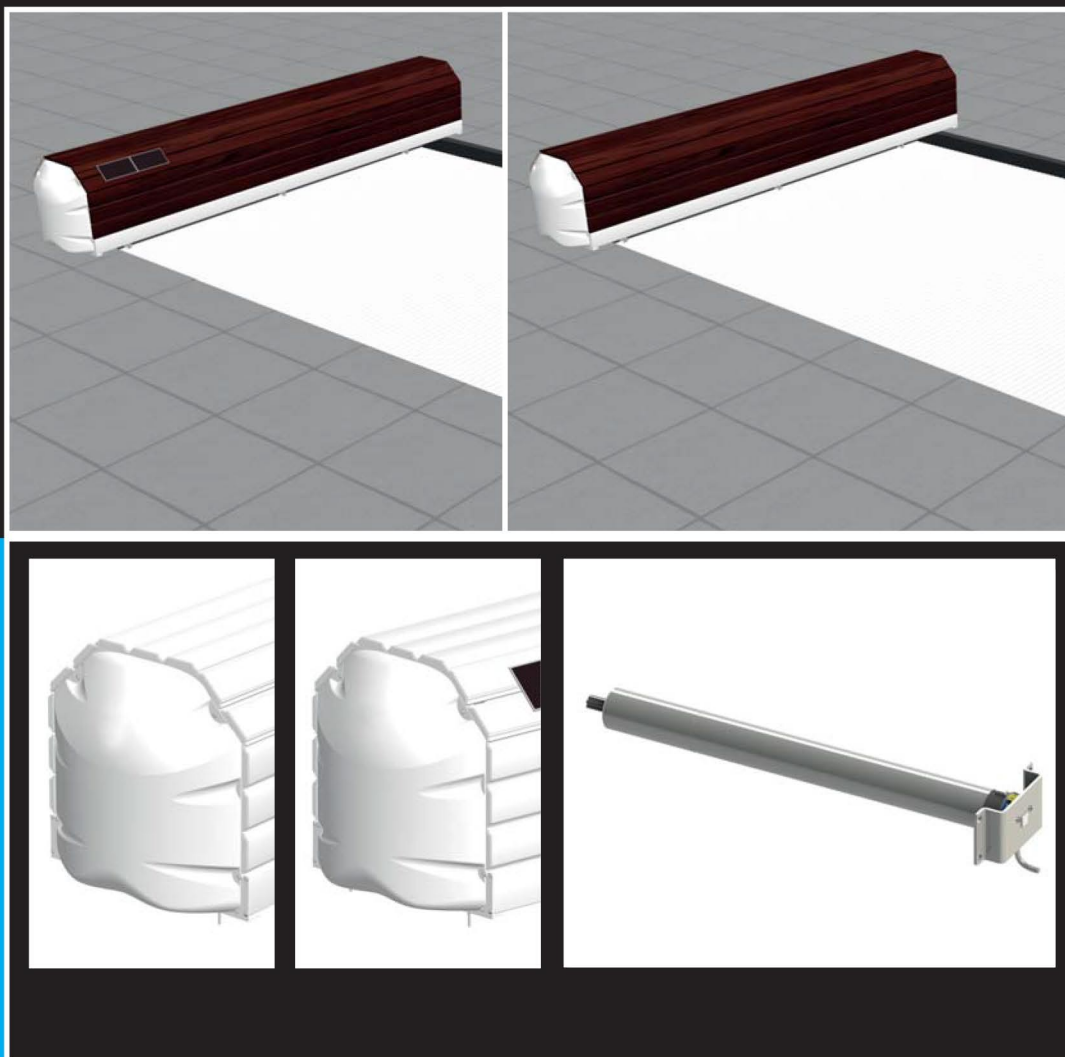

## TECHNICAL INSTRUCTIONS

Installation / Use / Cleaning / Maintenance / Safety advice

**THIS NOTICE MUST BE GIVEN TO THE POOL OWNER  
PLEASE READ CAREFULLY AND KEEP IN A SAFE PLACE**

## PARTS INCLUDED IN THE DELIVERY

### Roll-Over (1 box)

Version électrique  
le sachet de pièces détachées,  
se trouvent dans le caisson côté  
moteur

Version solaire  
les batteries,  
le chargeur batterie et  
le sachet de pièces détachées,  
se trouvent dans le caisson  
côté moteur



**x1**



Battery  
charger

**x1**



Tubular motor

OPTION **x1**



Wi-key

Sleeve  
Ø12  
**x4**



White cap



Allen key  
n°4  
**x1**



Screw  
M10x60  
**x4**



Washer  
M10  
**x4**



Key  
(for automatic  
stops)  
**x1**



Spare parts bag

2



Electrical control panel

**Slats** (model, colour and number of boxes  
according to your order)



### OPTION - Safety locking kit

"according to your order" (1 box)



Quick-Lock



Strap locking kit



Push-lock

3 fitting models : surface mounted -  
Insert mounted - Hanging mounted

## PACKING LIST

**example - for a 5 x 10 m pool with Ø3 m step unit**

Roll-Over Carrare : 1 box of 0.80 x 0.80 x 5.65 --- 165 Kg

Roll-Over Premium : 1 box of 0.80 x 0.80 x 5.65 --- 300 Kg



Slats : 5 box of 5 x 0.25 x 0.20 m --- 250 Kg

## NECESSARY TOOLS - (INSTALLATION - 2 PERSONS)



## INFORMATION

For pools up to 6 x 14 m + Ø4 m step unit

The motor is located in the tube and must be installed on the support.

The power supply is either:

solar Version: 2 batteries.

They are charged by photovoltaic panels.

Electric version: by an electrical box located in a technical room

Le réglage des fins de course se fait directement sur le moteur.

Automatic stops are adjusted directly on the motor.

A torque limiter device protects the system in case of any excessive resistance to the covers operation.

The cover is made of watertight PVC slats that float on the water.



## THE ABOVE GROUND COVER

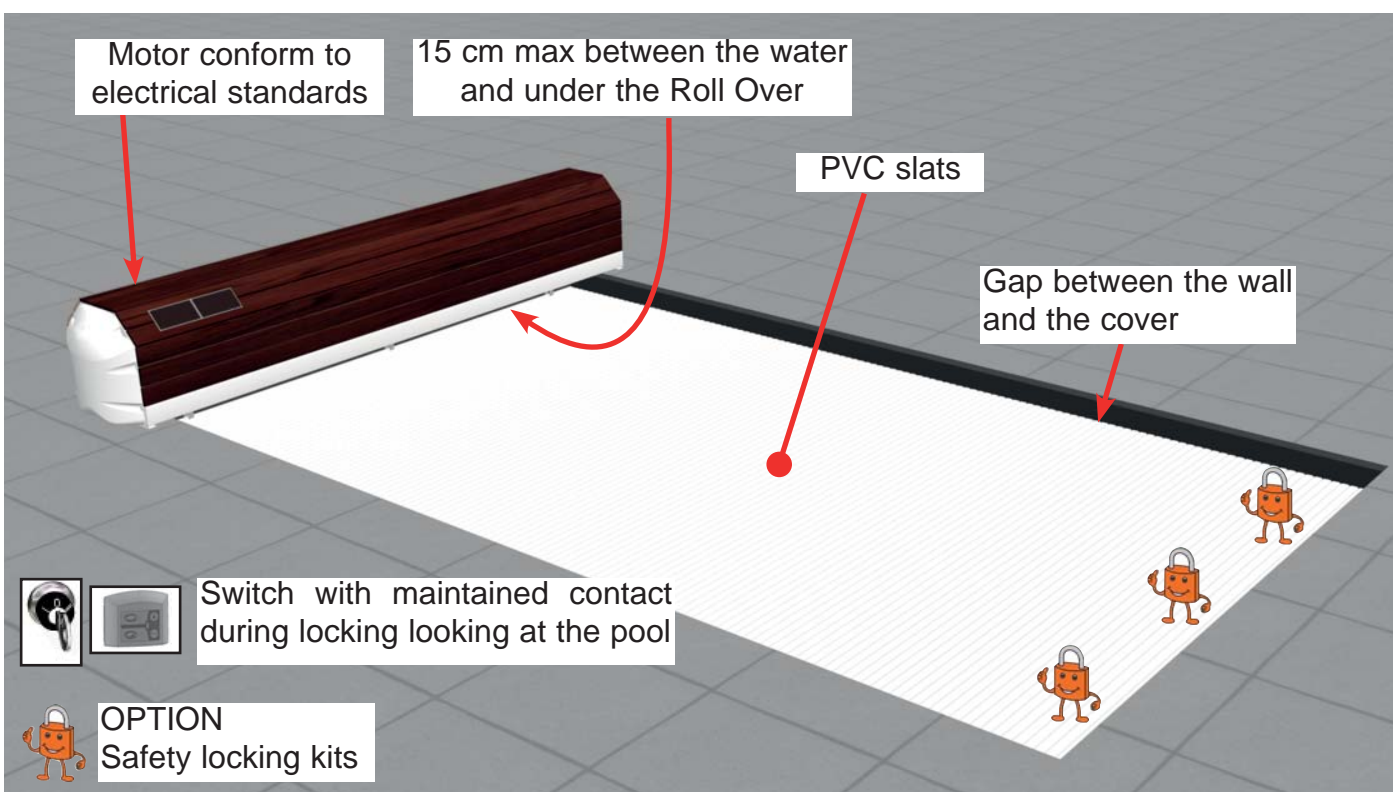

## LOCATE THE ROLLER HOUSING

Locate the motor side support as per your order.

The support with the solar panels should be installed on the side of the pool where the amount of direct light is greatest.

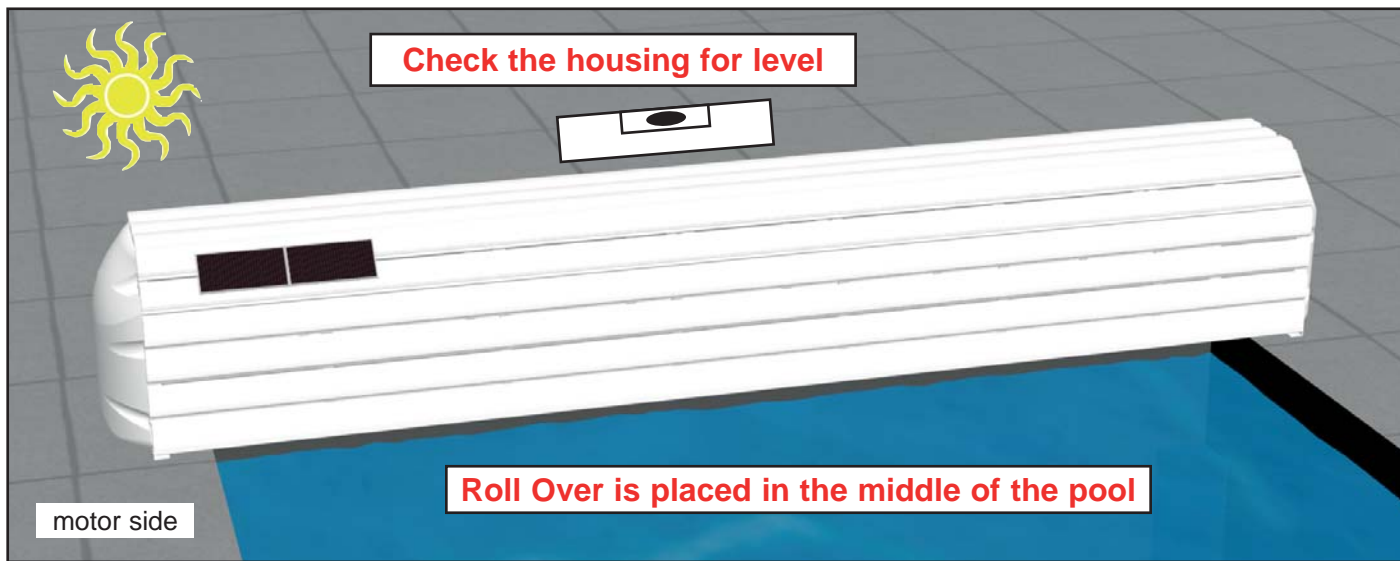

## Tube adjustment

4

### Straight radius

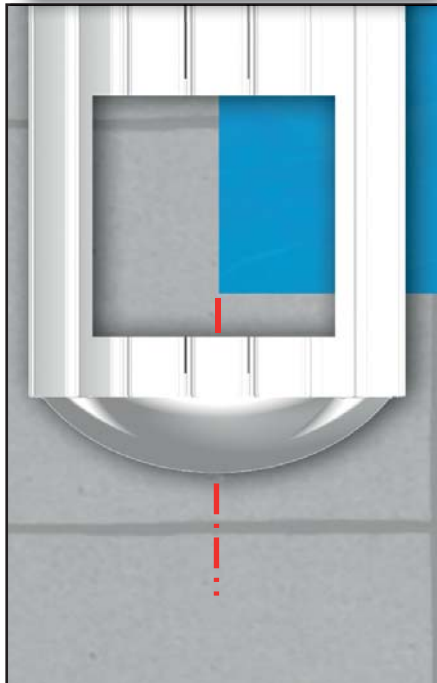

### Radius Cut sides

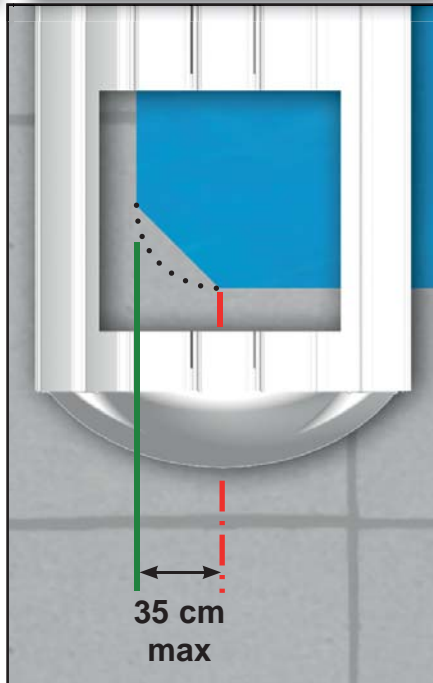

Allow an access to the skimmers

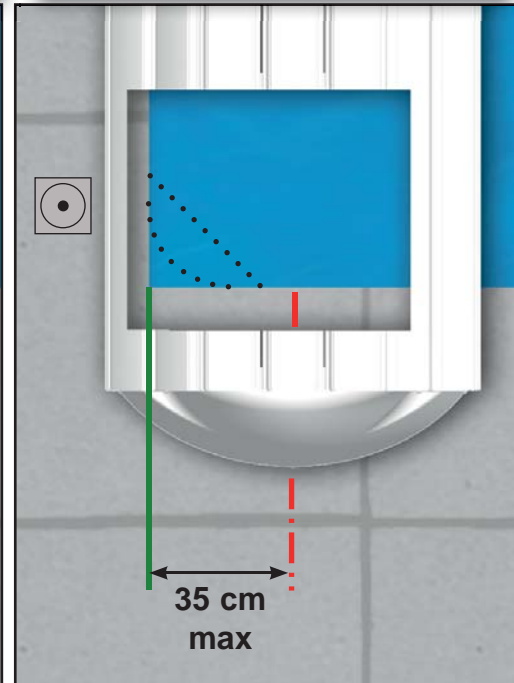

## WATER LEVEL REQUIRED

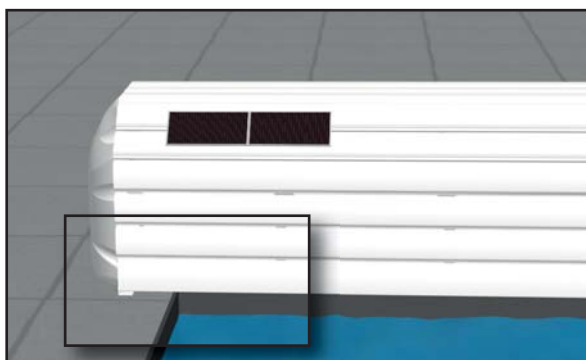



## HOW TO TAKE OFF BENCH SLATS

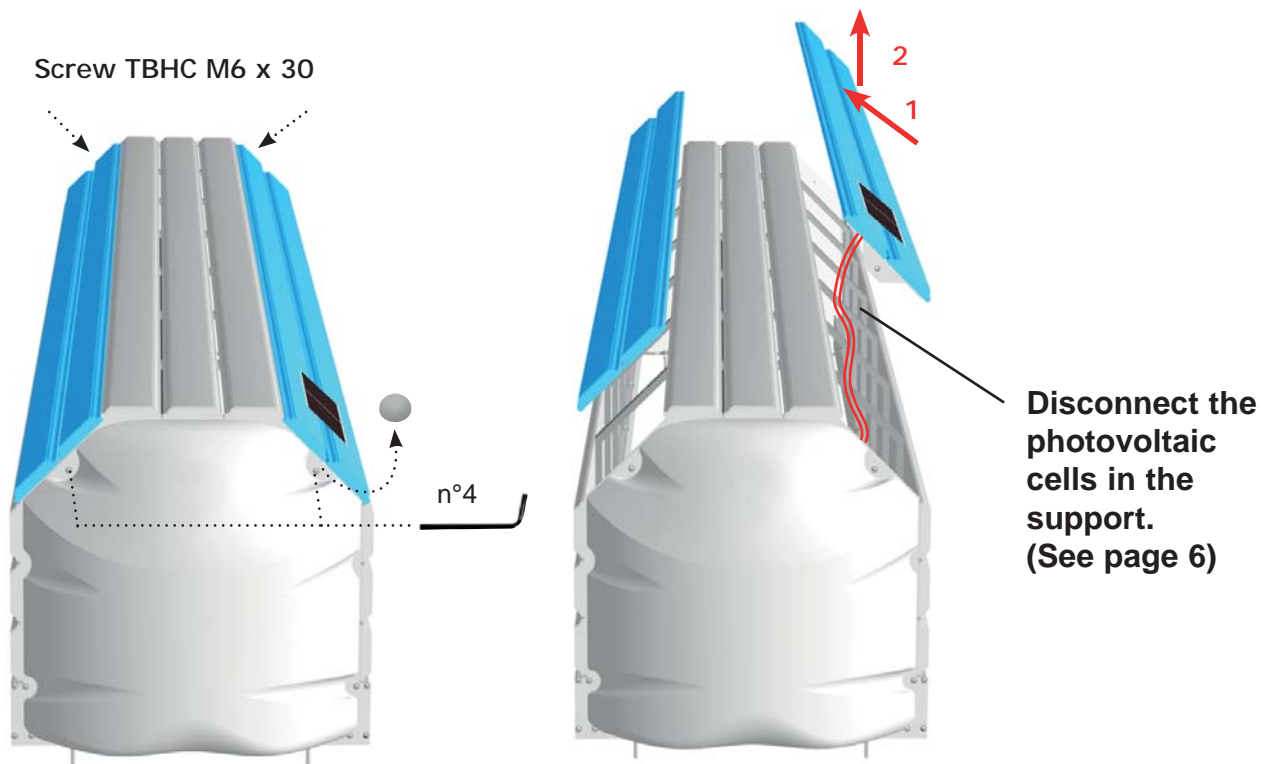

## SETTLEMENT



## HOW TO RE-FIX ON BENCH SLATS

Place the bench slat in front of the Roll Over

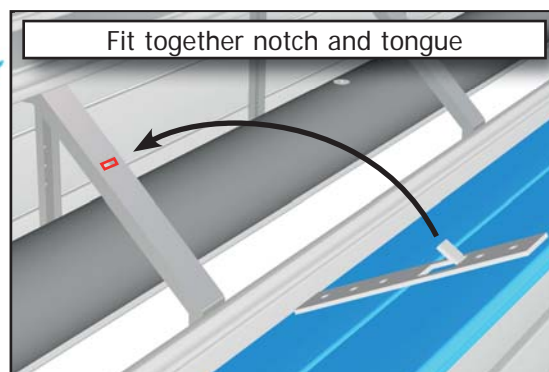

Screw TBHC M6 x 30  
+ washer  
+ cap

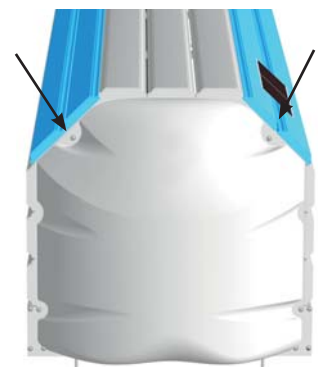

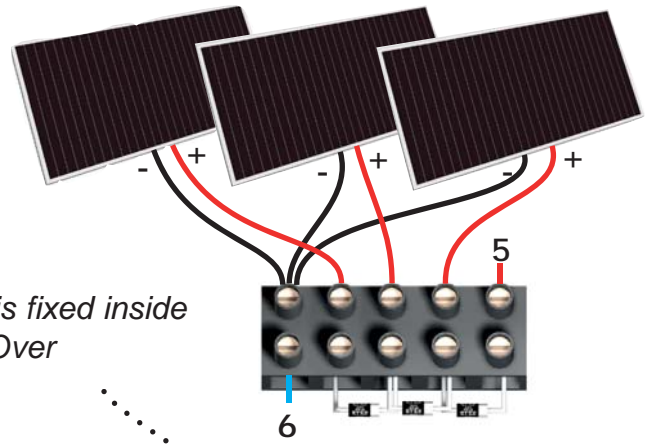
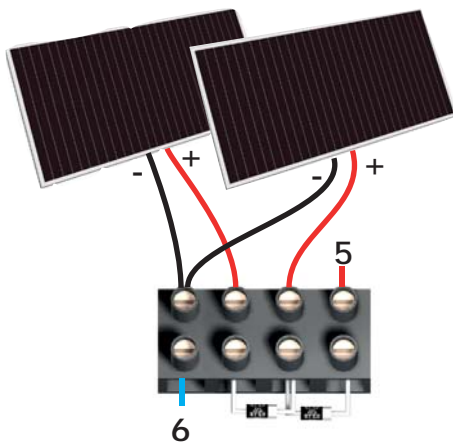

The captor's plug is fixed inside the Roll Over

6

Disconnect the plug before taking off the bench slat

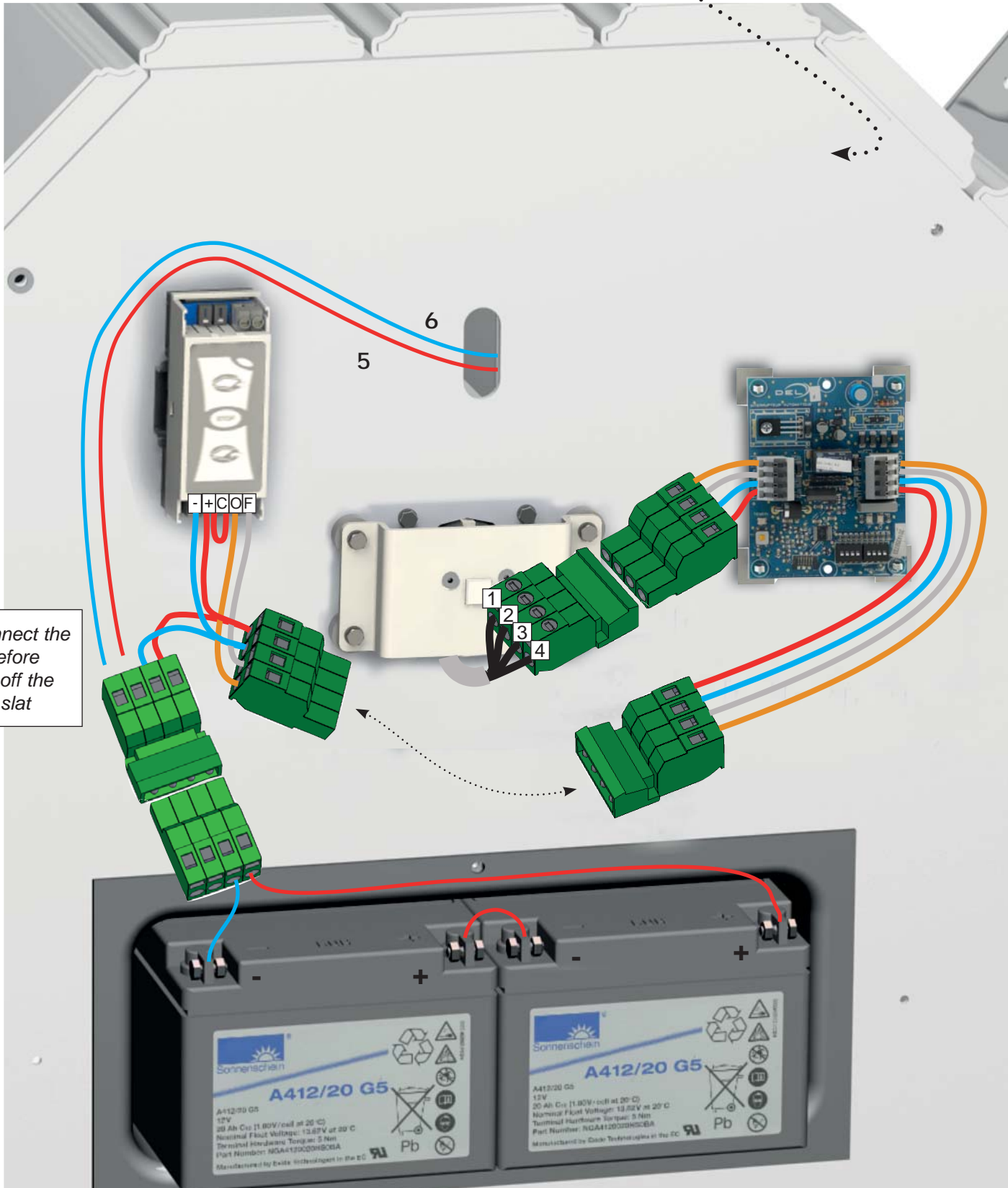

The electric control box must be fitted in a dry room.

The installation must comply with the NF C15-100 standard. et CEI 60364

(Last applicable version) ask your electrician for advice or contact your electricity provider.

All our control boxes use a 230 Volt single phase (50Hz) power supply.

The required power at the input terminals is 0.15 Kw.

Upstream from the control box a suitably sized circuit breaker with a 30 mA ground fault device must be provided.

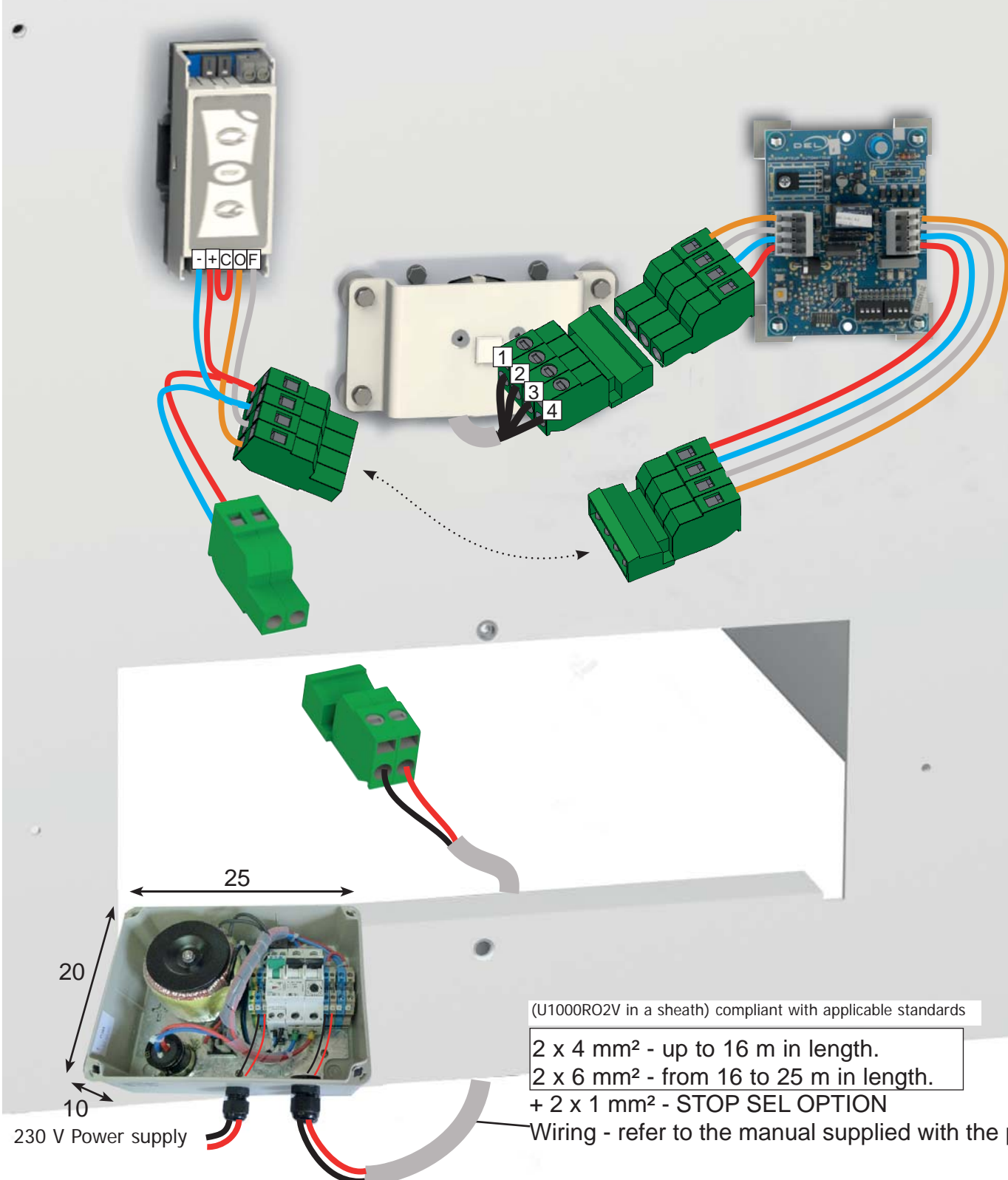

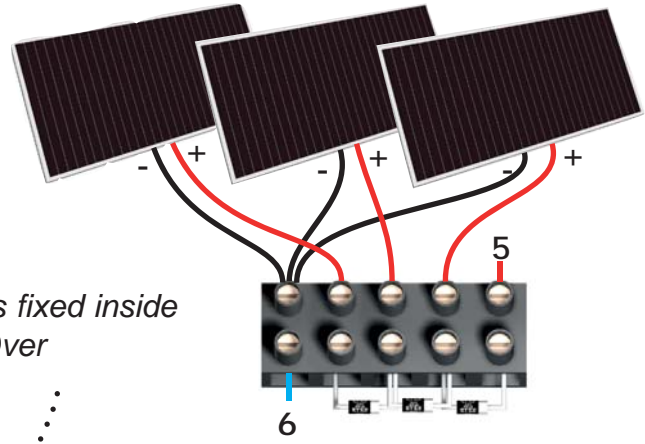
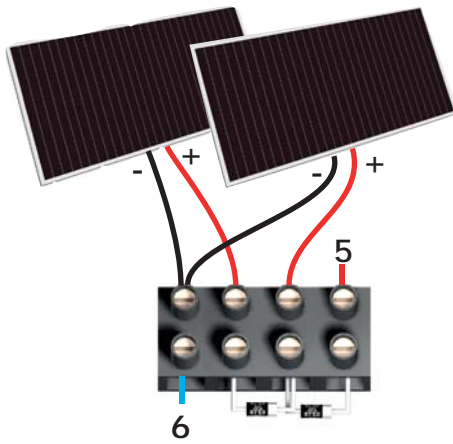

The captor's plug is fixed inside the Roll Over

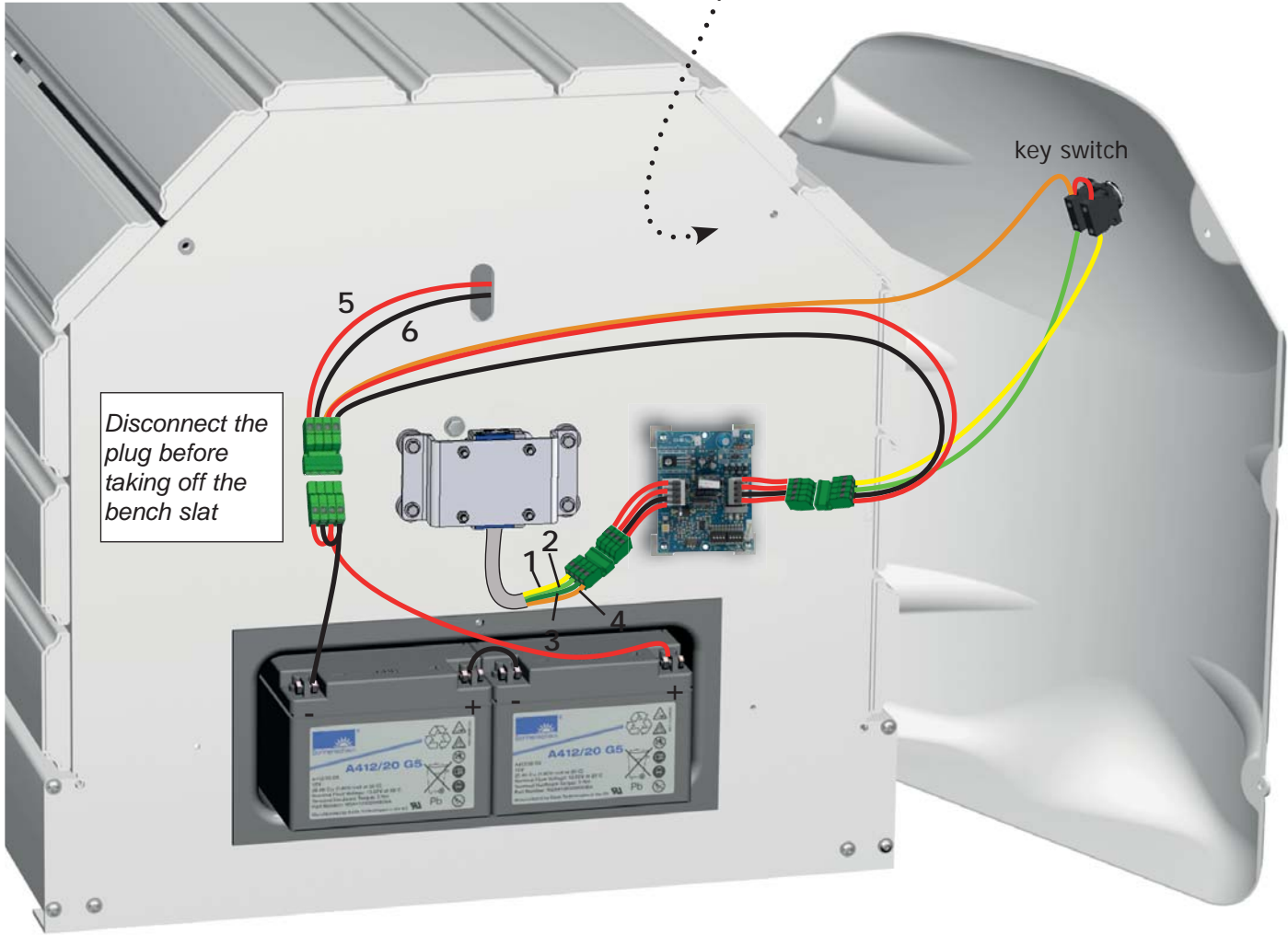



The electric control box must be fitted in a dry room.

The installation must comply with the NF C15-100 standard, and CEI 60364

(Last applicable version) ask your electrician for advice or contact your electricity provider.

All our control boxes use a 230 Volt single phase (50Hz) power supply.

The required power at the input terminals is 0.15 Kw.

Upstream from the control box a suitably sized circuit breaker with a 30 mA ground fault device must be provided.

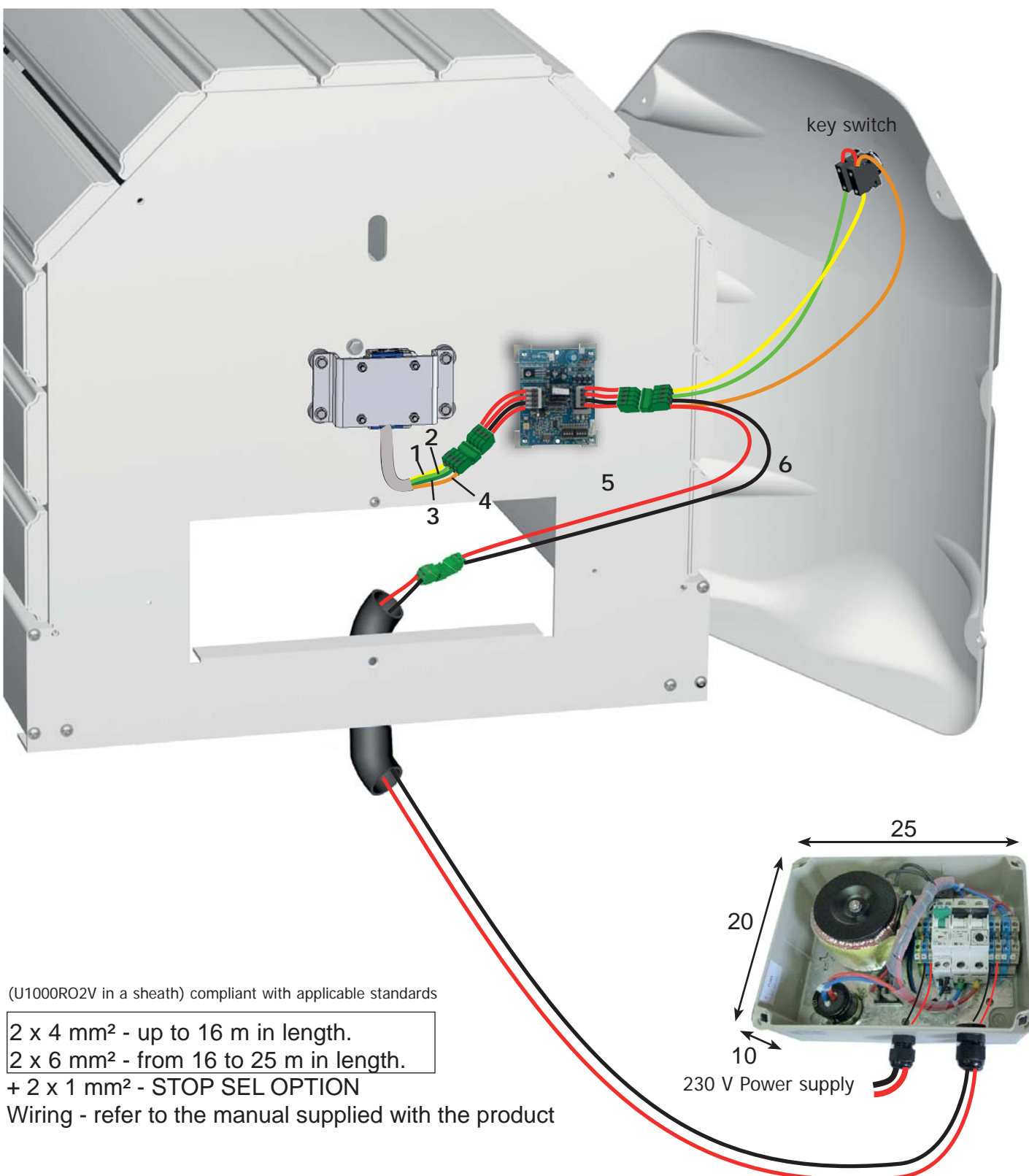

(U1000RO2V in a sheath) compliant with applicable standards

2 x 4 mm<sup>2</sup> - up to 16 m in length.

2 x 6 mm<sup>2</sup> - from 16 to 25 m in length.

+ 2 x 1 mm<sup>2</sup> - STOP SEL OPTION

Wiring - refer to the manual supplied with the product

## COVER INSTALLATION

Make sure the slats are in the right direction

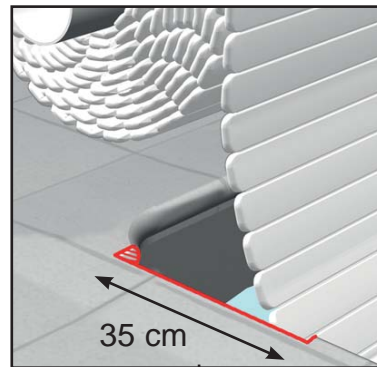
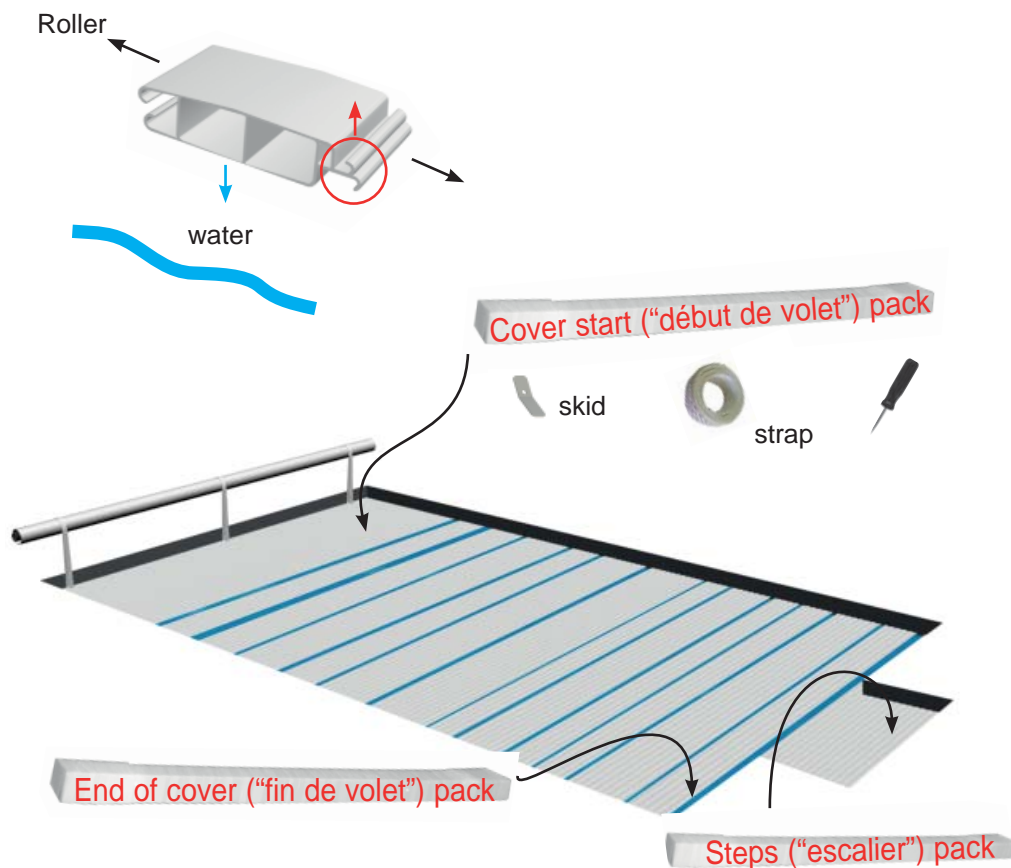

*If necessary, cut the sides to ease the passage of the cover and avoid rubbing*

## Slat assembly

By clipping

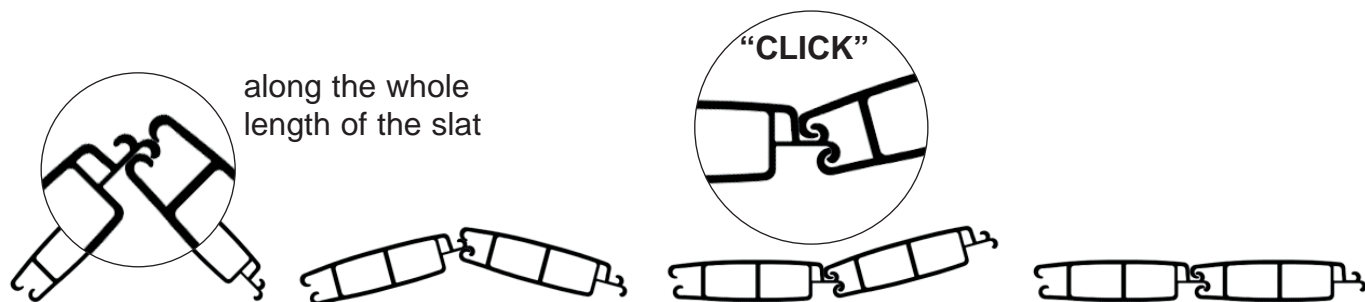

Repeat the movement until all the slats are completely clipped together

By sliding

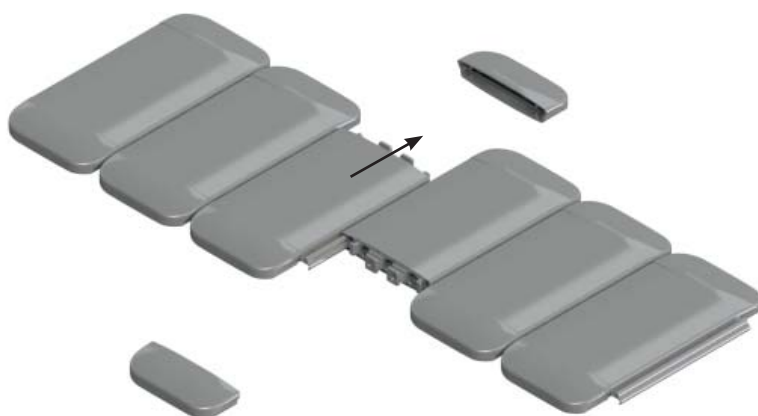

remove the cap

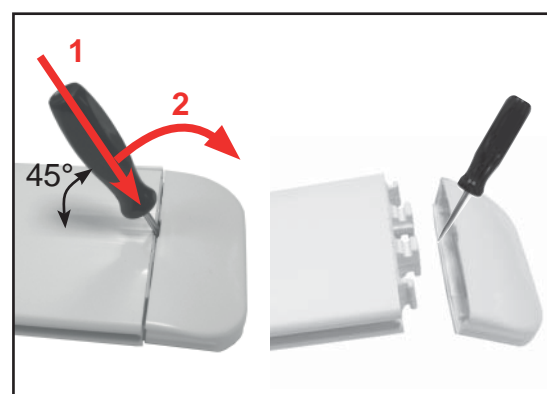

## Assembly of the strap between the cover and the tube

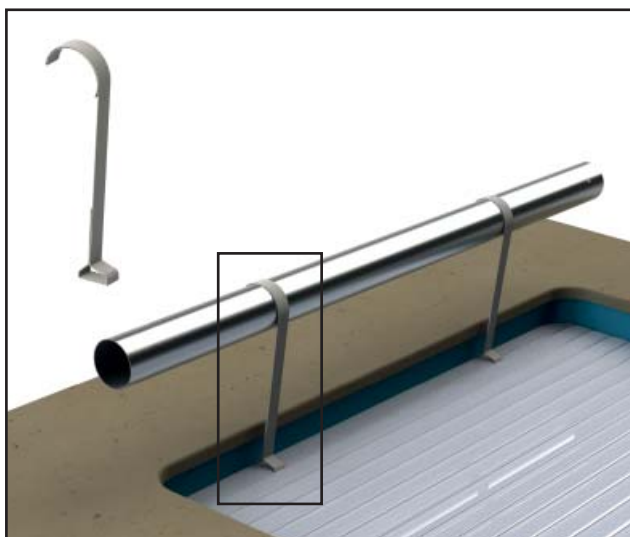

The surface to be glued must be clean and dry

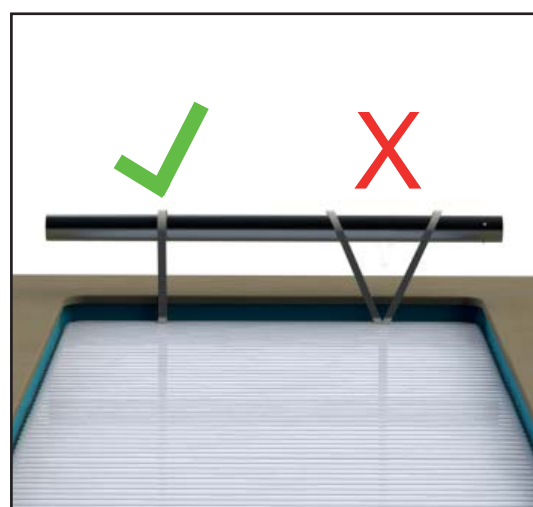
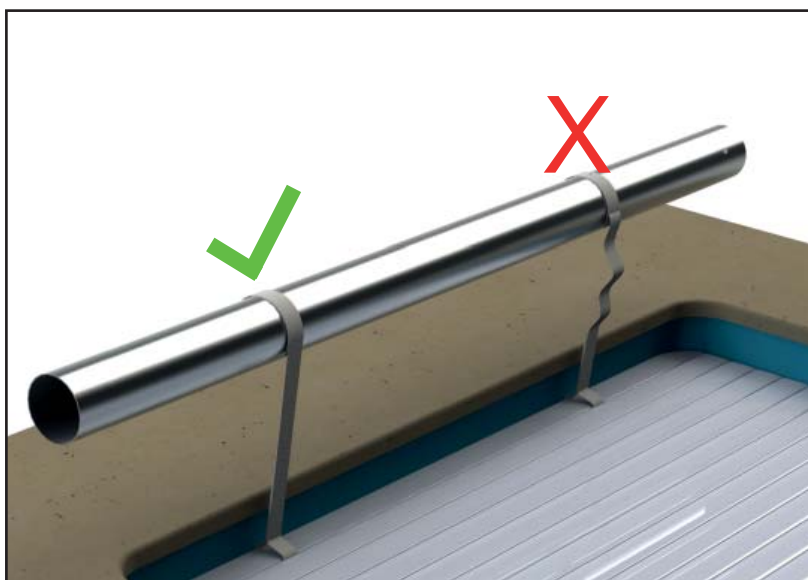

In order to guarantee quality fixing, the adhesive Velcro temperature must be higher than 15°C (if necessary leave it in a warm room before application).

## skid assembly



The skids are used to orient the cover at the start of closure.  
The holes are drilled at the factory.

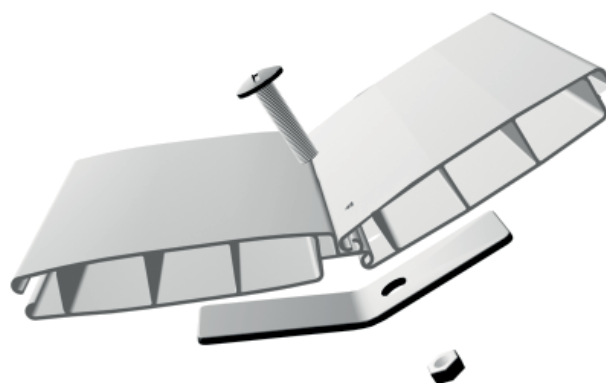
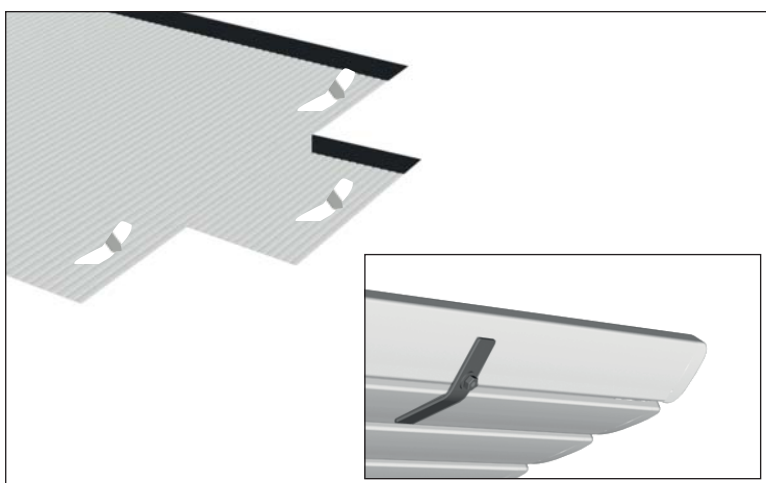

## WI-KEY INSTALLING THE CONTROL BOX



red / green flashing = emitter locked  
 Emitter unlocking procedure see «page 21»

The emitter must be located outside volume 0.  
 The distance between the emitter and the receiver must not exceed:

- 50 m in an obstacle-free zone.
- 25 m behind a basic wall.
- 15 m behind several walls or an especially thick wall.

We recommend checking emitter/receiver communication before fixing permanently.

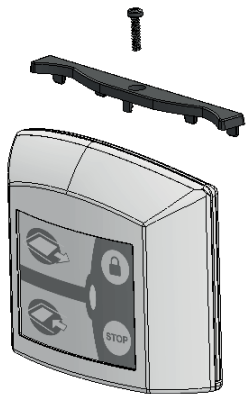

- It must be located in a place from which it is possible to check that no one enters the pool during the manoeuvre.
- It is mandatory to install the locking «strip».
- Before fixing the control box, check that the emitter is communicating with the receiver.

”if the motor does not run => check the power supply polarity

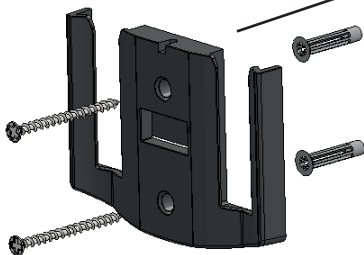

The support must be attached to a fixed support



Closing



Opening



Keyboard lock



Stops the current action



## Checking the order logic



Contact maintained

### Pool closure



If the command logic is not correct, reverse wires 1 and 2 on the motor output. (see wiring diagram)



### Pool opening



## Adjustment



The arrows indicate the cover's direction of movement

Turning in the +, direction will increase the extension of the cover

Turning in the -, direction will reduce the extension of the cover

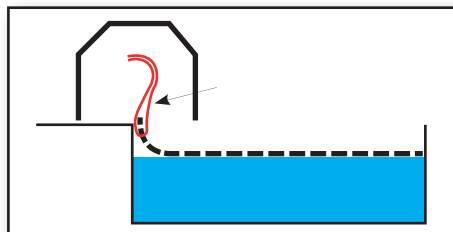

## ADJUSTING THE AUTOMATIC SWITCH

### INFORMATIONS

The automatic switch protects the system in case locking kits are unreleased when opening the pool.

If the cover jams, the motor is shut down automatically.

#### Different cases of jamming:

- Unreleased safety locking kit.
  - cover rubbing (on the beam, coping stone...)
  - Object in the pool jamming the cover (cleaner, counter-weight ...).

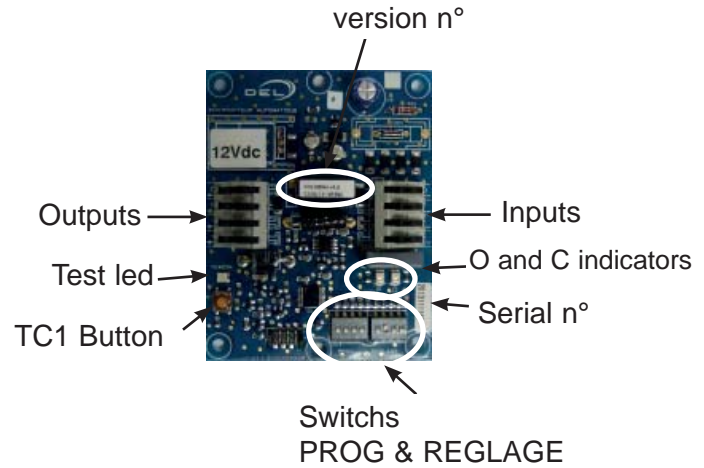

## 14

### Check the order logic

- Deactivate the automatic switch



deactivated



- Check:



Pool opening



INDICATORS		
Pilot	O	F



Pool closure



Pilot	O	F

If the command logic is not correct, check the installation wiring.

### Setting control duration

L = pool length steps included

$L \leq 12 \text{ m}$



30 seconds

$L > 12 \text{ m}$



60 seconds



# Adjusting the trigger sensitivity

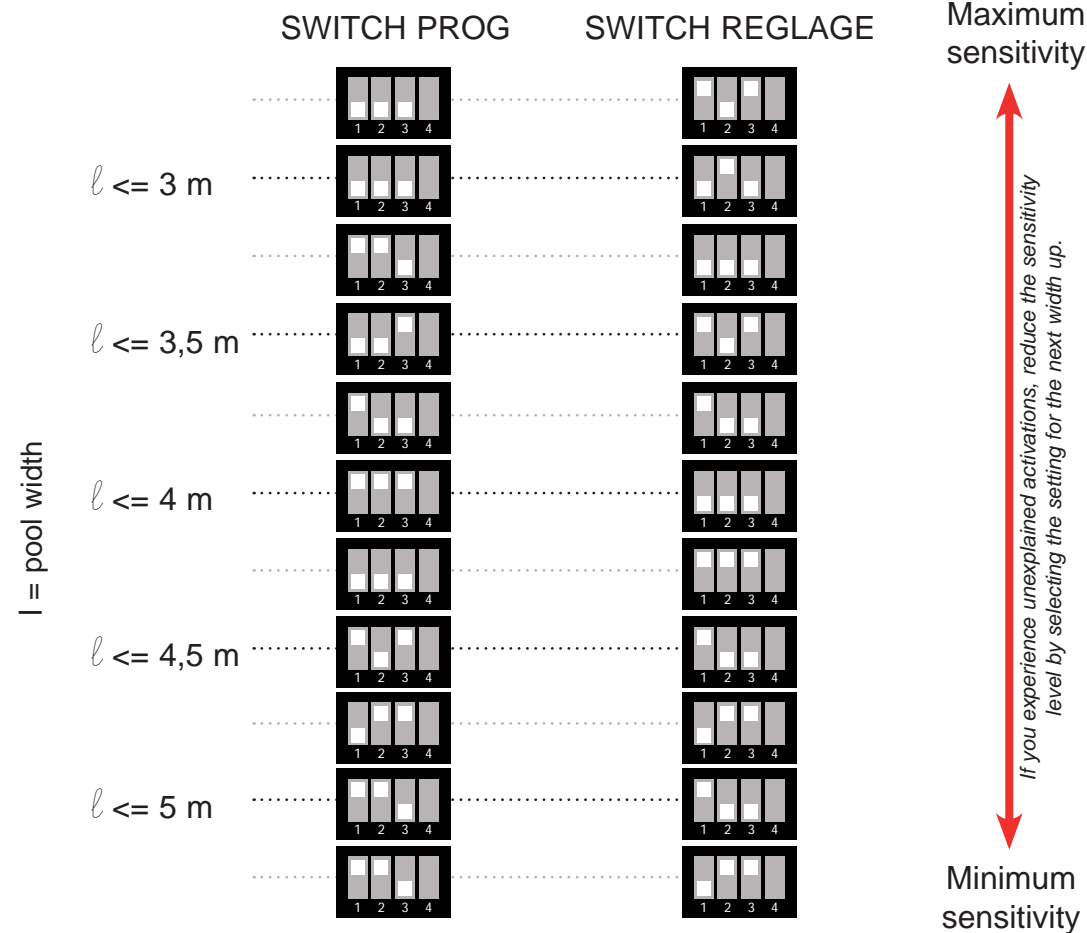

## Activating the automatic switch



**Failure to activate the automatic switch can cause serious damage to the motor, the control box, the slats and void the warranty.**

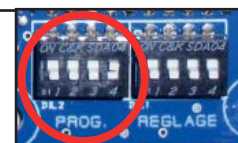

## Test

**A** - Block the cover by hand or with the fixture kits and keep the pool in sight when opening the cover.

**=> The motor is automatically stopped.**

**(If necessary adjust the sensitivity of the switch activation)**

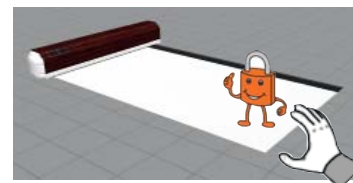

*If there are unplanned activations, reduce the sensitivity level by selecting the setting for the next bigger width.*

card activated	Test	O	F
	Opening, control in progress		
	Opening without control		
	Closure		
	Protection ON		

## To know

The automatic cover stops during the pool opening:

- 1 - Stop due to a real blocking: unlocking of locking kit oversight or other...  
- Close during more of 3 seconds until release completely slats tension.. **The next opening will stay protected by the system.**  
- Eliminate the blocking cause(s) and go again with the pool opening.

2 - Untimely stop:

- Close during **1 to 3 seconds**. **he next opening won't stay protected by the system**
- Go again with pool opening.

- In case of untimely activations, decrease the sensitivity of the card.
- In case of too important effort before activations, increase the sensitivity of the card. "Sensibilité de déclenchement" parameter

### Protected opening



**+ of 3 sec**

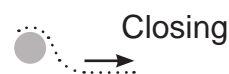

### Non-protected opening



**- of 3 sec**



The position of the fastener kits on the cover is indicated on the drawings shipped with the slats.

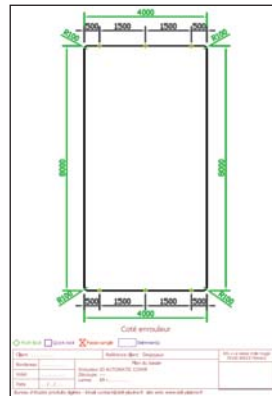

All changes to the positioning of the kits must comply with the rules given below. For other cases please contact us.

## 16 Positioning rules

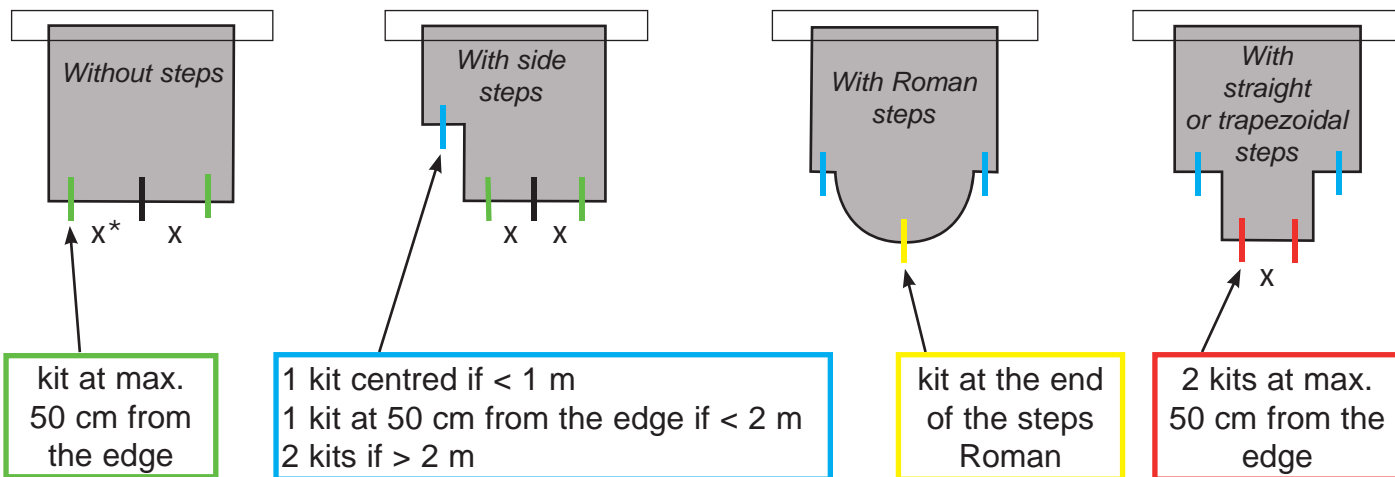

\* X must never exceed 2 m

The Quick-lock fastener system cannot be used on cut off corners and curves, except at the end of Roman steps.



## A water level regulator is mandatory

### Insert mounted model

For concrete and panel pools

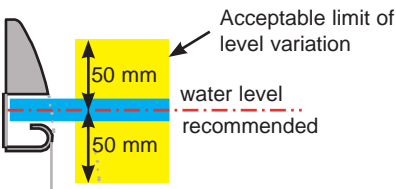
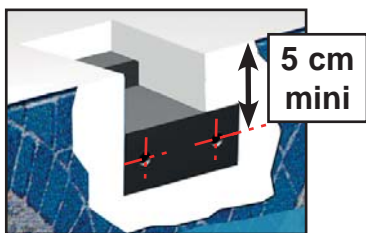

VBA TF Z pozi stainless steel A4 Ø6 x 60 wood screw

Hollow white Ø16 washer

Inserted part

Screw cap

### Hang mounted version

For concrete and panel pools

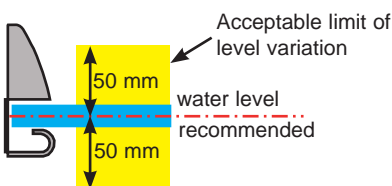
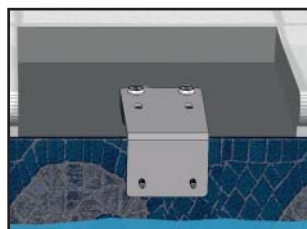

Ø12

VBA TF Z pozi stainless steel A4 Ø6 x 60 wood screw

Hang mount support

Hollow white Ø16 washer

INOX M6 washer

Stainless steel nut A4 M10

Screw cap

Cale 13 mm

Ø12 Nylon plug

### Surface mounted model

For concrete and concrete block pools, as well as pools with wall thickness greater than or equal to 8 mm

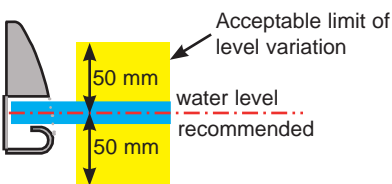
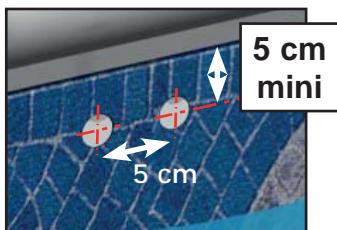

VBA TF Z pozi stainless steel A4 Ø6 x 60 wood screw

Hollow white Ø16 washer

Universal 8 x 40 plug

Screw cap

#### Concrete

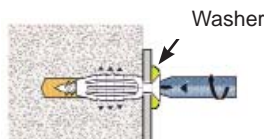

Once the resistance point has been reached stop screwing, this would deteriorate the fixture quality.

#### Concrete block

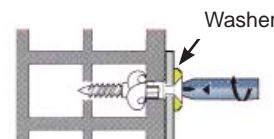

After reaching the resistance point, make 3 more turns of the screwdriver to finish tightening.

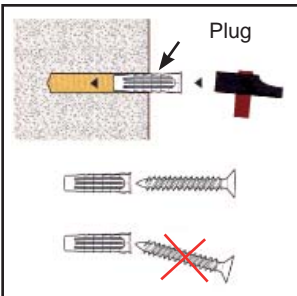

## INSTALLATION QUICK-LOCK

**A water level regulator is mandatory**

### Insert mounted model

For concrete and panel pools

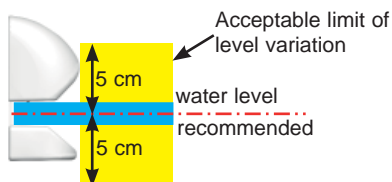
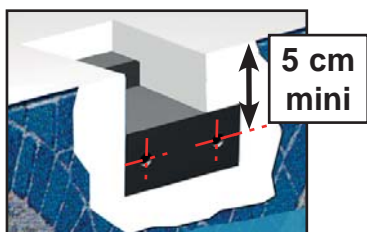

VBA TF Z pozi stainless steel A4 Ø6 x 60 wood screw

Hollow white Ø16 washer

Inserted part

adjustment

### Hang mounted version

For concrete and panel pools

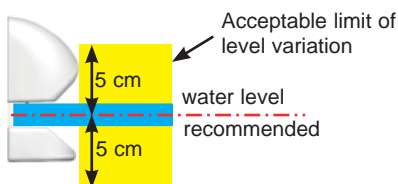
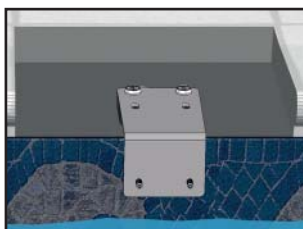

VBA TF Z pozi stainless steel A4 Ø6 x 60 wood screw

Hollow white Ø16 washer

Hang mount support

Inox M6 washer

Stainless steel nut A4 M10

Cale 13 mm

adjustment

Ø12 Nylon plug

### Surface mounted model

For concrete and concrete block pools, as well as pools with wall thickness greater than or equal to 8 mm

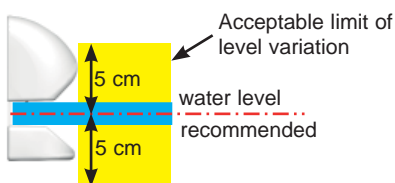
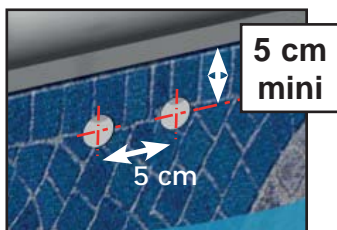

VBA TF Z pozi stainless steel A4 Ø6 x 60 wood screw

Hollow white Ø16 washer

Universal 8 x 40 plugs

adjustment

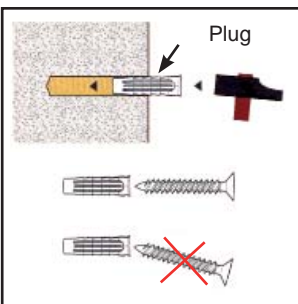
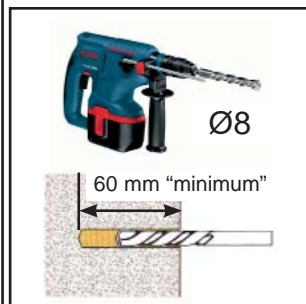

#### Concrete

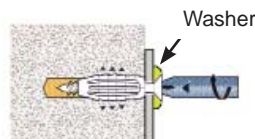

Once the resistance point has been reached stop screwing, this would deteriorate the fixture quality.

#### Concrete block

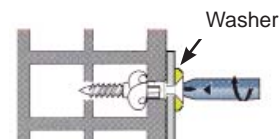

After reaching the resistance point, make 3 more turns of the screwdriver to finish tightening.

## A water level regulator is mandatory

### Insert mounted model

For concrete and panel pools

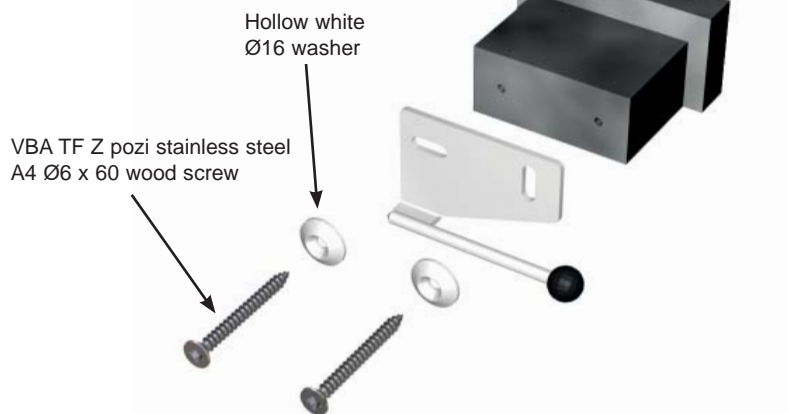
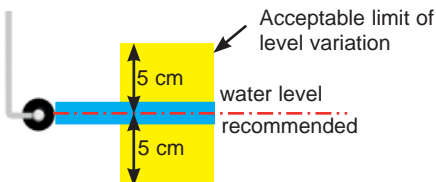
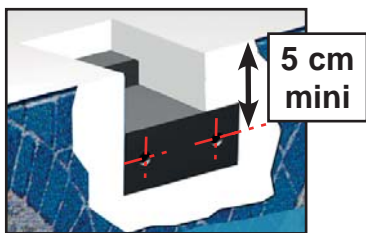

### Hang mounted version

For concrete and panel pools

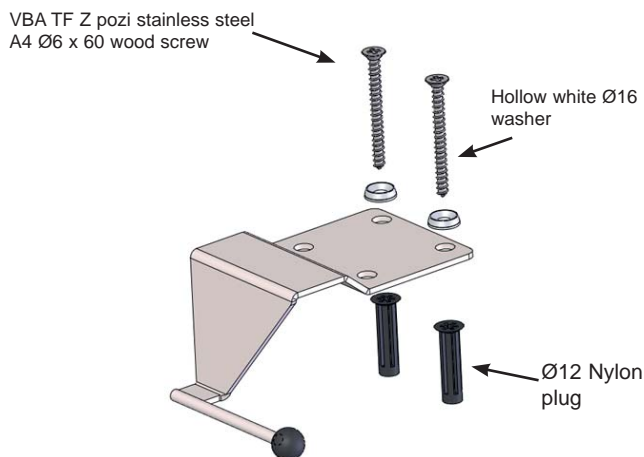
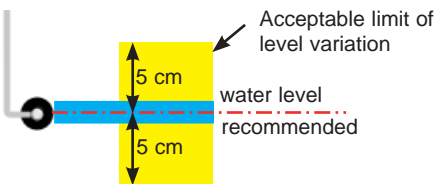

### Surface mounted model

For concrete and concrete block pools, as well as pools with wall thickness greater than or equal to 8 mm

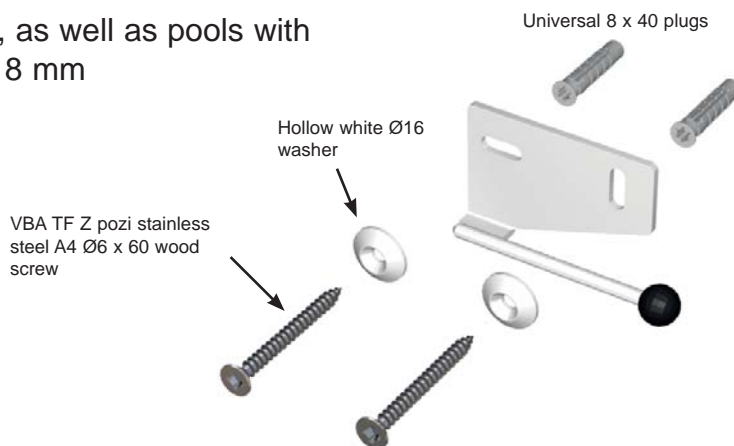
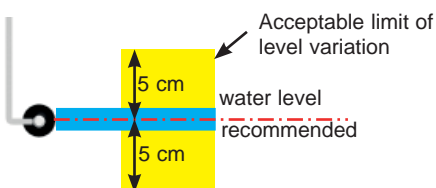
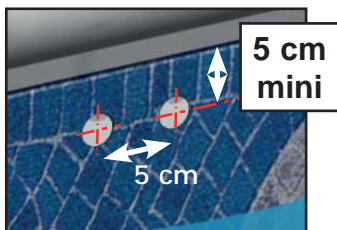

#### Concrete

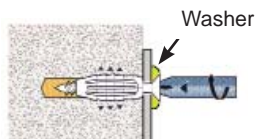

Once the resistance point has been reached stop screwing, this would deteriorate the fixture quality.

#### Concrete block

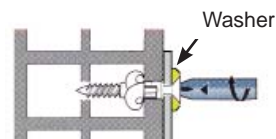

After reaching the resistance point, make 3 more turns of the screwdriver to finish tightening.

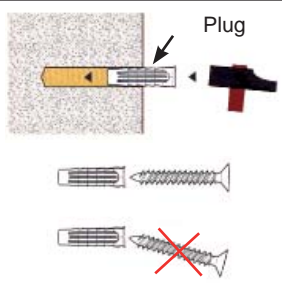



## INSTALLATION OF THE STRAP-HOLDER ANCHOR EYEBOLT

### Eyebolt for concrete beach



The head of the eyebolt must be higher than the beach surface



**Do not force the eyebolt into a drill hole of a smaller diameter than this**

### Eyebolt for wooden beach



Cruciform  
Ø4 x 25



depth : 4,5 cm

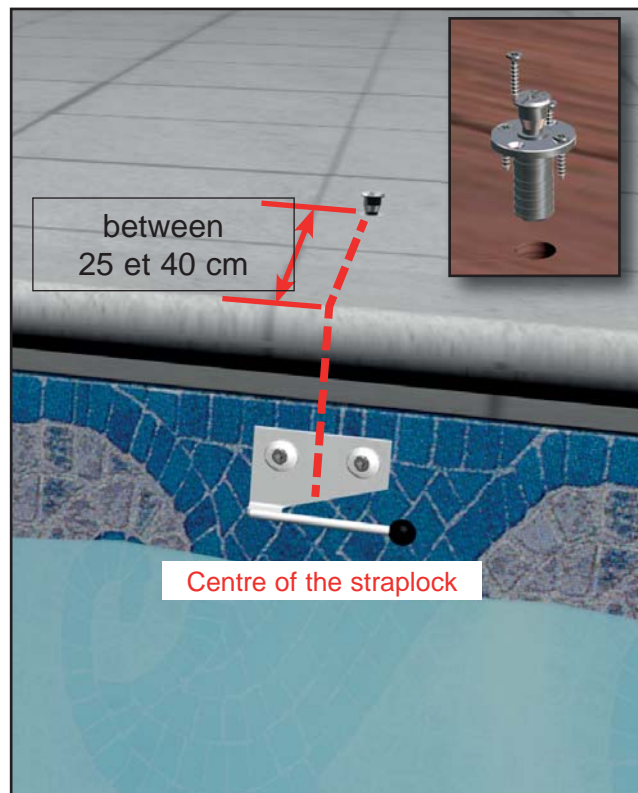

## INSTALLATION OF THE STRAPLOCK STRAP

single strap



double strap



or

+

+

+

Protective  
sheath



loop



staple

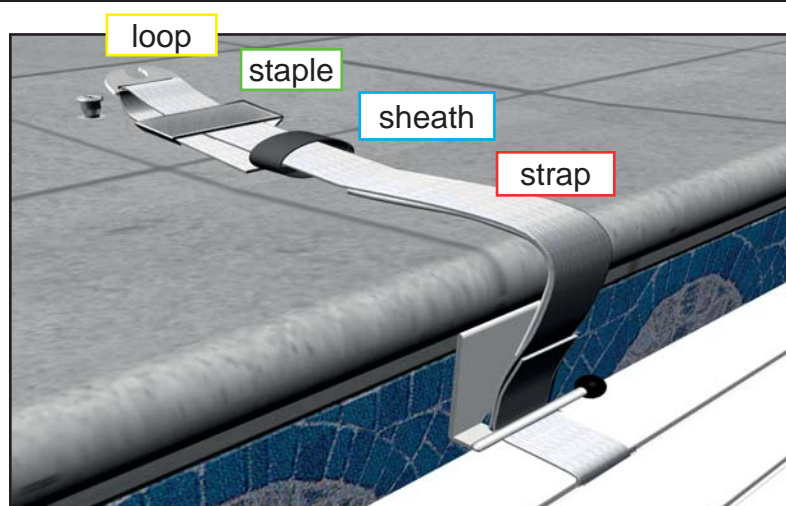

**Stretch the strap**  
*the cover must touch the underside of the straplock*

**Place the strap in position after the loop and crimp**  
*the 2 strap thicknesses pass inside the stable*

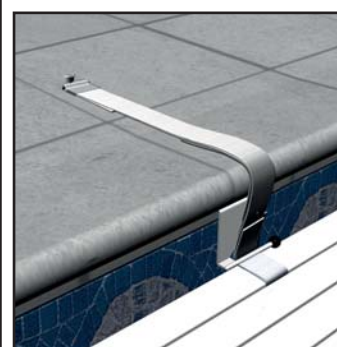
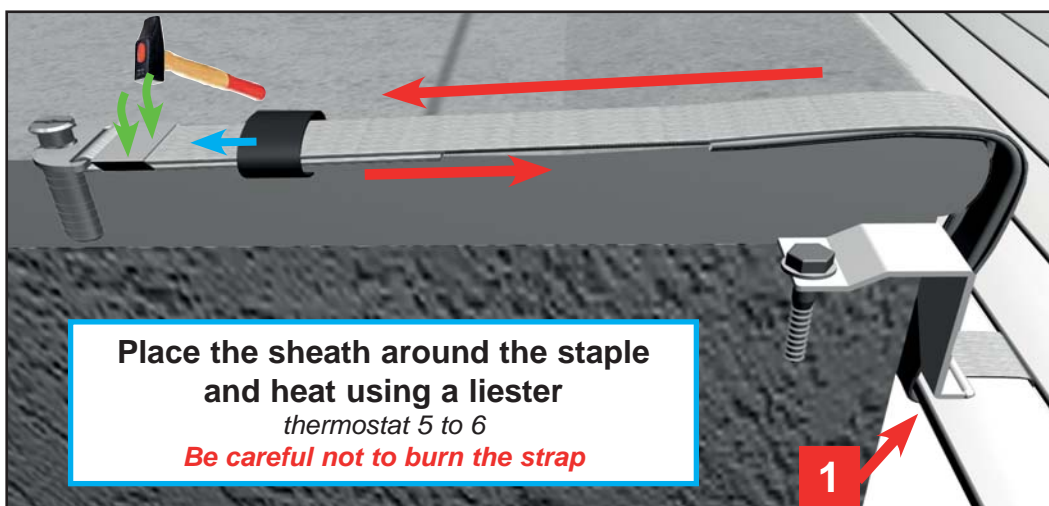



## OPENING/ CLOSURE OF THE POOL

**ALWAYS KEEP AN EYE ON THE POOL DURING OPENING OR CLOSING OPERATIONS.  
ALWAYS CHECK THAT THE POOL WATER LEVEL IS CONSTANT AND COMPLIANT WITH THE  
RECOMMENDATIONS ON THE INSTRUCTIONS**

- It is imperative not to halt the cover in an intermediate position, this can cause the risk of jamming a bather's body under the cover casing, if a bather uses the pool.
- When using an automatic cleaner under the cover, check that the hose does not affect the movement of the slats when opening and closing the cover.
- It is essential to remove floating objects when opening and closing the cover.
- Do not block the cover while extending or retracting.
- Do not activate the automatic cover when it is iced in.
- The opening or closure operation requires about 2 minutes for one person and about 3 minutes to lock or unlock the attachment kits.

**Opening: Always release the cover before starting the motor.**

- Unlock all the fastening systems.
- Operate the open control.
- Stow the unlocking tools out of the reach of children.
- Lock the WI-Key command



**Closure:**

- Operate the «contact maintained during closure» close control
- Lock all the fastener systems.
- Stow the unlocking tools out of the reach of children.
- Lock the WI-Key command



## IMPORTANT

When closing the pool, it is essential to **KEEP THE CONTROL PRESSED FOR AT LEAST 3 SECONDS**. This is required to guarantee automatic obstacle detection the next time the cover is opened.





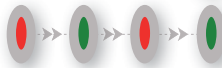

21



### LOCKING THE WI-KEY

- Press on  for more than 3 seconds until the pilot flashes  = system locked

### UNLOCKING THE WI-KEY

- Press  and keep it pressed.
- At the same time: successively press the following 3 keys: :   
- The pilot  remains on  = emitter unlocked

## LIGHT INDICATORS

When you press a key, the light indicators below provide information on the Wi-key status (locked/unlocked), as well as the battery charge level.

	Green LED	----->	Wi-key unlocked
	Red/green flashing LED	----->	Wi-key locked
	Orange LED	----->	Battery level low
	Red LED	----->	Change the batteries (2 x LR03)

## Locking



## Releasing



## Locking

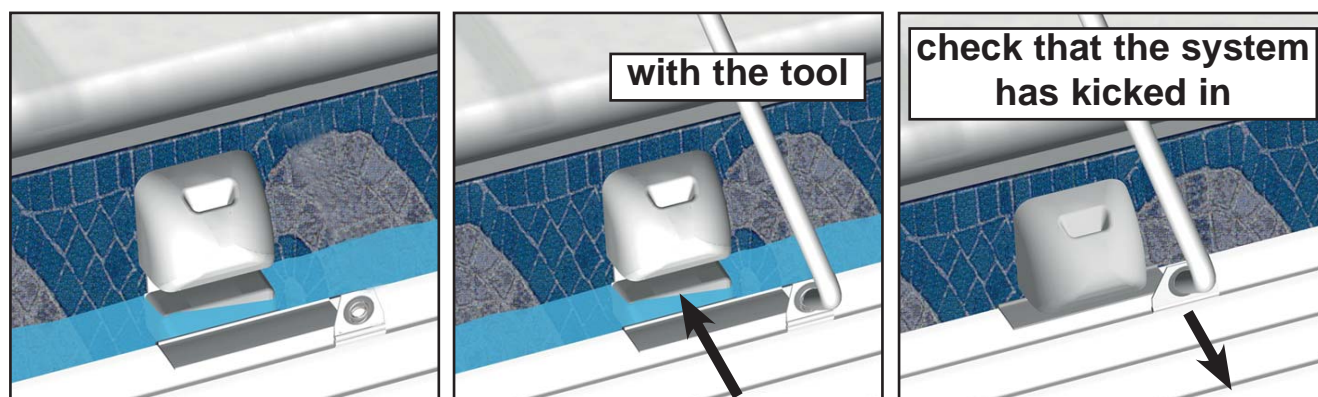

## Releasing

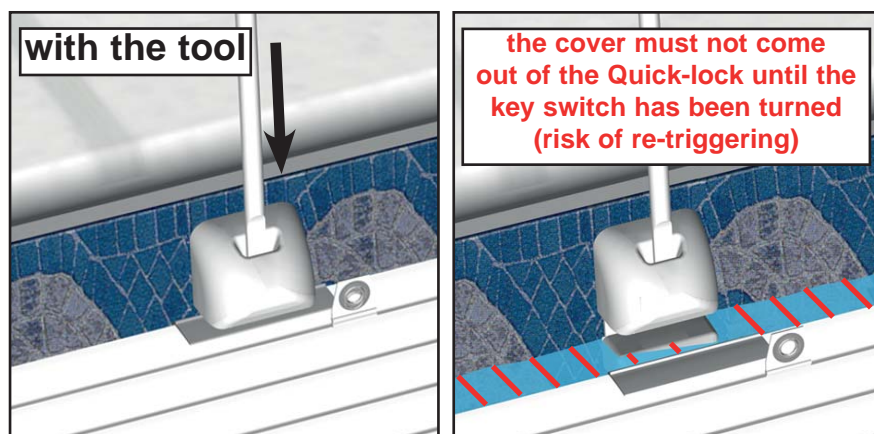
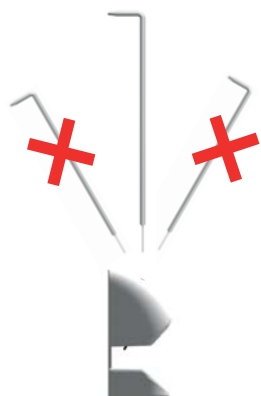

## LOCKING AND RELEASING THE STRAPLOCK

### Locking

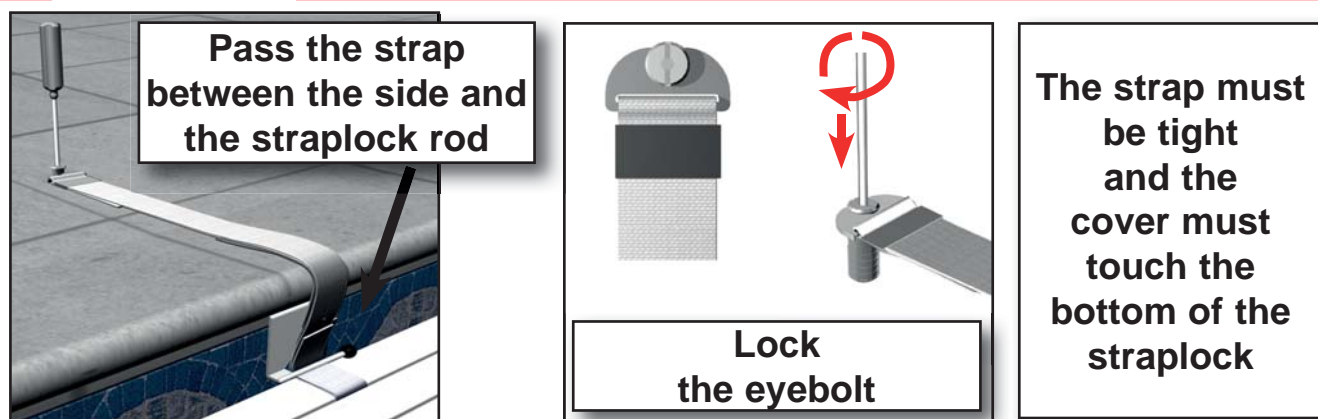

### Releasing

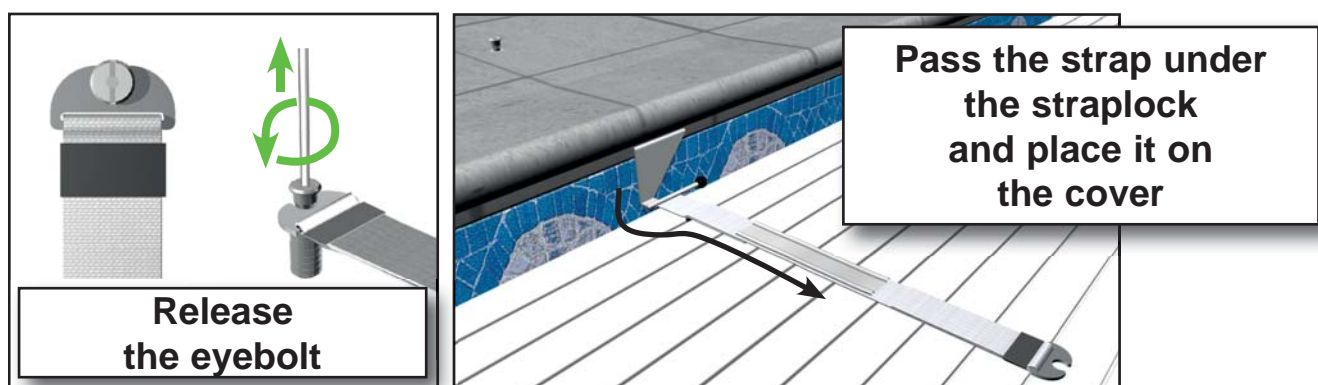

## POOL WATER LEVEL

- To ensure optimum safety and the correct operation of the roller, always check that the level of the water in the pool remains constant and compliant with the manufacturer's recommendations.  
(For further comfort, use an overflow and a level regulator).
- When the level is too high it is caused by the overflow being blocked by leaves or other debris.
- If the water level is too low there is a risk of jamming.
- If there are gutters or hand rails, the pool must be equipped with a water level regulator.

## FILTERING

- Programme filtering during sunlight periods and operate it permanently as soon as the water reaches 25°C.

## CLEANING (USER'S RESPONSIBILITY)

- Clean your cover fully twice a year (start of season and wintering). This is even more important if you have hard water. To do this, use a high pressure cleaner with warm water and a descaling product (Décalcit super).
- Also take care to regularly clean the fastening systems and especially the eyebolt so that it never jams. We recommend lubricating the eyebolts every year for optimum operation.
- It is advisable to inspect the whole system, in the event of abnormal strain on the cover (eg. somebody falling)
- Check the straps annually
- To obtain the best performance from the solar panels, regularly clean them using a window cleaning product.

## BATTERIES



AT THE FIRST SIGN OF WEAKNESS, RECHARGE THE BATTERIES.

**NEVER COMPLETELY RUN DOWN THE BATTERIES**

Connect the batteries to the charger (*be careful of the polarity*). Plug in the charger. It will turn on automatically at the suitable voltage and the charging process starts. The red LED indicates charging. When charging is complete, the red LED turns off and the batteries are supplied using a maintenance charge. (see charger notice)

Warning: - Keep the charger in a dry place. Never recharge close to the pool, do this in a dry place.

## WINTERING

- Winter the pool depending on its geographic location.
- Close the cover in the safety position.
- Leave the batteries connected inside the roller and do not cover the solar panel.
- We recommend you install the IVERNEA winter shield to protect the cover from UVs and dirt

## MAINTENANCE

- All work must be carried out by a professional who will contact the manufacturer if necessary.
- All spare parts must be original or compliant with the standard.
- Inspect the whole cover for damage/wear and tear.
- At the beginning of each season and in the event of an accident (fall, hail on the cover, abnormal strain on the cover, etc.) check that the slats have no visible signs of deterioration that could prevent the safe operation of the cover (cracked, pierced or bent slats, etc.). Change the slats or the whole cover if necessary.
- In both summer and winter, do not cover the slats with an opaque cover. There is a risk of damage due to excess heat.
- Check the condition of the straps (seams) and especially wear on the anti-abrasion sheath. If the latter no longer fulfils its protective function from friction of the strap against the pool side, replace it.
- The «witness» flashes RED = change the control box battery



MANUAL HANDLE

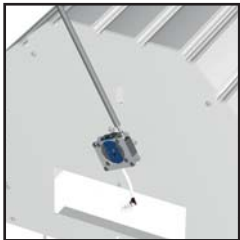

Its use does not change the automatic stops adjustment.

WI-KEY

Pairing -- delivered pre-paired

1 receiver

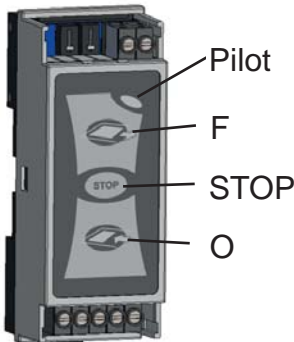

Press «STOP» and, without releasing it, press «O» for more than 3 seconds  
OK when the «pilot» flashes green.  
an emitter must be paired within the next 30 seconds.

2 emitter

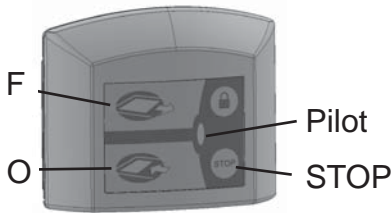





Press «STOP» and, without releasing it, press «O» for more than 3 seconds  
OK when the «pilot» flashes red / green.  
another emitter must be paired within the next 30 seconds.

Replacing the batteries

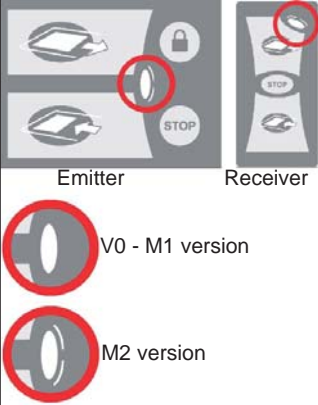

Be careful of the seal when re-assembling

	 Receiver	 Emitter	
Manufacturer	DEL	DEL	
Reference	Wikey receiver	Wikey emitter	
Category	3 (EN 300220-1)	3 (EN 300220-1)	
Range	50m in an obstacle-free zone	50m in a free zone	
	25m through a concrete wall	25m through a concrete wall	
Power supply	12 to 48 VDC 30mA max	Two 1.5V AAA batteries	 V0 - M1 version  M2 version
Protection index	< IP40	< IP54	