

C.P.A.
S.R.L.

SOLAR SPRING SHOWER



C.P.A. srl

Via Don Demetrio Castelli, 71 - 12060 RODDI (CN)
Tel. 0173.615693 - Fax 0173.620922

www.cpa-piscine.it
cpa@cpa-piscine.it

Ver.02 - 11/06/20

Spring Solar showers features

- Structure made of anti-corrosion aluminum alloy, painted in the oven.
- Tank capacity 30 liters.
- Water inlet with ½ inch male fitting with possible automatic connection.
- Equipped with safety valve set at 3 bar.
- Weight: 15 Kg.
- Packaging dimensions 2350x220x450.
- The foot washer only supplies cold water.

Color choice:



antracite



sabbia



arancio



fuxia



verde



rosso

TAB 1 Dada shower with feet flushing

Code	1040268	1040262	1040264	1040263	1040261	1040260
Color	Anthracite	Sand	Orange	Fuxia	Green	Red

Code	Description
TAB 1	Spring solar shower with feet flushing
1040267	Spring solar shower with feet flushing inox painting

Dimensions

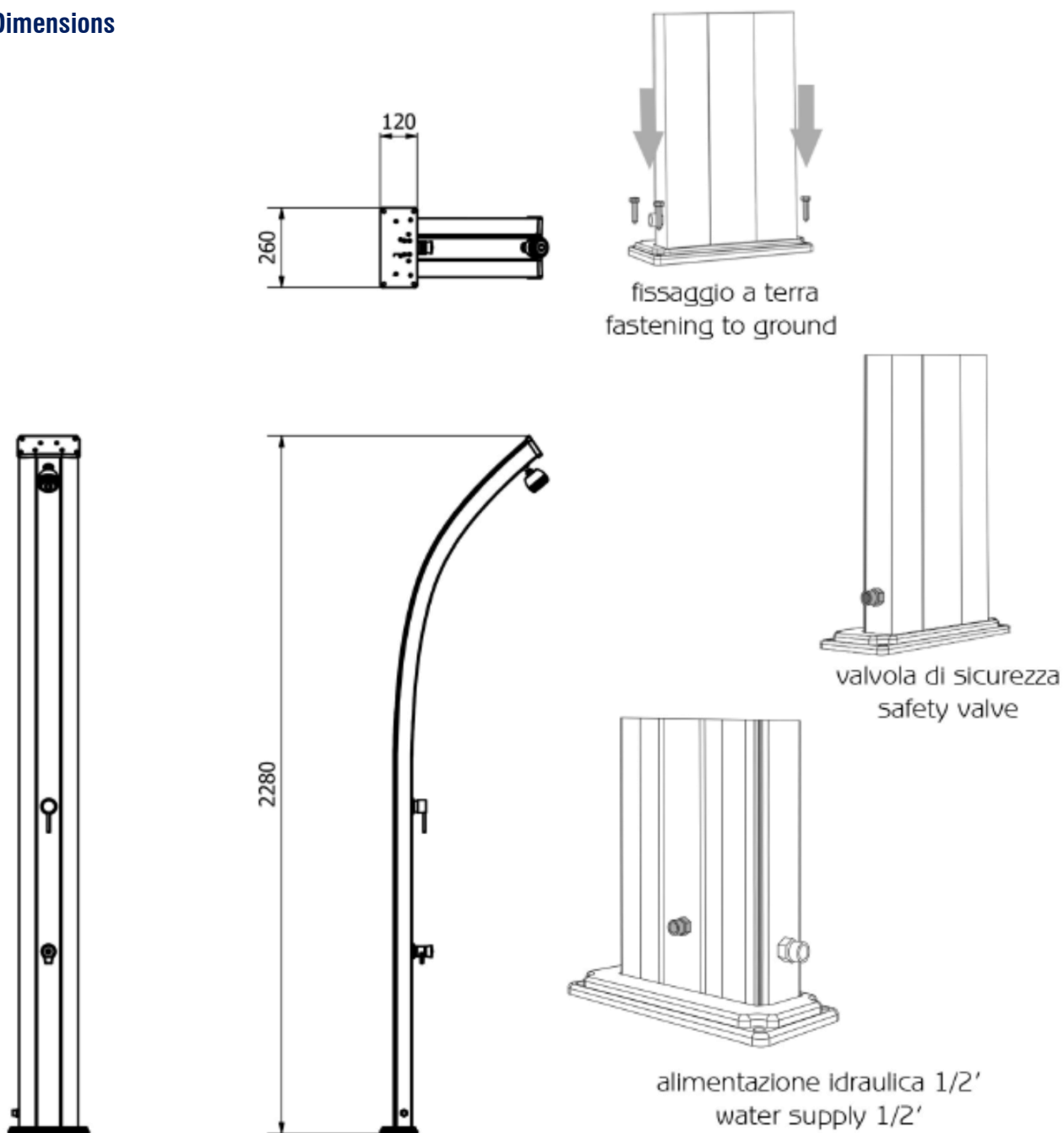

Components

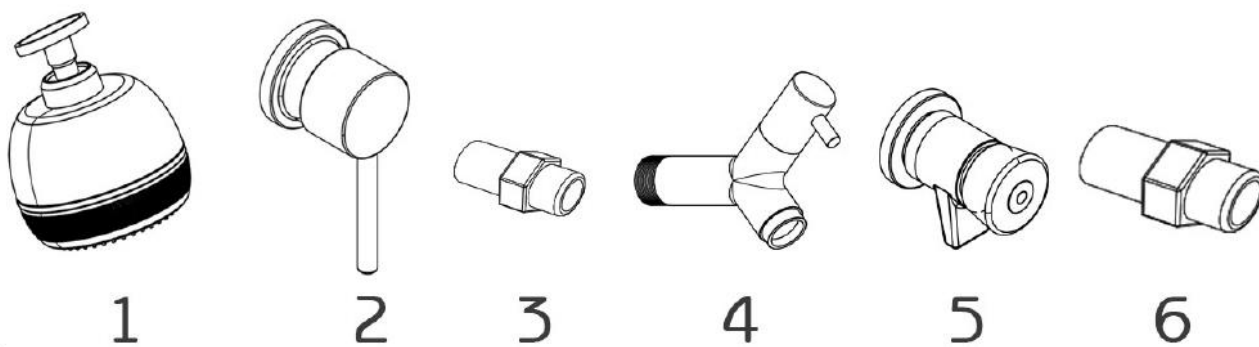

Spring shower with feet flushing

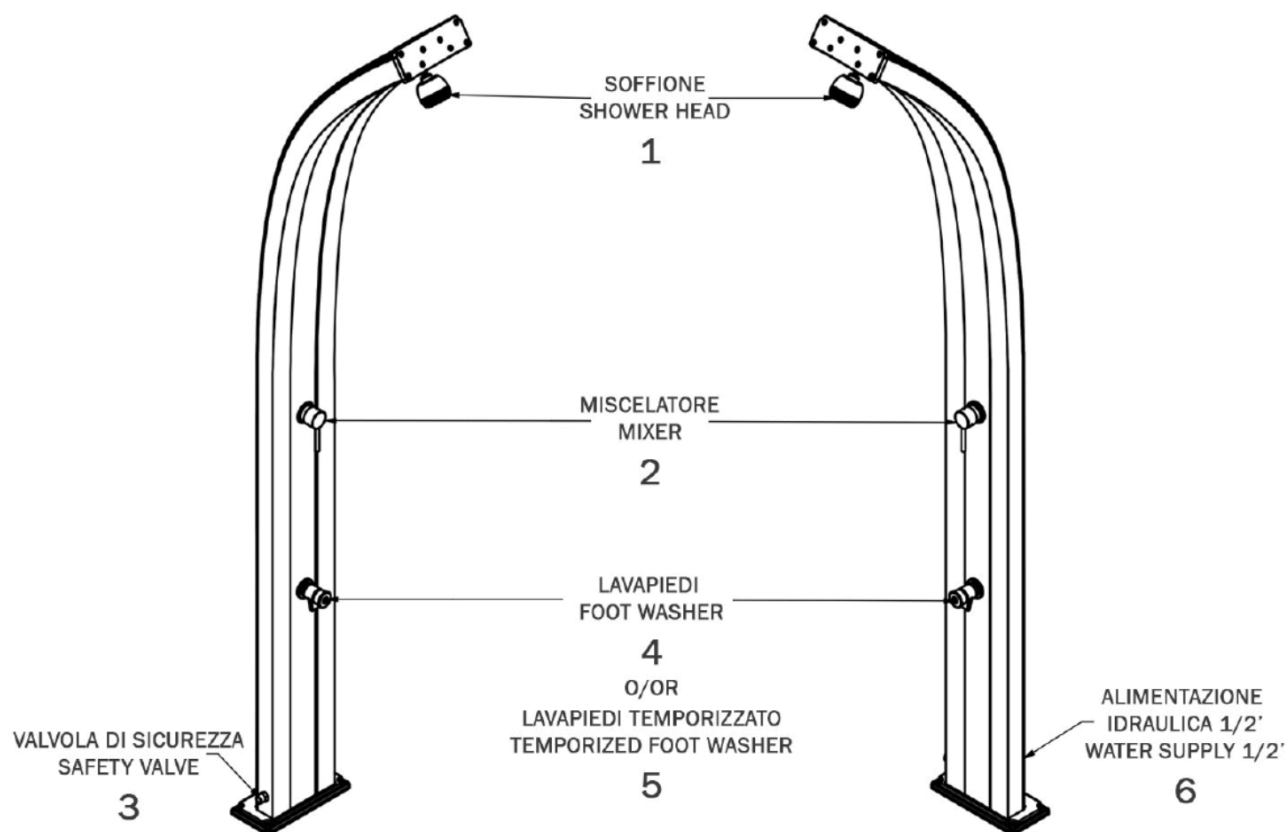

Technical details

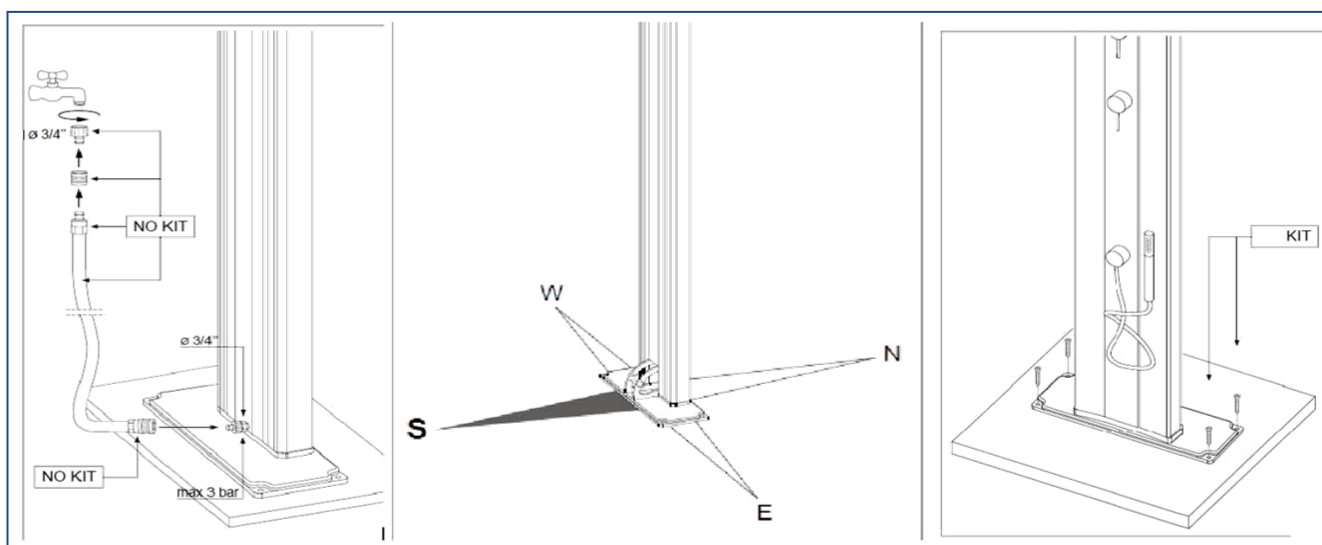

WARNING:

During the first installation, the solar showers dripped a few minutes after closing the mixer, due to the expansion of the water and air which, when heated, dilate. This small leak ceases with the stabilization of the water temperature.

use and installation instructions

SPRING solar showers are intended for outdoor use near a swimming pool, on a beach or in a garden. Before using your new shower, it is advisable to read the instructions and advice for use.

BOX CONTENTS

- Shower
- Adjustable shower head / gasket
- Mixer already mounted
- Foot washer tap already mounted (optional)
- Connection fitting to the Gardena® 15/21 water inlet
- 4 or 5 * fixing screws / plugs / washers
- Installation and use manual

WARNING

During the hottest days in summer, it is possible that the water inside the tank exceeds 60 ° C.

Before taking a shower it is necessary to place the mixer on «cold water», to regulate the temperature progressively until you obtain a temperature of your liking.

Do not touch the surface of the shower to avoid the risk of superficial burns.

It is possible that the water continues to come out after closing the mixer. All this is normal and the water stops flowing in the following 10-15 seconds.

Do not use the shower in the event of a thunderstorm, to avoid the risk of electric shock.

The solar shower is designed to be used in "normal" water supply conditions with a pressure lower than 3 bars (3 kg). Otherwise it is necessary to have a pressure reducer.

INSTALLATION

1. Choose a location that is as exposed as possible to direct light (ideally 360 °), near a water supply and drain.
2. Install the shower head by screwing it onto the shower body.
3. On a solid support (concrete, concrete, heavy wood grate) make 4 - 5 * holes of about 12 mm in diameter and about 70 mm in depth following the groove on the base of the shower.
4. Position the plugs and install the solar shower vertically using washers and screws.
5. Connect to the water supply. If necessary, use the adapter.

1° USE

1. Open the tap (cold or hot water) to release the air contained inside the shower and allow the shower tank to fill completely.
2. When the water starts to come out of the shower head, it means that the solar shower tank is full. You can then turn off the shower tap and wait for the water in the tank to be heated by the sun. Cold water is available immediately.

USE

When the water is heated by the sun in summer, a minimal amount of water can drip from the shower head. This is normal, since the volume of water contained in the shower increases due to the heat.

The shower and the foot washer can be used separately or simultaneously.

Only the shower provides cold water mixed with hot water. The other elements only supply cold water.

In case of prolonged use, you will notice a drop in the water temperature as the duration of the intensity of the sun's rays becomes insufficient.



MAINTENANCE AND REPAIR

After prolonged use, limestone and other materials are likely to settle on the shower head. Turn off the water supply to remove the shower head to wash it.

The solar shower is designed to be used at an outside temperature above 3 ° C.

At the end of the season of use, turn off the water supply. In regions where the outside temperature drops below 3 ° C, the tank must be completely emptied in order to avoid damage caused by frost.

WARRANTY

The solar shower has a 2-year guarantee. This warranty does not cover damage caused by frost.

Note

- The information contained in this document may change at the discretion of the editor, without notice, contextually to the changes of the product in question to this document: it will be the customer's responsibility when ordering to verify the persistent correspondence of the product to the information sheet.
- Any technical diagrams reproduced in this document are for information purposes only and are not valid for regulatory purposes