



C.P.A. S.R.L.

DADA SOLAR SHOWER



Dada solar shower features

- Made entirely of aluminum and painted in the oven to ensure its durability, aesthetics and quality.
- Available with stainless steel version too.
- Tank capacity 40 liters
- Height 2,25 m
- Hot/cold water mixer equipped
- Weight: 22,00 Kg
- Color choice:



antracite



sabbia



arancio



fuxia



verde



rosso

Code	Description
TAB 7	Dada solar shower with feet flushing
TAB 8	Dada solar shower with timer and feet flushing
TAB 9	Dada solar shower with mobile shower and diverter
TAB 10	Dada solar shower + nebulizer and feet flushing
1040316	Dada solar shower with feet flushing and stainless steel paint

TAB 7 Dada shower with feet flushing

Code	1040315	1040310	1040312	1040311	1040309	1040308
Color	Antracite	Sand	Orange	Fuxia	Green	Red

TAB 8 Dada shower with times and feet flushing

Code	1040465	1040466	1040467	1040468	1040469	1040470
Color	Antracite	Sand	Orange	Fuxia	Green	Red

TAB 9 Dada shower + mobile shower and diverter

Code	1040471	1040472	1040473	1040474	1040475	1040476
Color	Antracite	Sand	Orange	Fuxia	Green	Red

TAB 10 Dada shower + nebulizer and feet flushing

Code	1040477	1040478	1040479	1040480	1040481	1040482
Color	Antracite	Sand	Orange	Fuxia	Green	Red

Dimensions

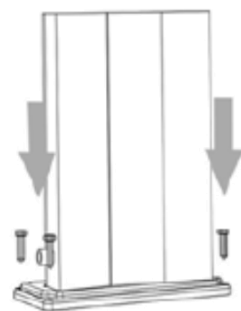
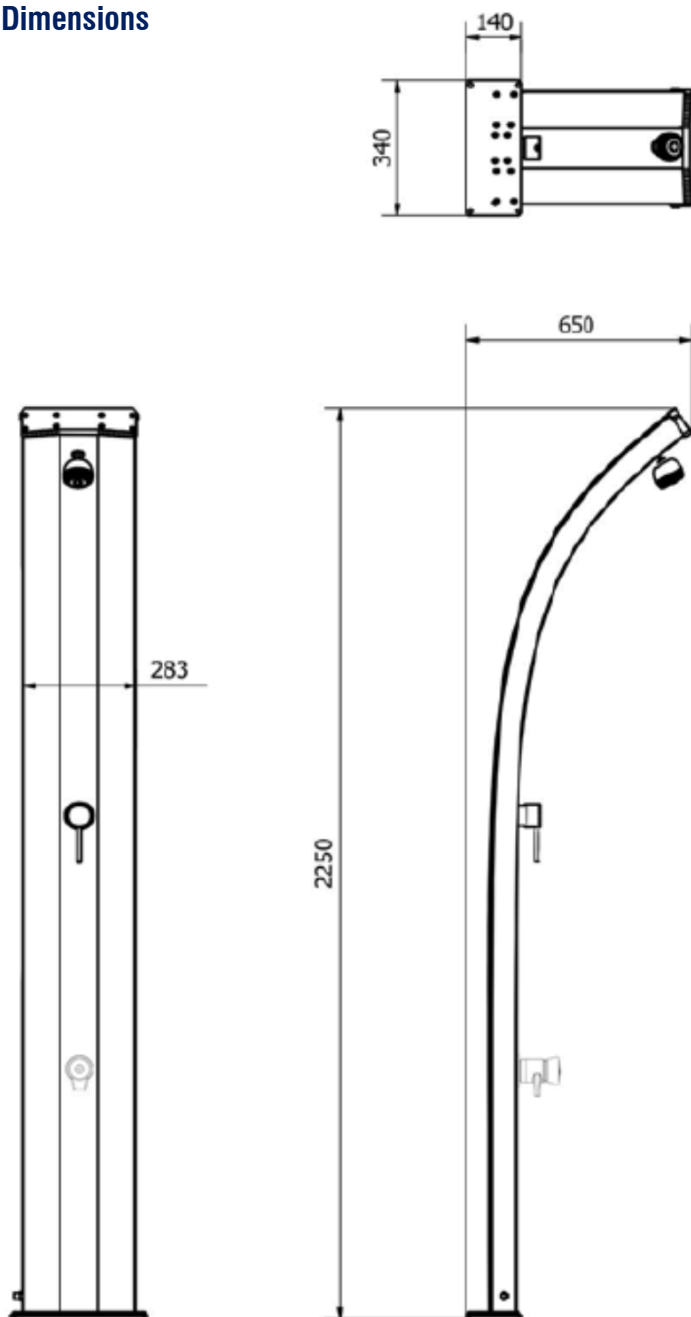

Fissaggio a terra
Fastening to ground



Valvola di sicurezza
Safety valve

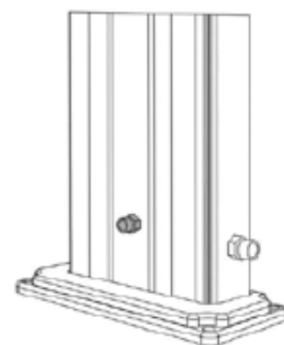

Alimentazione idraulica 1/2'
Water supply 1/2'

Components

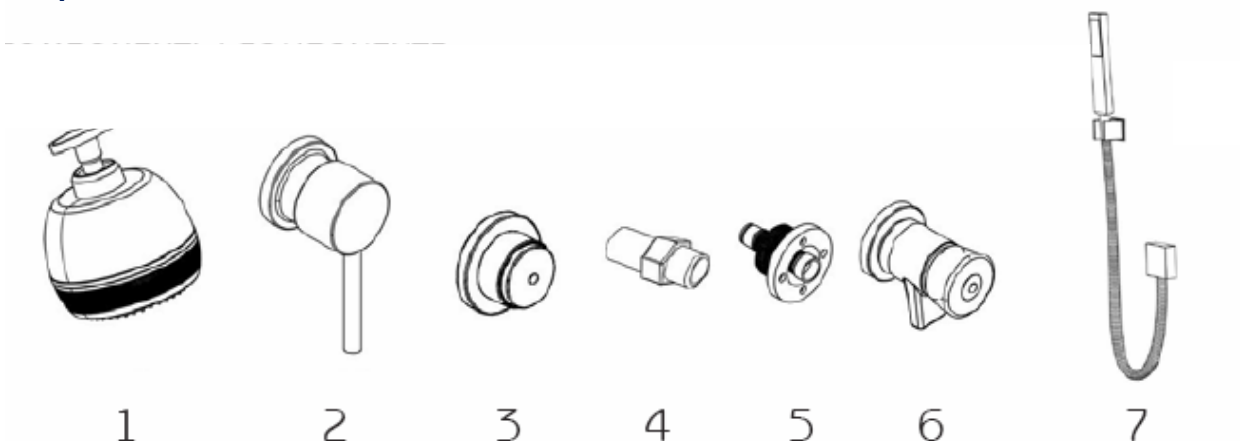

Dada Shower with feet flushing

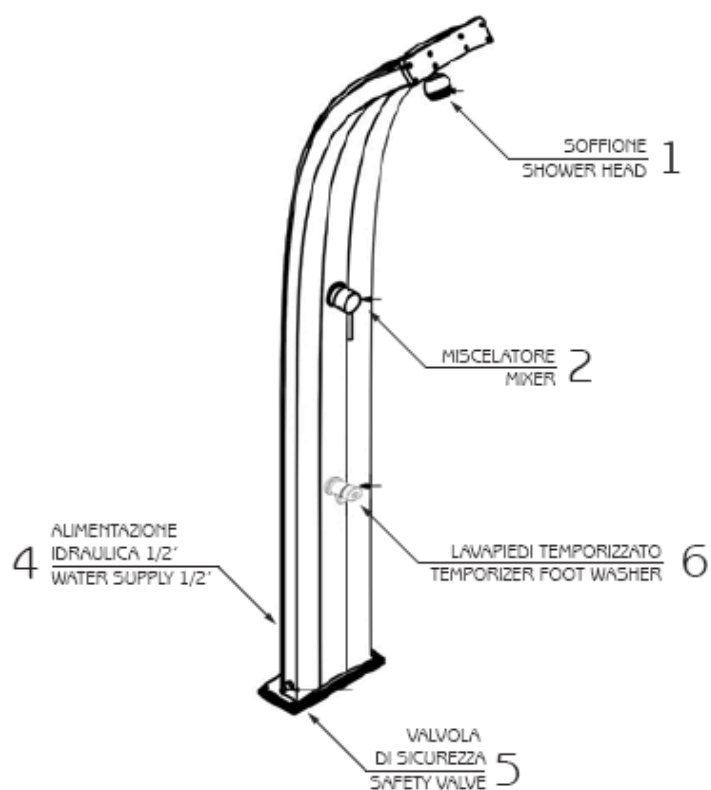

Dada Shower with timer and feet flushing

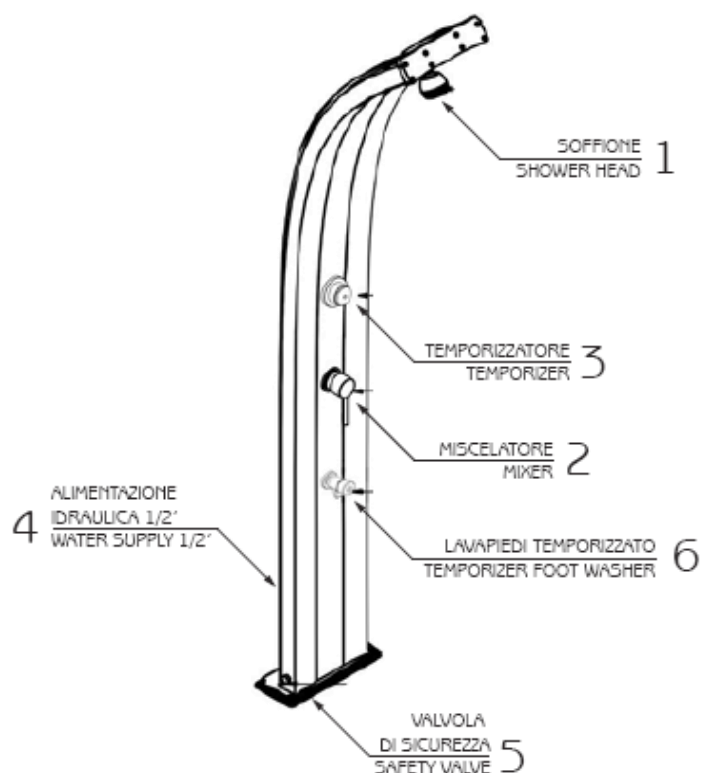

Dada Shower + mobile shower with diverter

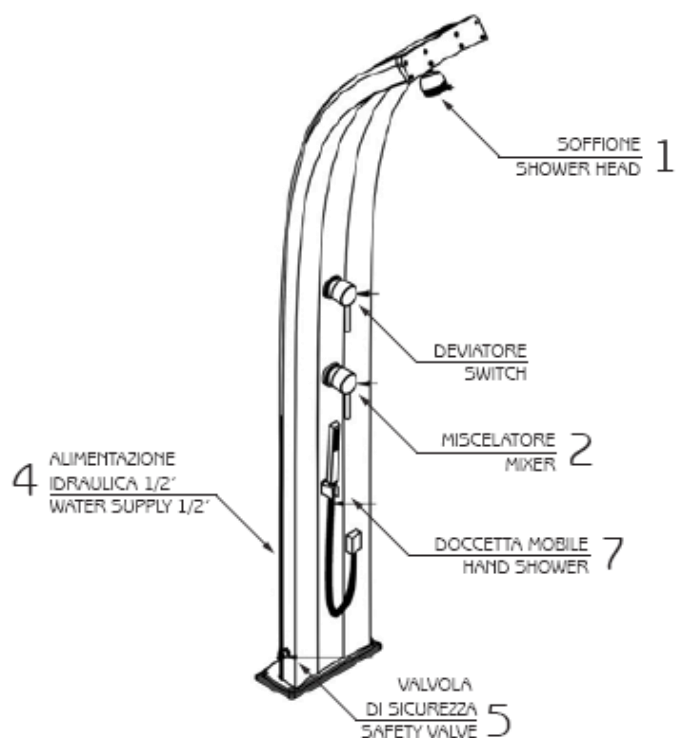

Dada shower + nebulizers and feet flushing

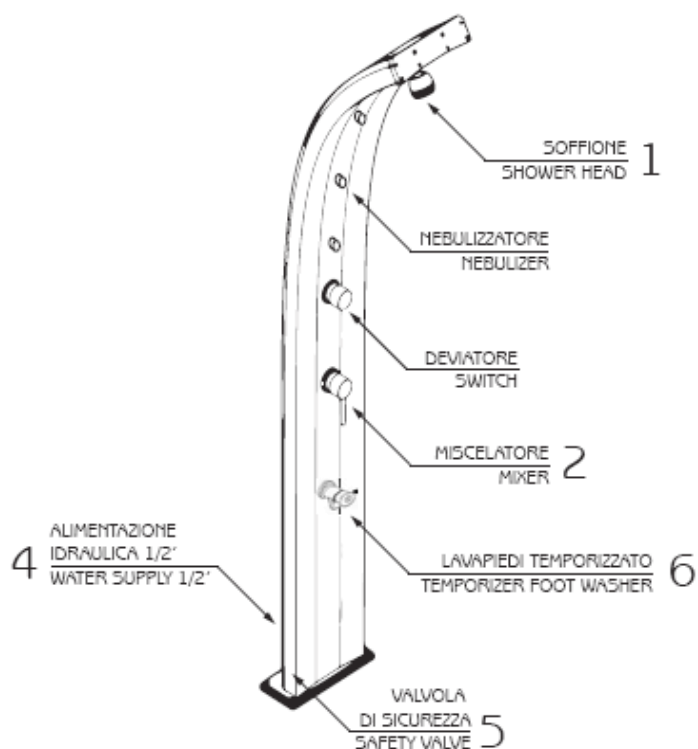

Shower base technical drawings

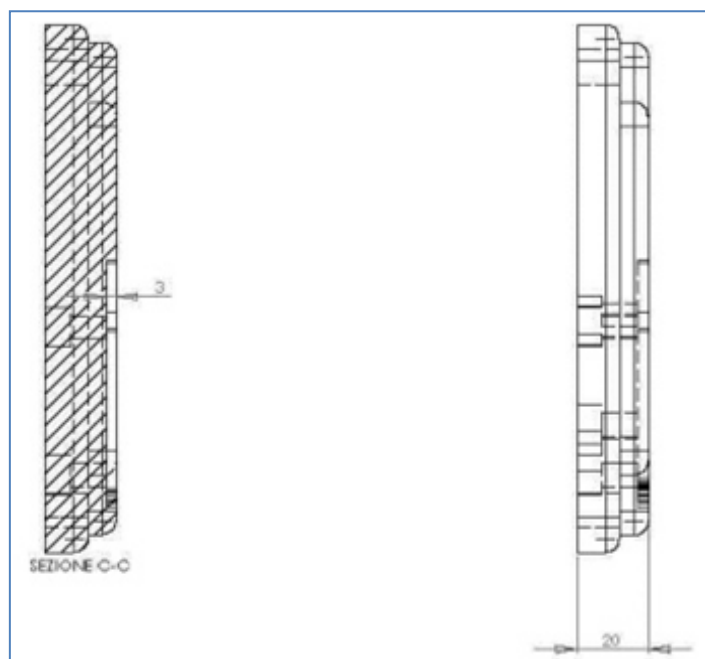
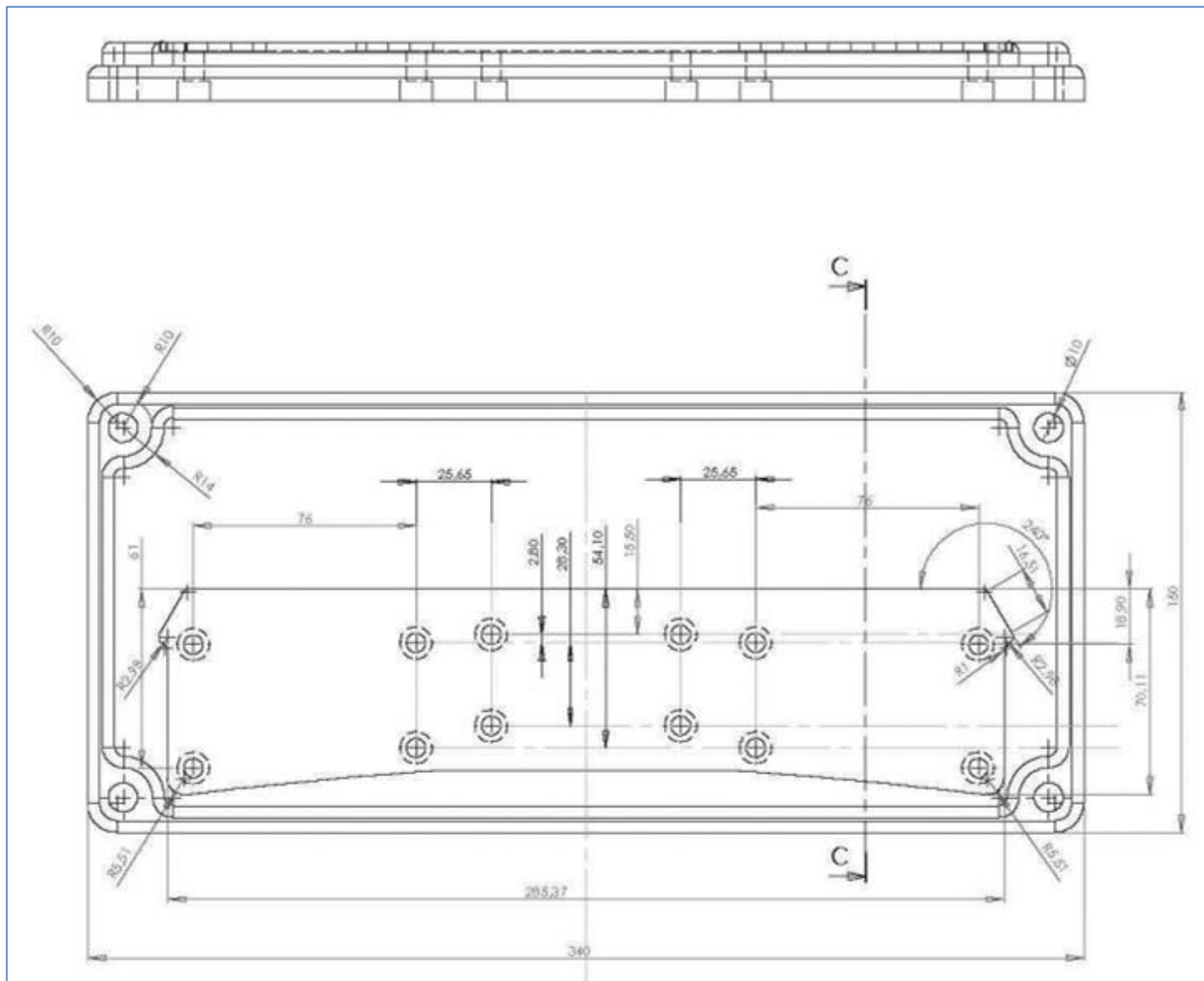

Installation and use instructions

DADA solar showers are intended for outdoor use near a swimming pool, on a beach or in a garden. Before using your new shower, it is advisable to read the instructions and advice for use.

BOX CONTENTS

- Shower body
- Adjustable shower head / gasket
- Mixer already mounted
- Foot washer tap already assembled (option)
- Connection fitting to the Gardena water inlet ® 15/21
- 4 or 5* screws / dowels / washers
- Installation manual

WARNING

During the hottest days in summer, it is possible that the water is inside the tank above 60 ° C.

Before taking a shower it is necessary to position the mixer on «cold water», to regulate the temperature progressively until a desired temperature is obtained.

Do not touch the shower surface to avoid the risk of superficial burns.

It is possible that the water continues to come out after closing the mixer. All this is normal and the water stops flowing in the following 10-15 seconds.

Do not use the shower in the event of a thunderstorm, to avoid the risk of electric shock.

The solar shower is designed to be used in "normal" water supply conditions with a pressure lower than 3 bars (3 kg). Otherwise it is necessary to have a pressure reducer.

INSTALLATION

1. Choose a location that is as exposed as possible to direct light (ideally 360 °), near a water supply and drain.
2. Install the shower head by screwing it onto the shower body.
3. On a solid support (cement, concrete, heavy wood grate) make 4 - 5 * holes of about 12 mm in diameter and about 70 mm in depth following the groove on the base of the shower.
4. Position the plugs and install the solar shower vertically using washers and screws.
5. Connect to the water supply. If necessary, use the adapter.

1° USE

1. Open the tap (cold or hot water) to release the air contained inside the shower and allow the shower tank to fill completely.
2. When the water starts to come out of the shower head, it means that the solar shower tank is full. You can then turn off the shower tap and wait for the water in the tank to be heated by the sun. Cold water is available immediately.

USE

When the water is heated by the sun in summer, a minimal amount of water can drip from the shower head. This is normal, since the volume of water contained in the shower increases due to the heat.

The shower and the foot washer can be used separately or simultaneously.

Only the shower provides cold water mixed with hot water. The other elements only supply cold water.

In case of prolonged use, you will notice a drop in the water temperature, as the duration of the intensity of the sun's rays becomes insufficient.



MAINTENANCE AND REPAIR

After prolonged use, limestone and other materials are likely to settle on the shower head. Turn off the water supply to remove the shower head to wash it.

The solar shower is designed to be used at an outside temperature above 3 ° C.

At the end of the season of use, turn off the water supply. In regions where the outside temperature drops below 3 ° C, the tank must be completely emptied in order to avoid damage caused by frost.

WARRANTY

The solar shower has a 2-year guarantee. This warranty does not cover damage caused by frost.

Note

- ☐ The information contained in this document may change at the discretion of the editor, without notice, contextually to the changes of the product in question to this document: it will be the customer's responsibility when ordering to verify the persistent correspondence of the product to the information sheet.
- ☐ Any technical diagrams reproduced in this document are for information purposes only and are not valid for regulatory purposes