

USER HANDBOOK

MODEL

AM30M
AM30MI
AM45MI
AM60MI
AM80MI
AM90MI

AM30D
AM30DI
AM45DI
AM60DI
AM80DI
AM90DI

Welcome to select the
above AM Heater.

Keat the user handbook
before using the heater.

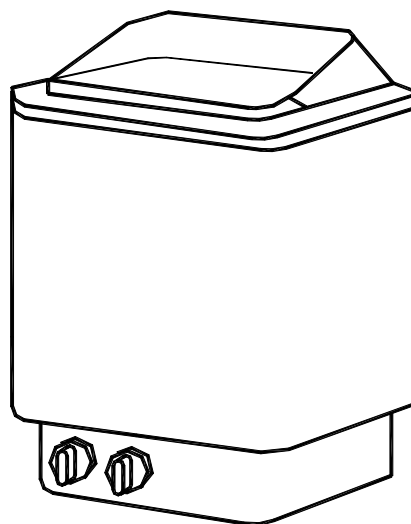

The Heater

- Installation
- Operation

Electric Heater

Welcome to select AM series SAUNA STOVE, with rational design, reliable performance, steady effort and convenient installation. Sauna-bathing equipment is composed of the heater and sauna room. After Sauna-bathing, people feel the flow of the spirits, excrete virus in body, eliminate fatigue, release the muscle and also good for health.

AM sauna stove series is designed for small sauna room, the model as following: AM30M、AM30MI、AM45MI、AM60MI、AM80MI、AM90MI and AM30D、AM30DI、AM45DI、AM60DI、AM80DI、AM90DI, which is equipped with suitable sauna room and control the temperature. (See table 1).

⚠Warning: The heater is forbidden to use the heat of any other purposes.

ATTENTION: This appliance is not intended for use by person (including children) with reduced physical, sensory or mental capabilities, or lack of experience and knowledge, unless they have been given supervision or instruction concerning use of the appliance by a person responsible for their safety.

ATTENTION: Children should be supervised to ensure that they do not play with the appliance.

Table 1:

HEATER MODEL	POWER	SAUNA ROOM			MIN DISTANCES				SIZE OF WIRE		ARRANGEMENT
	kW	VOLUME m ³		HEIGHT cm	SIDE WALL cm	DISTANCE TO SHELF OVER 500mm ABOVE THE FLOOR	CEILING cm	FLOOR cm	380V ~ 415V THREE PHASES mm ²	220V ~ 240V SINGLE PHASE mm ²	STONES kg
AM30MI AM30DI	3.0	2	4	190	5	5	110	18		3×2.5	12
AM30M AM30D	3.0	2	4	190	5	5	110	18	5×1.5	3×2.5	14
AM45MI AM45DI	4.5	3	6	190	8	8	110	18	5×1.5	3×6	18
AM60MI AM60DI	6.0	5	9	190	10	15	110	18	5×1.5	3×10	18
AM80MI AM80DI	8.0	8	12	190	13	20	110	18	5×2.5	3×10	20
AM90MI AM90DI	9.0	9	13	190	13	20	110	18	5×2.5	3×10	20

HEATER INSTALLATION

Prior to installing heater, please refer to installation handbook and check it as following points:

- Attach the heater to the wall with a screw, according to chart 1 and table 1 or the size in heater.
- Is the output power and the type of the heater suitable for the SAUNA ROOM? see parameter table 1 (technical data).
- Is the supply voltage suitable for the rated voltage of the heater?
- The location of the heater fulfils the minimum requirements concerning the distances given in chart 1 and allow for safety and convenience (see table 2).
- Do not install the heater to the floor or wall recess.
- The required MIN height of SAUNA ROOM is 1900mm (chart 1C).

- Do not use asbestos-cement tile, asbestos-board and this kind of material as wall sheet behind the heater. For this material will cause the temperature of the wall to rise dangerously high.
- Choose the cable wire according to table 1 and the cable wire can bear high temperature 170°C (It is recommended to use rubber cable wire).

Do not install more than one heater in a sauna room unless twin-heater installation (NOTE: Leave 400mm between two heaters when installing two.)

The heater gets very hot when working .To avoid the risk accidental contact with the heater, it is recommended that a heater guard be provided. The guard is made into many kinds of patterns in accordance with the location place, yet some size must be made as the chart ID (see table 2 and chart 4).

The electrical supply must do the installation of the heater to ensure safety and reliability .Improper electrical connection can cause fire or electric shock.. Refer to the electrical connection chart.

The junction box in SAUNA ROOM must be sealed, splash-proof and have a moisture condensing vent with 7mm diameter , it is maximum height from the floor must not exceed 500mm (see chart 2).

NOTE: overheating safety equipment may become loose during shipment, check it (see chart2)

NOTE: The above screw must tighten, leave 3mm between screw head and the wall.

CHART 1A

CHART 1B

CHART 1C

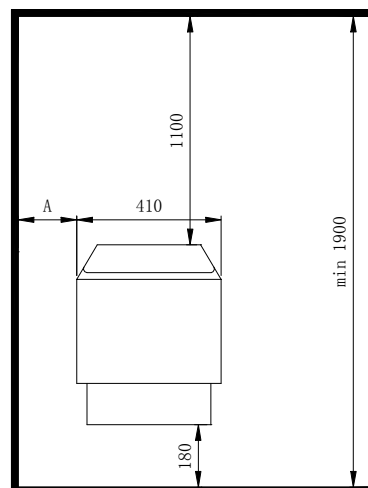
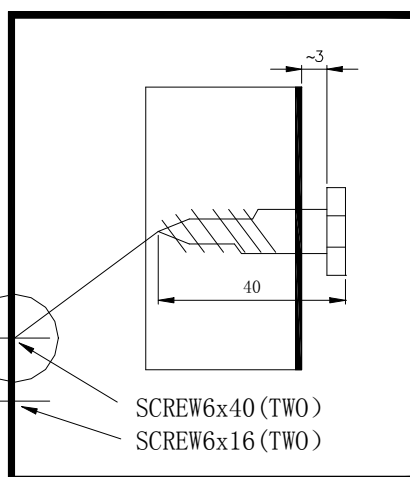
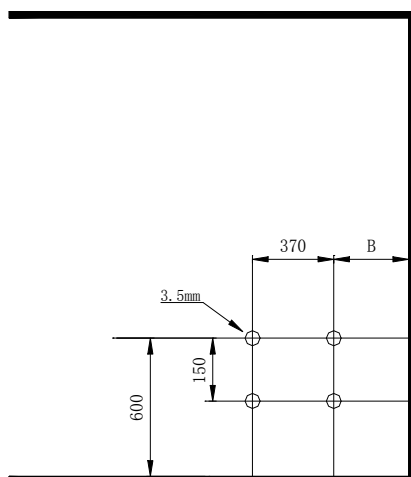
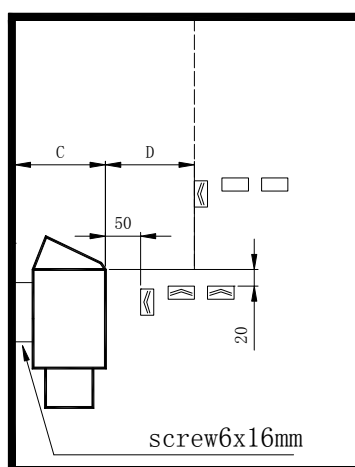

CHART 1D

TABLE 2

CHART 2



炉子	A (min)	B (min)	C (min)	D (min)
AM30M AM30D	50	70	280	100
AM30MI AM30DI	50	70	280	100
AM45MI AM45DI	80	100	280	100
AM60MI AM60DI	100	120	280	150
AM80MI AM80DI	130	150	290	200
AM90MI AM90DI	130	150	290	200

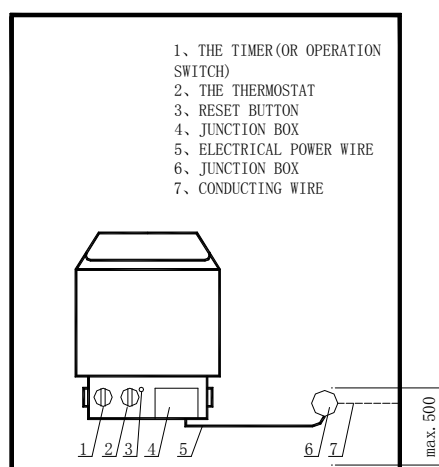

Transfer the control unit

The timer (or operation switch) and thermostat are located the front cover in heater ,if you want to transfer it to front cover (or left) side, which is done by professional electrician .(see chart 3).

- 1、 turn the heater over and dismount the bottom-edge of heater
- 2、 pull out the thermostat (2) and the timer's knob (3) (or operation switch) (1) ,
- 3 、 open the screws .
- 4、 Move the cover from the side.
- 5、 Transfer the thermostat (2) and the timer (operation switch 1) to the other side and tighten the screws .
- 6、 Fix the knob.
- 7、 Cover the front vent with the side of cover.
- 8、 Check connections of the thermostat and the timer (or operation switch) .
- 9、 Mount the bottom-edge .

CHART 3:

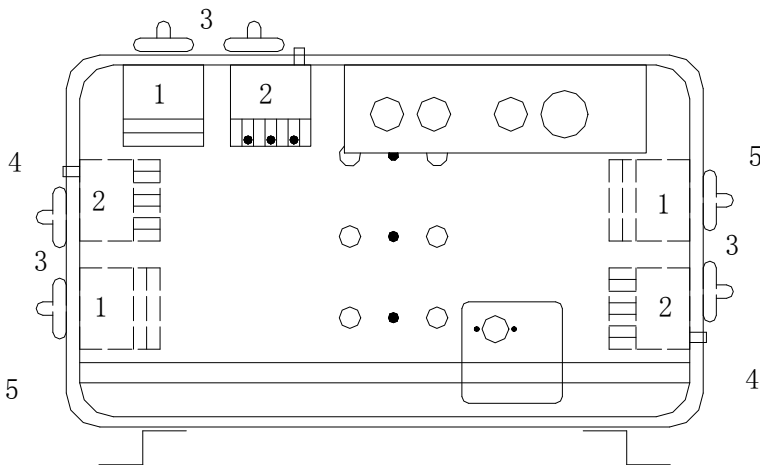
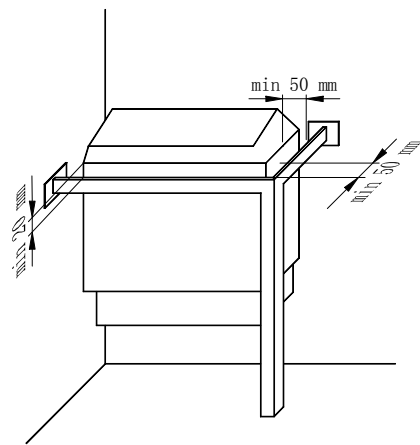

CHART 4:



The thermostat

The Thermostat control the temperature by turning operating knob. (Chart 2)

The heater should be equipped with proper size of sauna room. During 30-60 minutes, it reaches the selected temperature and remains (refer to table 1).

The timer <AM~M、 MI sauna series).<Refer to table 1 unit 1>

The timer is the main power switch in heater

The timer automatically cut off the power if it exceeds the setting time.

ATTENTION: Check sauna room before restart the timer.

The timer 8+4 hours preset

The timer has 1-8 hours presetting time and 1-4hours operating time. Turn the knob to anywhere between 1-4hours on the operating time scale if starting the heater at once

SAUNA STONE <prefer to chart 5>

Do not use the heater without stones, otherwise it may cause a fire , only use the original sauna stone .or the stone for use in heater. Do not use ordinary stone, that may emit harmful substance, easily break and do not possess good heating capacity. Wash the stones to clear the dust before putting them into the heater. Stones of unspecified sizes should not be used. Put the larger stones at the bottom of stove compartment and the smaller ones on the top, do not pile them tightly so that air can flow freely.

NOTE: too tightly placed stones decrease working time of the heater element. The stones should plainly cover the heater element. (Refer to chart 5). The diameter of stone is about 3-8 cm..

Rearrange the stones in the heater at least once a year or twice if it is in frequent use (maximum 500 hours). To decide the correct volume of stones in the heater, refer to technical data provided (table 1).

CHART 5: (PILING OF THE SAUNA STONES)

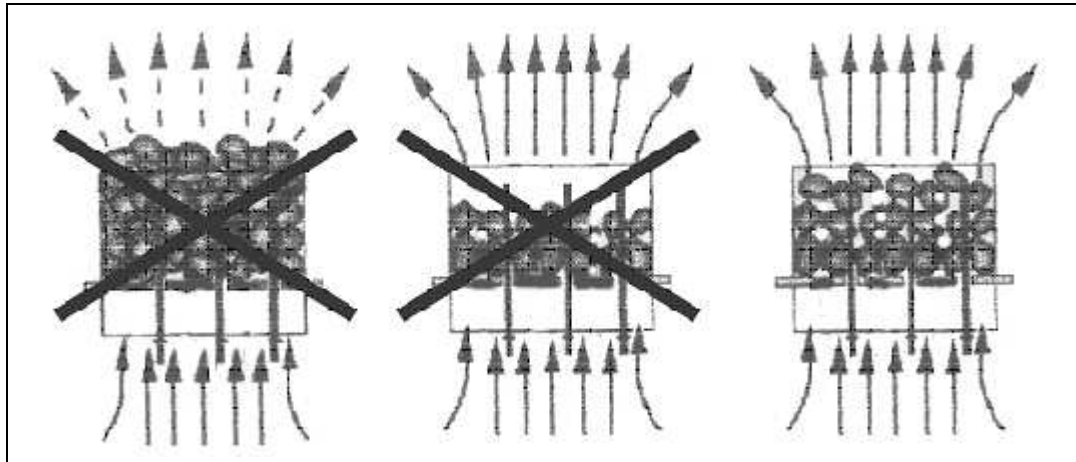

Air Ventilation of SAUNA ROOM

CHART 6: (LOCATION OF INLET AND OUTLET VENT)

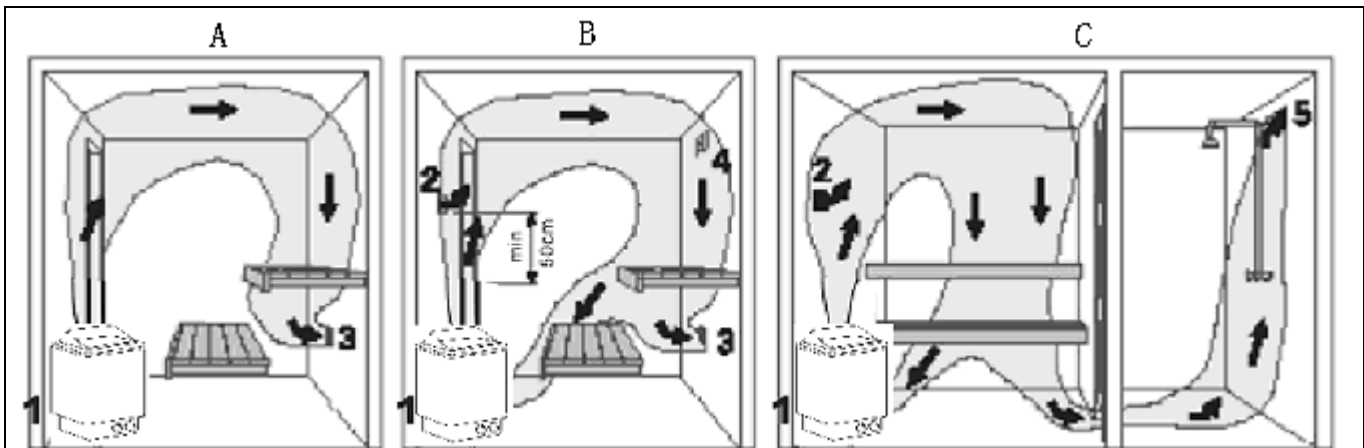

1. Air supply vent.
2. Optional air supply vent if mechanical exhaust ventilation is used, the opening is located 50cm above the heater.
3. Exhaust air vent.
4. Drying vent, which is closed during heating and bathing. Sauna room also dried by leaving the door open after bathing.

If there is only an exhaust vent in washing room, leave a MIN 5cm opening under the sauna room door. (Mechanical ventilation is recommended).

- To ventilate the Sauna room, the way is to draw air around the heater and move the heat to the farthest part of sauna room.
- Considering air ventilation of sauna room, the inlet vent and the outlet vent should be installed.

The inlet vent may be installed on the wall below the heater (chart 6a). When using the mechanical ventilation, inlet vent is placed at least 50cm above the heater (chart 6b) or on the ceiling above the heater (chart 6c). The heavy cold air that is blown into sauna room is mixed with the light hot air from the heater, bringing fresh air for the bathers. The inlet vent should have a diameter of 5-10 cm .

The outlet vent should be placed diagonally opposite to the inlet. It is advised the outlet vent is placed under the

platform in a sauna room as far as possible from the inlet vent. It can be installed near the floor, or lead outside through a pipe from the floor going to a vent to the sauna ceiling, or under the door (to the washroom).

In this case, the sill slot must be at least 5cm and it is recommended there is mechanical ventilation in the Wash Room . The size of the outlet should be twice of the inlet.

- Warning:
- 1、 do not power on when connecting electric current and mending .
 - 2、 do not hang clothes to dry in the heater, for this may cause a risk of fire.
 - 3、 do not bake food in heater .
 - 4、 Keep away from the heater when it is hot, the outer surface of the heater may burn your skin.

It is recommended that spruce wood in Northern Europe is used for material of wall and ceiling.

Insulation.

The door, ceiling and walls of sauna room must be insulated. When one square meter (m^2) of un-insulated surface choose the heater input <refer to table 1>.Take following as example (cubic volume increases to approximately $1.2m^3$)

Make sure that moisture-proof is appropriate in sauna room. Purpose of this is to prevent spreading moisture to the other rooms or wall structure. Moisture-proof must be placed between panel and heating insulation. Moisture and thermal proofing should be installed from outside to inside, such as:

- 1、 Recommend that the MIN thickness of the thermal insulation in the walls is 50mm and in the ceiling 100mm.
- 2、 Aluminum foil laminate is affixed over the heating insulation as a vapor barrier.
- 3、 Leave at least 20mm air slot between vapor barrier and inside panel.
- 4、 Leave a slot between wall panel and ceiling to prevent gathering moisture behind the panel.

Heating of the Heater

Ensure there is nothing near the heater before switching on it. The heater and the stones may emit smells when you use the heater for the first time. Make sure that the sauna room has been efficiently ventilated or open the sauna room door. It will take about an hour to reach suitable temperature in sauna room if the output of heater is proper.(CHART 6) ;

The temperature that bather preferred to is about $+60-+90^{\circ}C$. Too powerful heater will heat sauna room too quickly and the temperature of stones may remain insufficient. Consequently, the water thrown on the stones will run through and do not produce sufficient vapor. On the other hand, if the heater is underpowered the heating time will be much longer.

Malfunctions

If the heater doesn't work, check the following (Note: switch off the heater before checking >.

- | | | |
|-------------------|--|---------------------|
| 1、 front frame | 2、 stove side frame | 3、 heating element |
| 5、 terminal block | 5、 heating element holder with o-rings . | |
| 6、 cable holder | 7、 name plate | 8、 supply wire set. |

Warning:

- | | |
|--------------------------------|----------------------------------|
| Never put cover on the heater; | Do not use heater without stone; |
| Do not put wood on the heater; | Do not use chlorinated water. |

